

ADD/MODIFY ELEMENTS – Add Vertical Block

Modified on: Sat, 5 Dec, 2020 at 6:23 PM

Add/Modify Elements

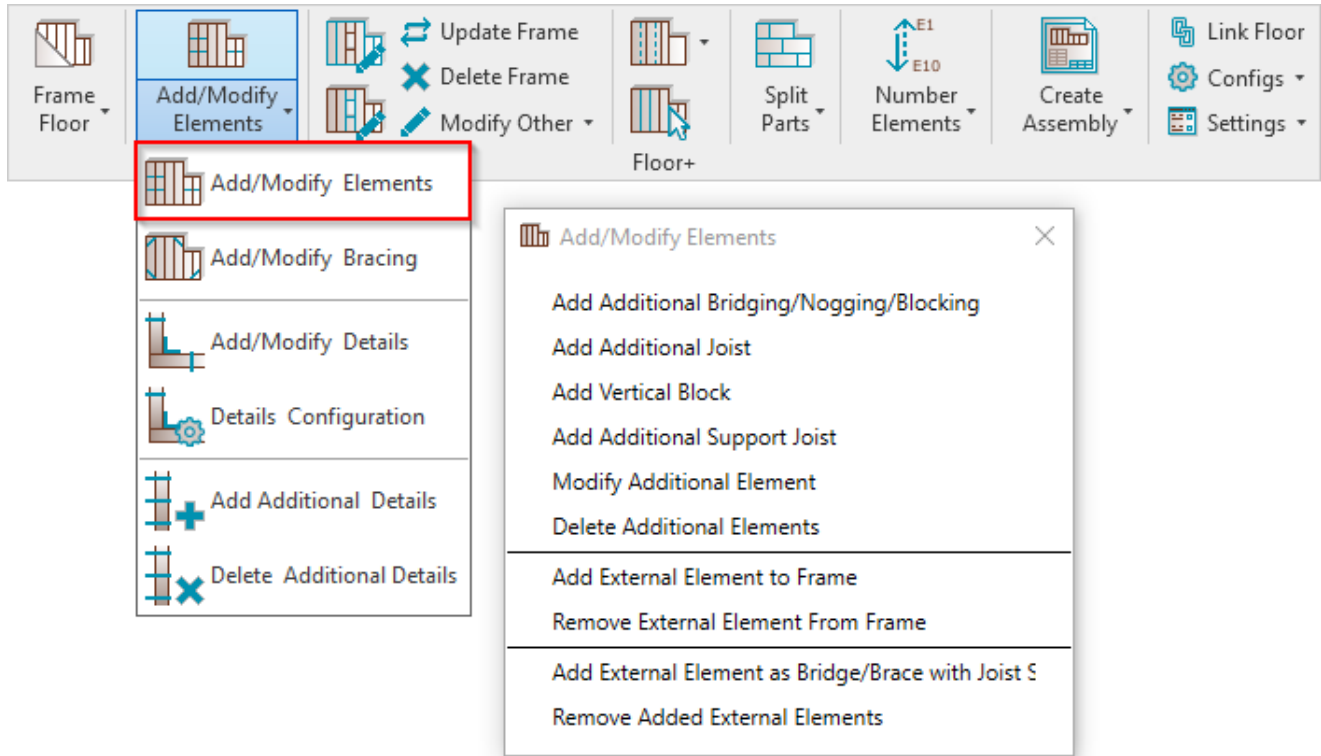

Add/Modify Elements – features for adding/modifying additional joists, support joists, bridging/nogging elements, etc.

Add Vertical Block

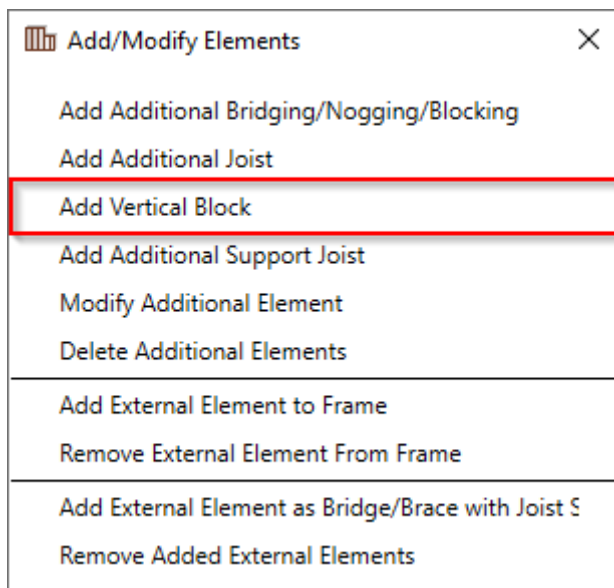

Add Vertical Block – adds additional block using joists into selected frame with predefined settings.

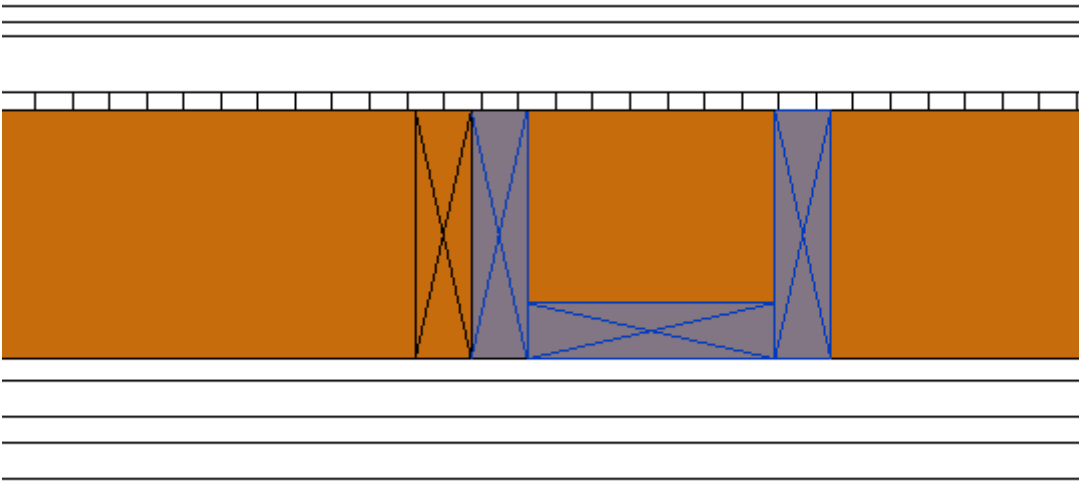

Distance Lock to

Floor+. Add Vertical Block

Additional Vertical Block

Insert Direction from Selected Joist: Left

Distance Lock to: Selected Joist

Distance/Spacing: Selected Joist

Custom Join: Start of Floor

Read Layout from Database: -- S

Configuration

Predefined Layout Name: *Default Configuration* Save to Database Duplicate Delete

New Item Remove Item Move Up Move Down

	X-Position	Count	Type	Depth by Core	Rotate 90	Rotate 180	Spacing	Position	Align Type	Extend Start
1	Standard	1	M_WF Joist : LMBR 45x150	<input checked="" type="checkbox"/>	<input type="checkbox"/>	<input type="checkbox"/>	0 mm	Center	-- None	None

Symbolic Preview

OK Close

Distance Lock to – an additional vertical block can be inserted with predefined distance from selected joist, floor start/end, or selected external element.

Distance/Spacing

Additional Vertical Block

Insert Direction from Selected Joist: Right

Distance Lock to: Selected Joist

Distance/Spacing: -400

Custom Join

Read Layout from Database: Default Configuration

Configuration

Predefined Layout Name: *Default Configuration*

	X-Position	Count	Type	Depth by Core	Rotate 90	Rotate 180	Spacing	Position
1	Standard	1	M_WF Joist : LMBR 45x150	<input checked="" type="checkbox"/>	<input type="checkbox"/>	<input type="checkbox"/>	0 mm	Center
2	Standard	1	M_WF Joist : LMBR 45x150	<input checked="" type="checkbox"/>	<input checked="" type="checkbox"/>	<input type="checkbox"/>	0 mm	Internal

Symbolic Preview

Distance/Spacing – distance/spacing from selected joist, start/end of floor, or selected external element to the block.

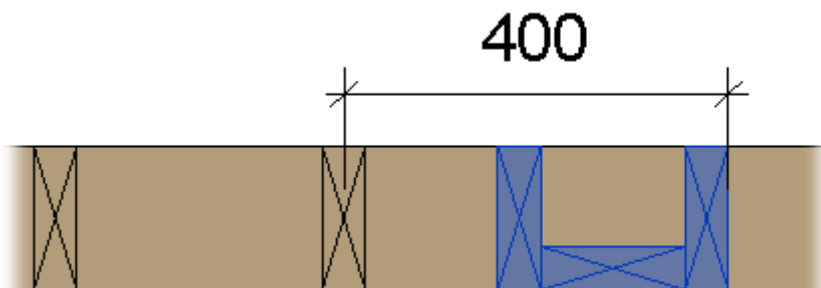

Custom Join

Additional Vertical Block

Insert Direction from Selected Joist:

Distance Lock to:

Distance/Spacing:

Custom Join

Read Layout from Database Configuration:

Configuration

Predefined Layout Name: *Default Configuration*

	X-Position	Count	Type	Define Depth...	Rotate 90°	Rotate 180°	Spacing
1	<input type="text" value="Standard"/>	<input type="text" value="1"/>	<input type="text" value="M_RWF Common Joist : LMBR 48x300"/>	<input checked="" type="checkbox"/>	<input type="checkbox"/>	<input type="checkbox"/>	0 mm

Symbolic Preview

The Symbolic Preview shows a grid with a red 'W' shape and a vertical orange block. The 'W' shape is composed of three horizontal bars and a vertical bar in the center. The vertical orange block is positioned to the right of the 'W' shape, with a dashed vertical line indicating its alignment.

Custom Join – is a multi-functional dialog where user can define rules for joins including size, count, position, rotation, spacing, alignment etc. All these rules can be saved and used in other framing configurations or shared with other users. This type of dialog is used frequently in our products, so here you can find [Custom Join detailed description >>](https://agacad.freshdesk.com/support/solutions/articles/44001990031-custom-join) (<https://agacad.freshdesk.com/support/solutions/articles/44001990031-custom-join>).