

FRAME ROOF – ADD SECONDARY FRAME, BATTENS, ROOFING

Modified on: Fri, 13 Sep, 2019 at 7:16 PM

Add Secondary Frame

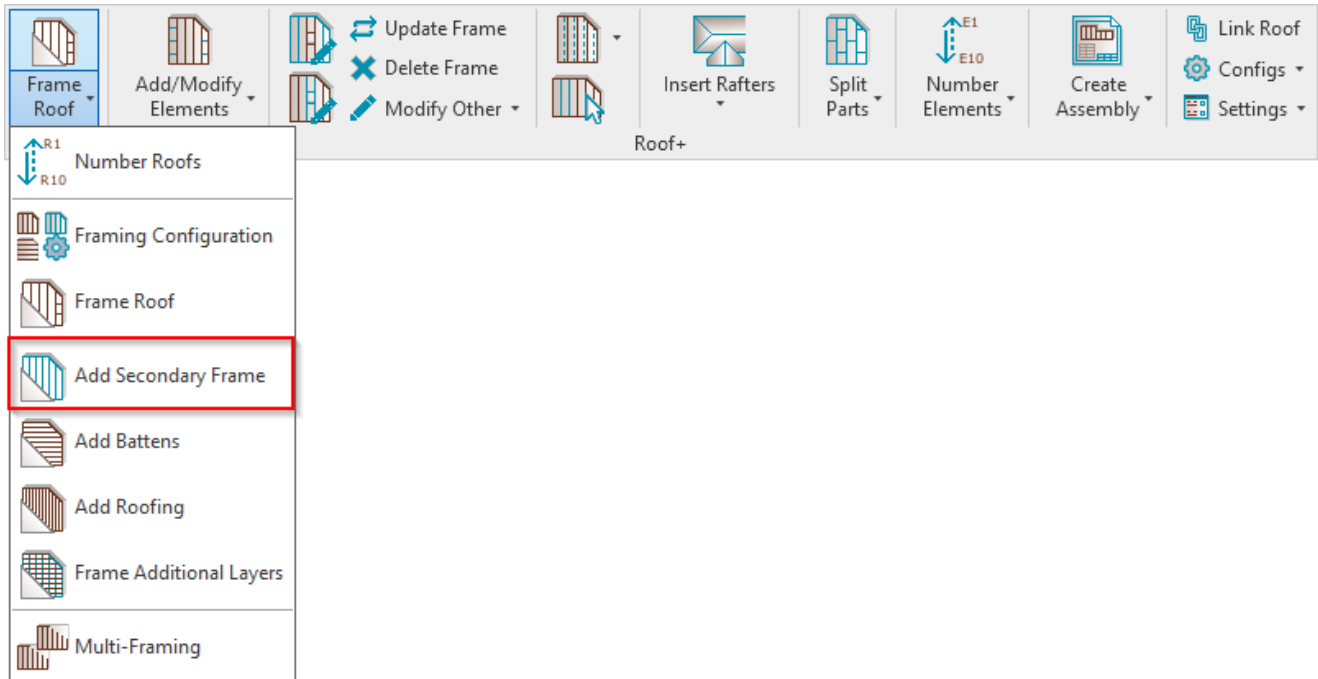

Add Secondary Frame – adds secondary frame to selected roofs.

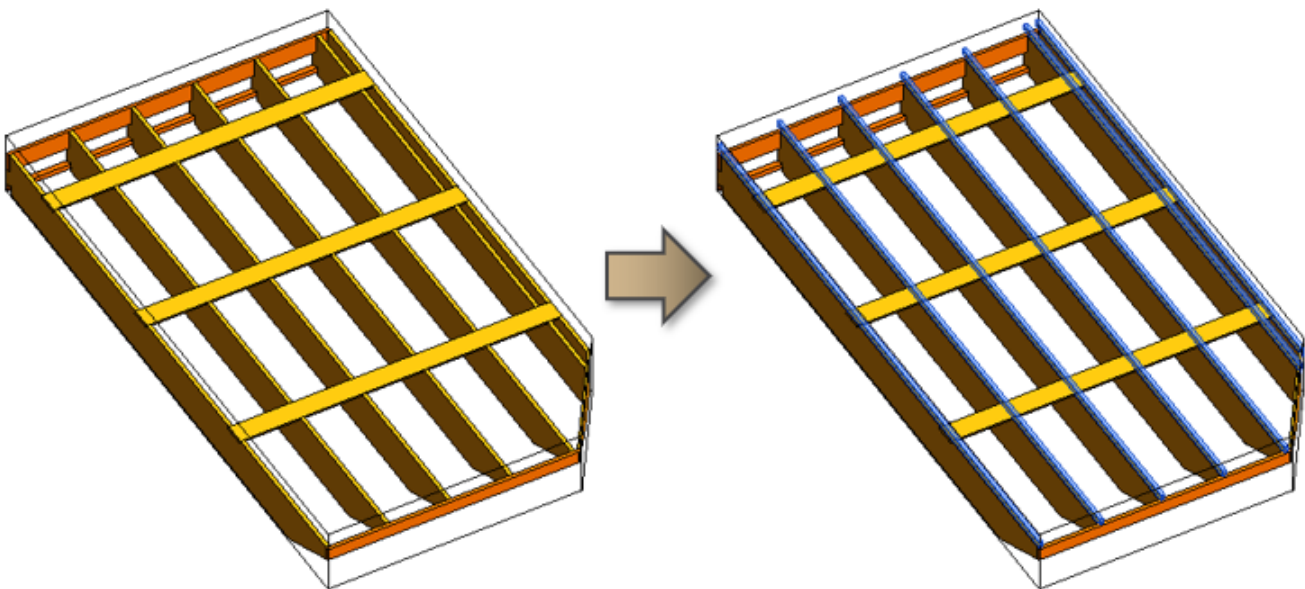

Add Battens

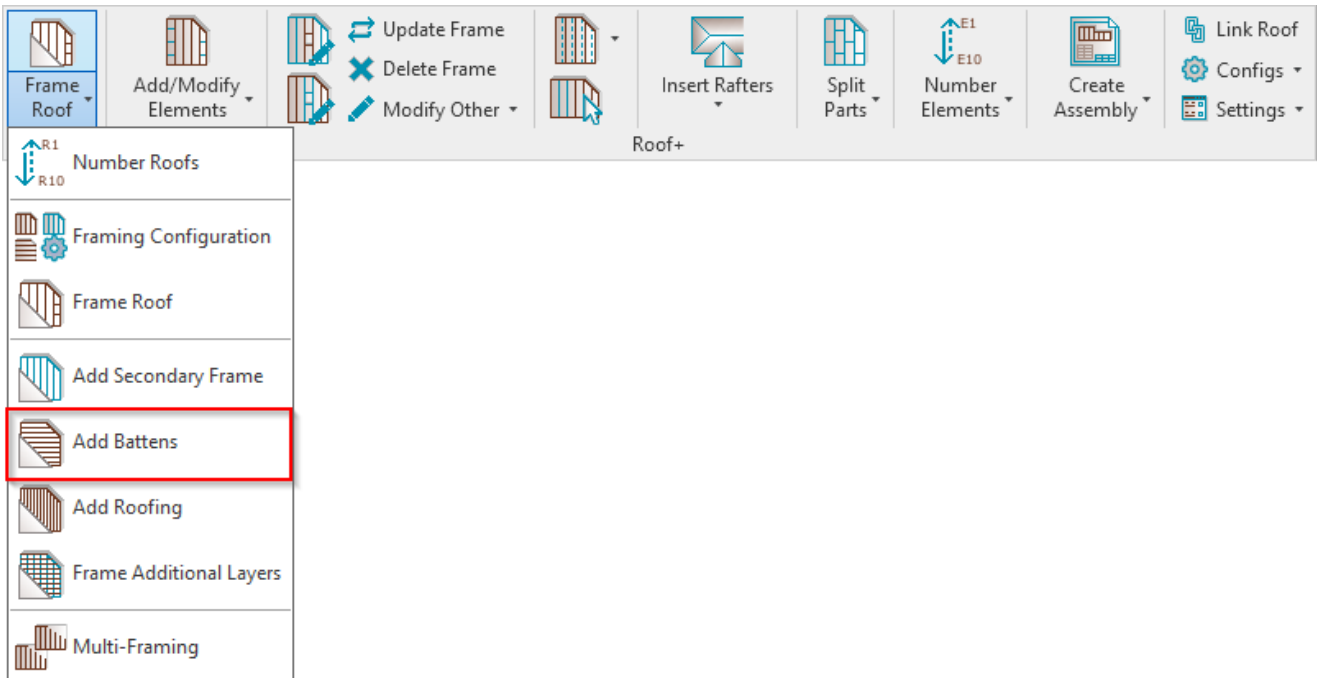

Add Battens – adds batten beams to selected roofs.

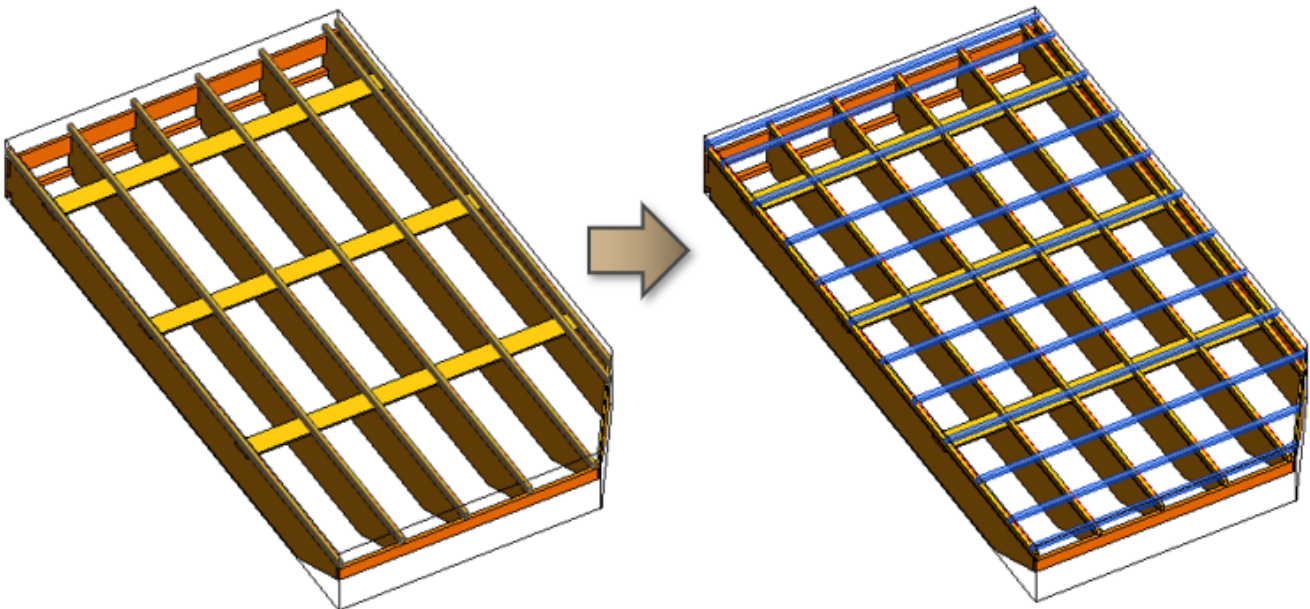

Add Roofing

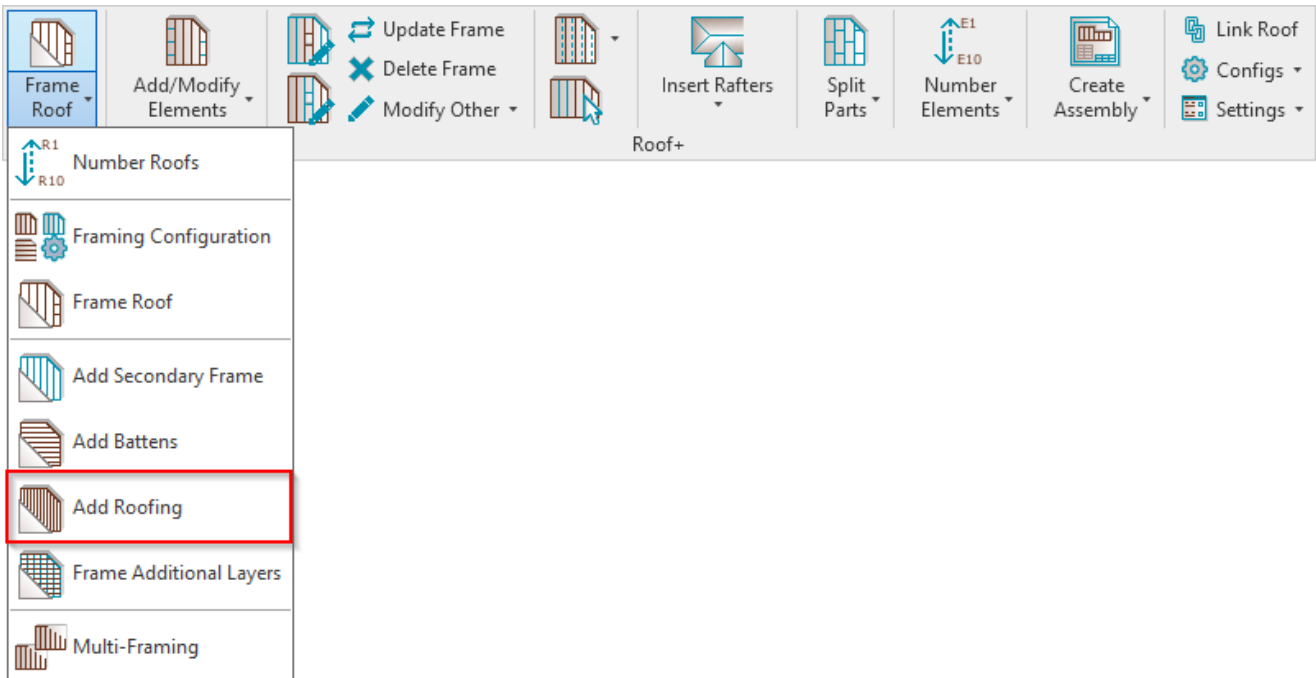

Add Roofing – adds vertical, horizontal, or mixed roofing to selected roofs.

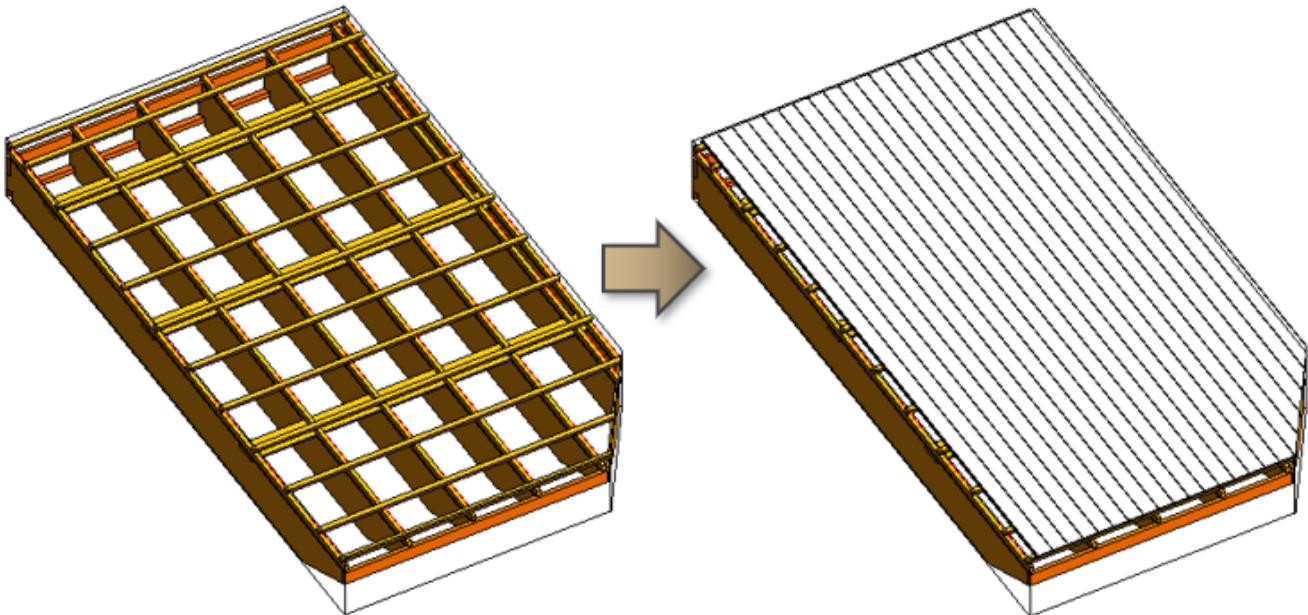

Frame Additional Layers

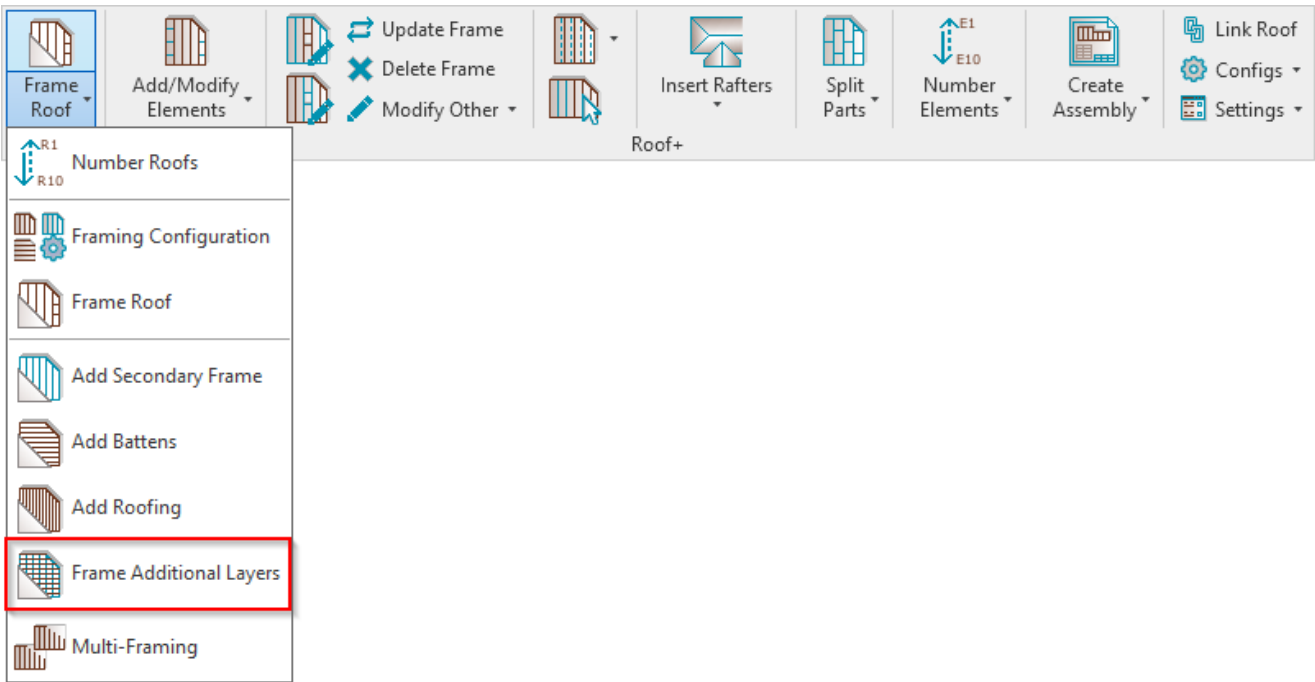

Frame Additional Layers – automatically frames all other layers (battens, roofing, secondary frame) excluding the Main Frame. (No need to click **Add Battens** or **Add Roofing** separately.)

The layers to be framed need to be selected in the **Frame** column in **Link Roof**:

