

# ADD/MODIFY ELEMENTS – Add Vertical Block

Modified on: Sun, 27 Sep, 2020 at 4:17 PM

## Add/Modify Elements

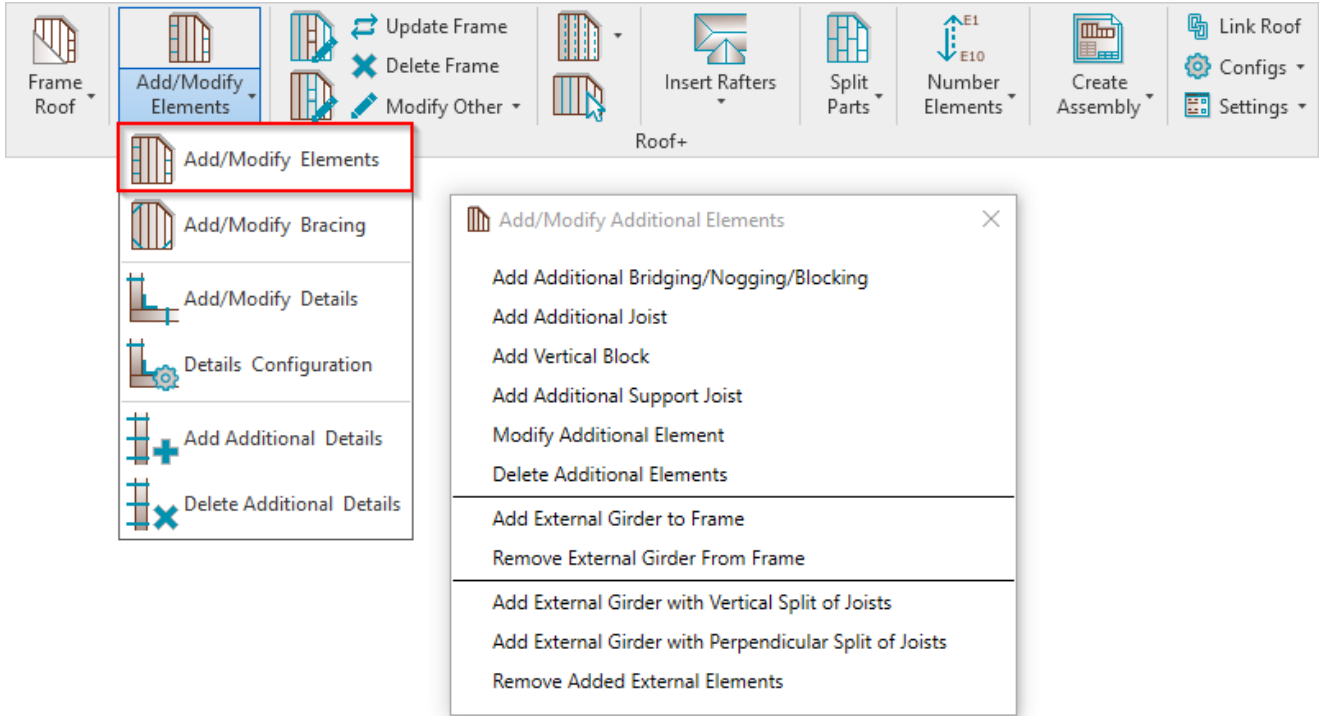

**Add/Modify Elements** – features for adding/modifying additional joists, support joists, bridging/nogging elements, etc.

## Add Vertical Block

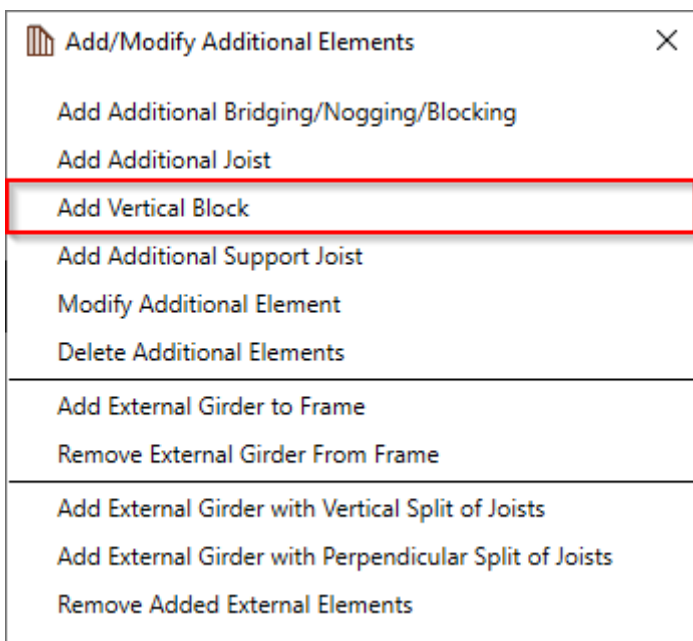

**Add Vertical Block** – adds additional block using joists into selected frame with predefined settings.

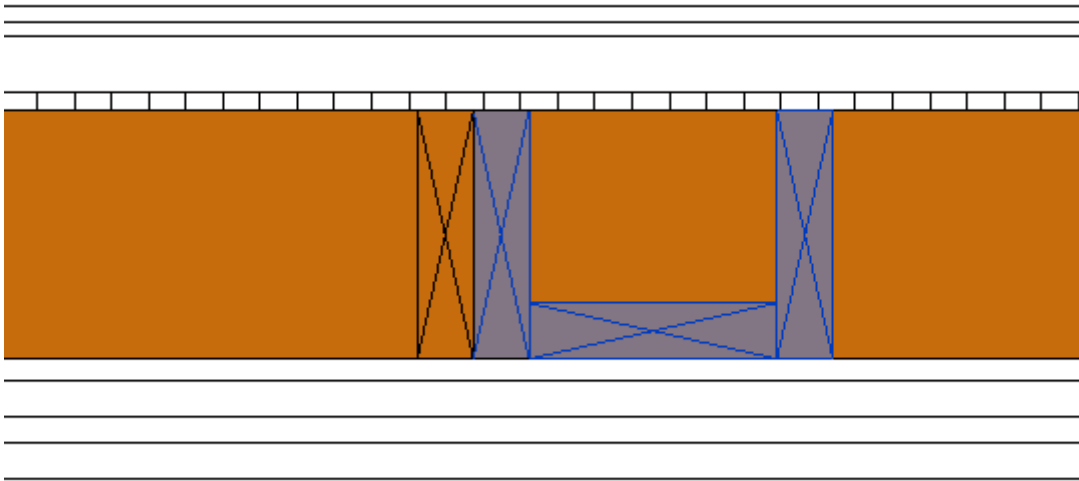

### Insert Direction from Selected Joist

Additional Vertical Block

**Insert Direction from Selected Joist** Left

Distance Lock to Left

Distance/Spacing Right

0

Custom Join

Read Layout from Database Configuration: -- Select --

Configuration

Predefined Layout Name: *Default Configuration* **Save to Database** **Duplicate** **Delete**

**New Item** **Remove Item** **Move Up** **Move Down**

	X-Position	Count	Type	Define Depth...	Rotate 90°	Rotate 180°	Spacing
1	Standard	1	M_RWF Common Joist : LMBR 48x300	<input checked="" type="checkbox"/>	<input type="checkbox"/>	<input type="checkbox"/>	0 mm

Symbolic Preview

A symbolic preview of a joist element on a grid. The grid is light gray with a vertical dashed line. A red 'W' symbol is positioned on the left side of the grid. A vertical brown bar representing the joist is positioned on the right side of the grid, aligned with the vertical dashed line. A red horizontal line is positioned below the grid.

**Insert Direction from Selected Joist** – choose left of right side where the block will be inserted.

## Distance Lock to

Roof+. Add Vertical Block

Additional Vertical Block

Insert Direction from Selected Joist: Left

**Distance Lock to**: Selected Joist

Distance/Spacing: 0' - 0"

Custom Join

Read Layout from Database: Default Configuration

Configuration

Predefined Layout Name: Default Configuration

	X-Position	Count	Type	Depth by Core	Rotate 90	Rotate 180	Spacing
1	Standard	1	I_Roof_Frame Common Joist : LMBR 2x12	<input checked="" type="checkbox"/>	<input type="checkbox"/>	<input type="checkbox"/>	0' 0"
2	Standard	1	I_Roof_Frame Common Joist : LMBR 2x12	<input checked="" type="checkbox"/>	<input checked="" type="checkbox"/>	<input type="checkbox"/>	0' 0"

Symbolic Preview

OK

**Distance Lock to** – an additional vertical block can be inserted with predefined distance from selected joist, roof start/end, or selected external element.

## Distance/Spacing

**Additional Vertical Block**

Insert Direction from Selected Joist:

Distance Lock to:

**Distance/Spacing**:

Custom Join

Read Layout from Database:

Configuration

Predefined Layout Name: *Default Configuration*

	X-Position	Count	Type	Depth by Core	Rotate 90	Rotate 180	Spacing	Position
1	Standard	1	M_WF Joist : LMBR 45x150	<input checked="" type="checkbox"/>	<input type="checkbox"/>	<input type="checkbox"/>	0 mm	Center
2	Standard	1	M_WF Joist : LMBR 45x150	<input checked="" type="checkbox"/>	<input checked="" type="checkbox"/>	<input type="checkbox"/>	0 mm	Internal

Symbolic Preview

**Distance/Spacing** – distance/spacing from selected joist, start/end of roof, or selected external element to the block.

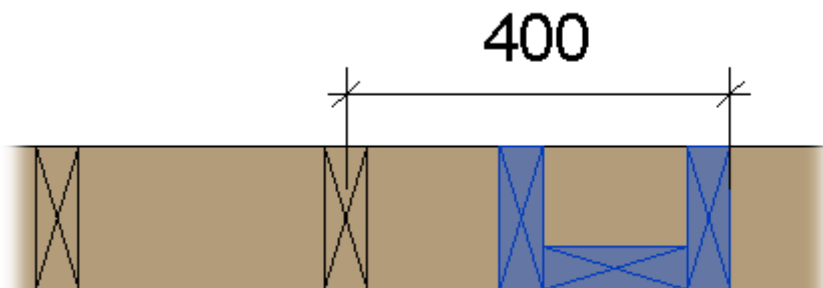

## Custom Join

Additional Vertical Block

Insert Direction from Selected Joist:

Distance Lock to:

Distance/Spacing:

**Custom Join**

Read Layout from Database Configuration:

Configuration

Predefined Layout Name: *Default Configuration*

	X-Position	Count	Type	Define Depth...	Rotate 90°	Rotate 180°	Spacing
1	<input type="text" value="Standard"/>	<input type="text" value="1"/>	<input type="text" value="M_RWF Common Joist : LMBR 48x300"/>	<input checked="" type="checkbox"/>	<input type="checkbox"/>	<input type="checkbox"/>	0 mm

Symbolic Preview

The Symbolic Preview shows a grid with a red 'W' shape and a vertical orange block. The 'W' shape is composed of three horizontal bars and a central vertical bar. The vertical orange block is positioned to the right of the 'W' shape, with a dashed vertical line indicating its alignment.

**Custom Join** – is a multi-functional dialog where user can define rules for joins including size, count, position, rotation, spacing, alignment etc. All these rules can be saved and used in other framing configurations or shared with other users. This type of dialog is used frequently in our products, so here you can find [Custom Join detailed description >>](https://agacad.freshdesk.com/support/solutions/articles/44001990031-custom-join) (<https://agacad.freshdesk.com/support/solutions/articles/44001990031-custom-join>).