

ADD/MODIFY DETAILS

Modified on: Fri, 6 Sep, 2019 at 7:35 PM

Add/Modify Details

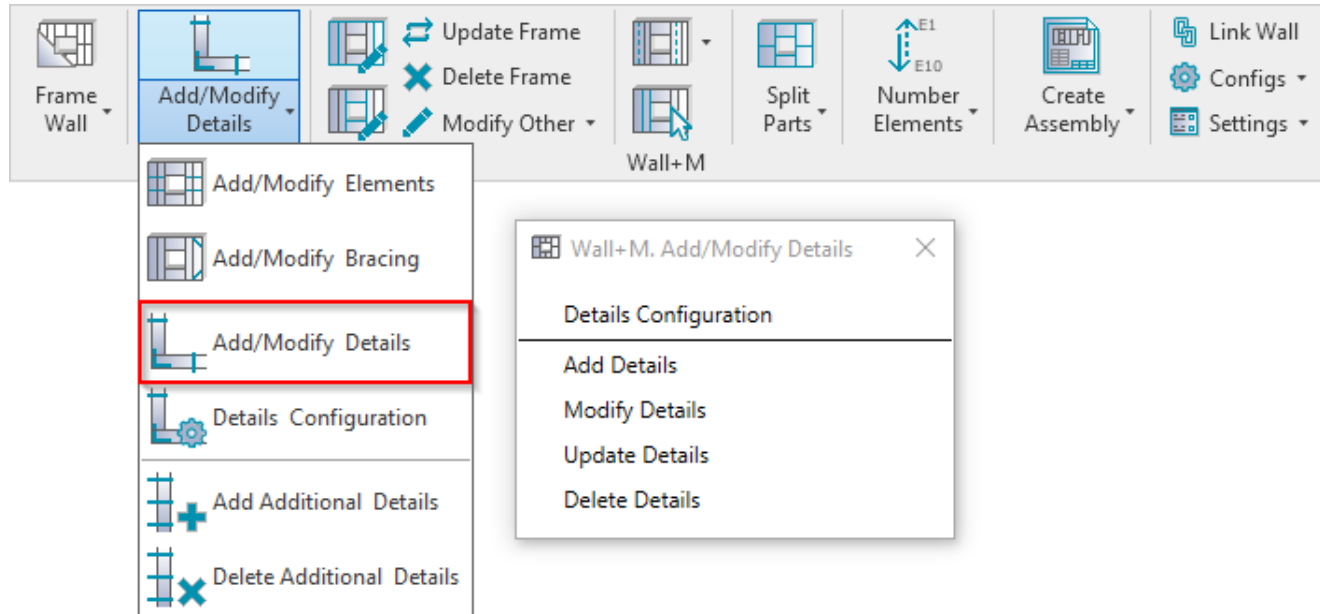

Add/Modify Details – for placing details in the frame. It is recommended to use these functions at the end of the framing process.

Recommended workflow: Create frame without details → Add additional elements → Split elements if needed → In the final step, add details. This will allow you to save time during the updating process when you frame a wall.

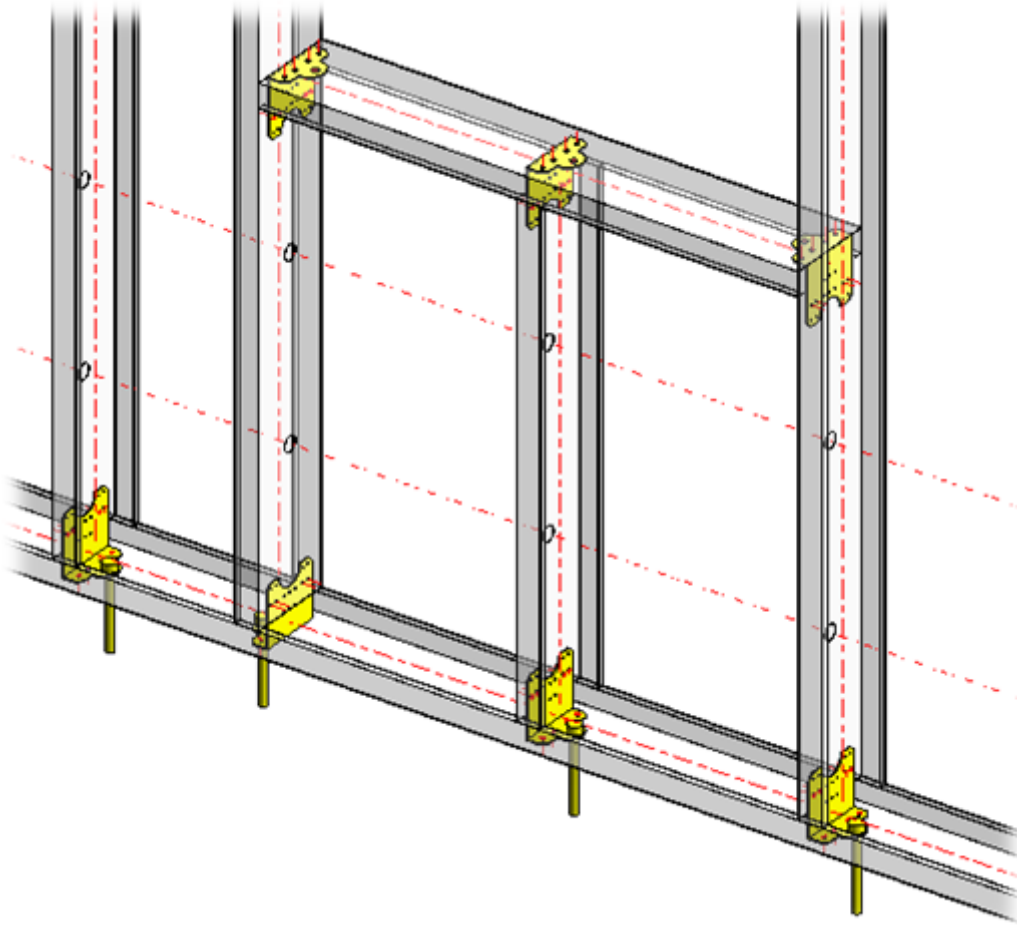

Details Configuration

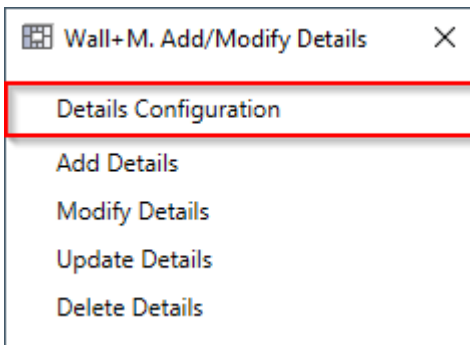

Details Configuration – definition of all detail placing parameters.

Read more >> (<https://agacad.freshdesk.com/support/solutions/articles/44001794026-add-modify-details-%E2%80%93-details-configuration>).

Add Details

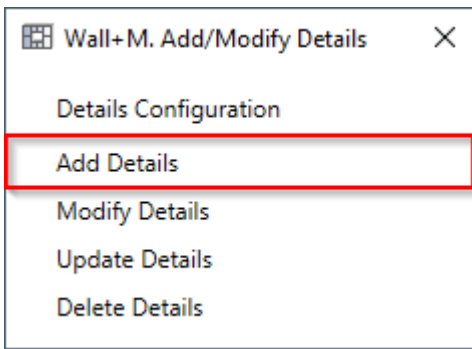

Add Details – adds details into selected walls according to predefined configuration. Recommended to use this function at the end of the framing process.

Recommended workflow: Create frame without details → Add additional elements → Split elements if needed → In the final step, add details. This will save time during the updating process when you frame a wall.

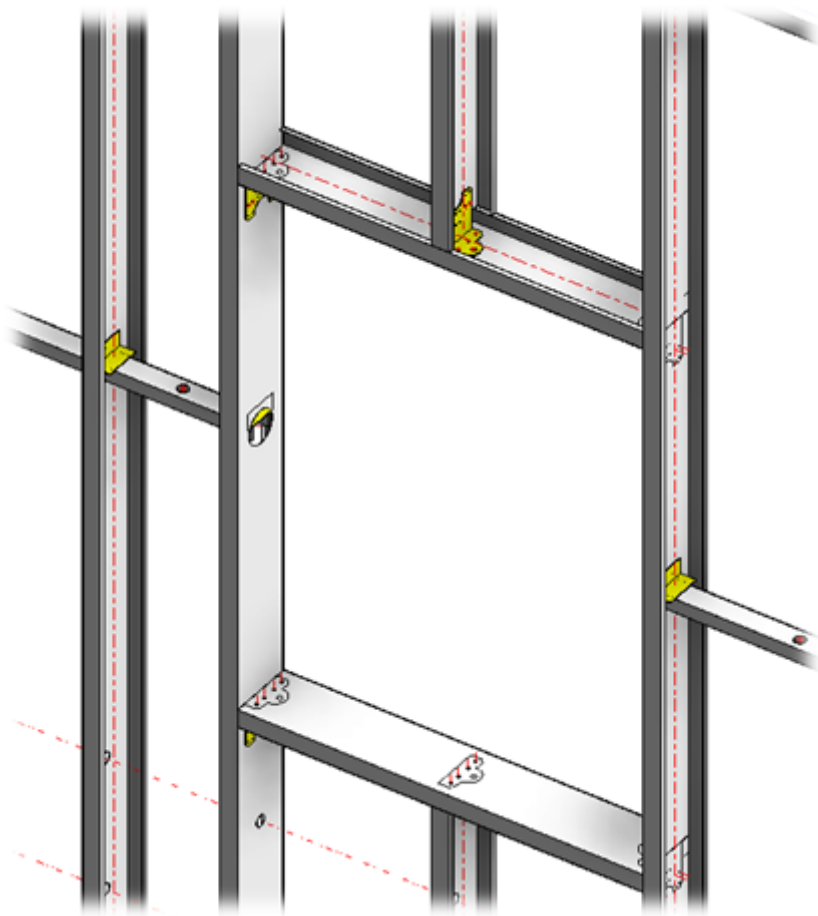

Modify Details

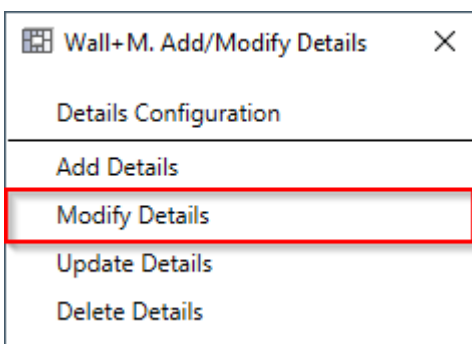

Modify Details – modifies selected wall details with custom settings if you need to make unique changes. All configuration settings are the same as in **Details Configuration**.

Update Details

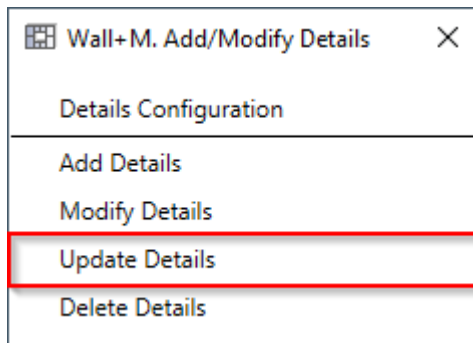

Update Details – updates details if any changes were made to wall, e.g. window was moved, wall was extended, etc.

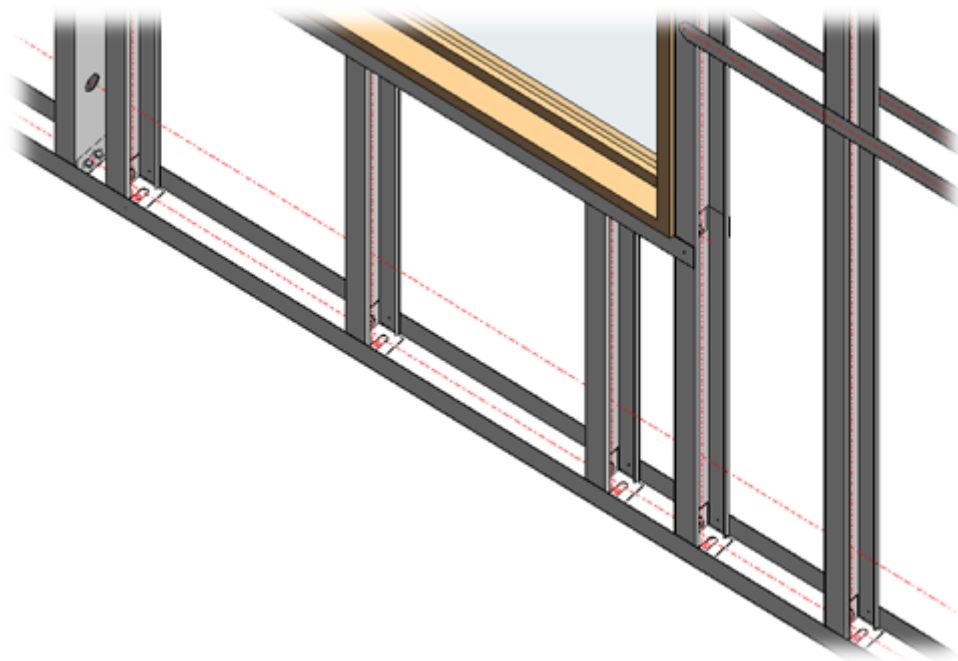

Delete Details

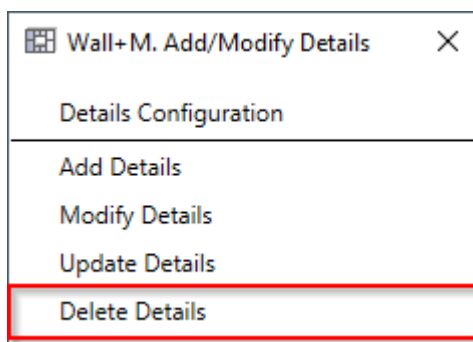

Delete Details – deletes details from selected frame.

