

## ADD/MODIFY ELEMENTS – Add Vertical Block

Modified on: Sat, 9 Jan, 2021 at 11:39 AM

### Add/Modify Elements

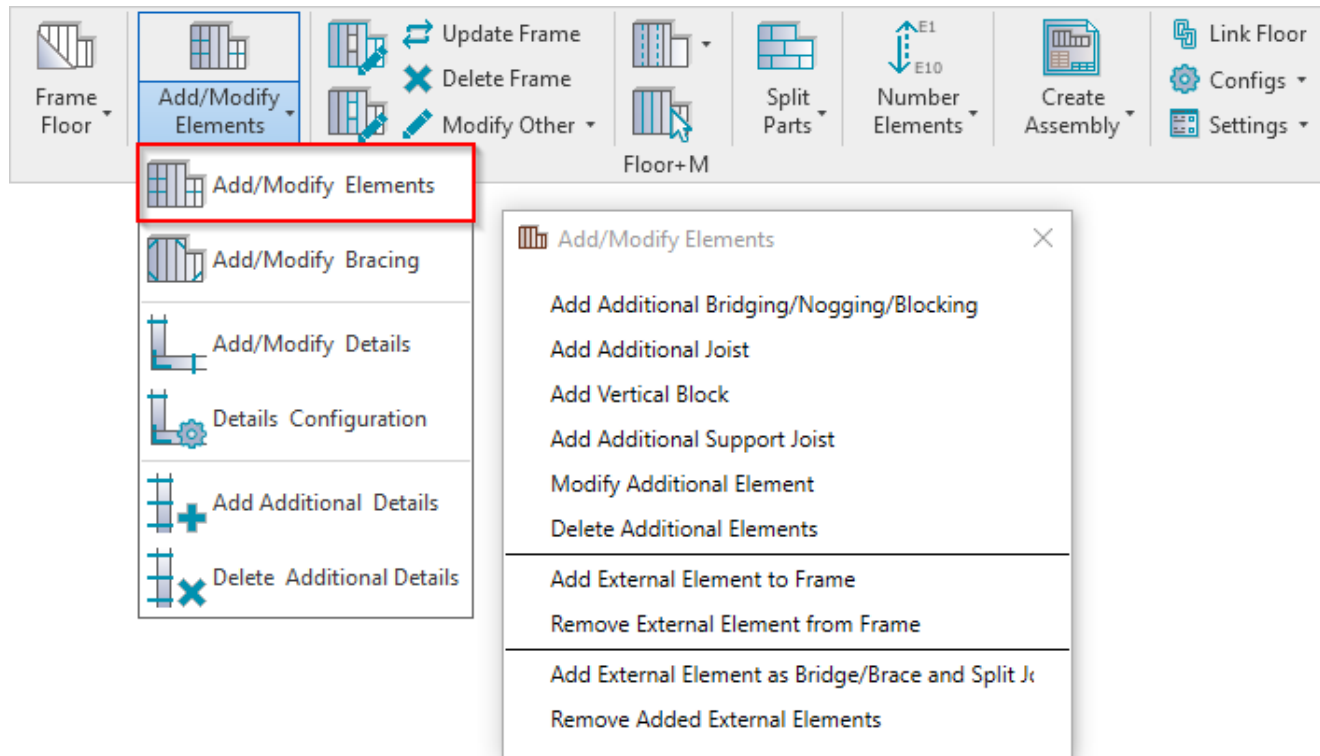

**Add/Modify Elements** – features for adding/modifying additional joists, support joists, bridging/noggin elements, etc.

### Add Vertical Block

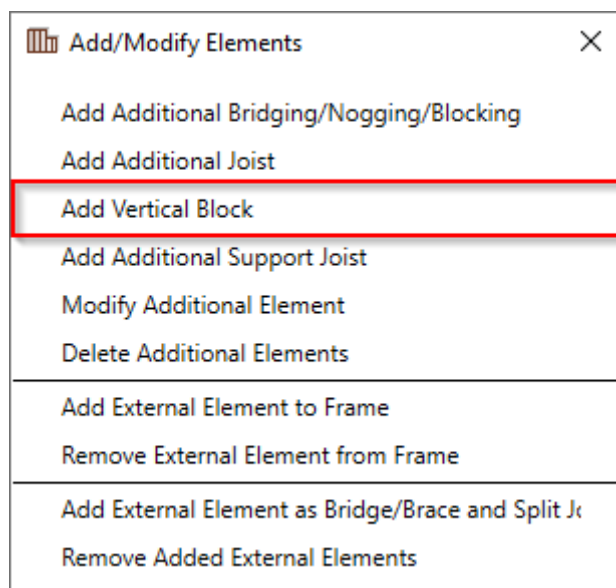

**Add Vertical Block** – adds additional block using joists into selected frame with predefined settings.

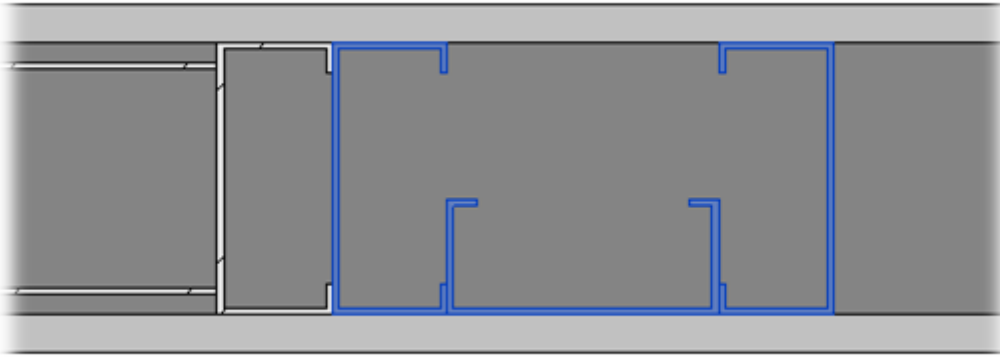

## Distance Lock to

Additional Vertical Block

Insert Direction from Selected Joist: Left

**Distance Lock to**: Selected Joist

Distance/Spacing: Selected Joist

Custom Join: Selected Joist

Configuration: Start of Floor

Predefined Layout Name: Default

Select Layout from Database Configuration: -- Select --

New Item Remove Item Move Up Move Down

	X-Position	Count	Type	Define Depth...	Rotate 90°	Rotate 180°	Flip Facing	Spacing
1	Standard	1	M_MF C+C Stud : C20376-15	<input checked="" type="checkbox"/>	<input type="checkbox"/>	<input type="checkbox"/>	<input type="checkbox"/>	0 mm

Symbolic Preview

**Distance Lock to** – an additional vertical block can be inserted with predefined distance from selected joist, floor start/end, or selected external element.

## Distance/Spacing

Additional Vertical Block

Insert Direction from Selected Joist	Left
Distance Lock to	Selected Joist
Distance/Spacing	-400

**Distance/Spacing** – distance/spacing from selected joist, start/end of floor, or selected external element to the block.

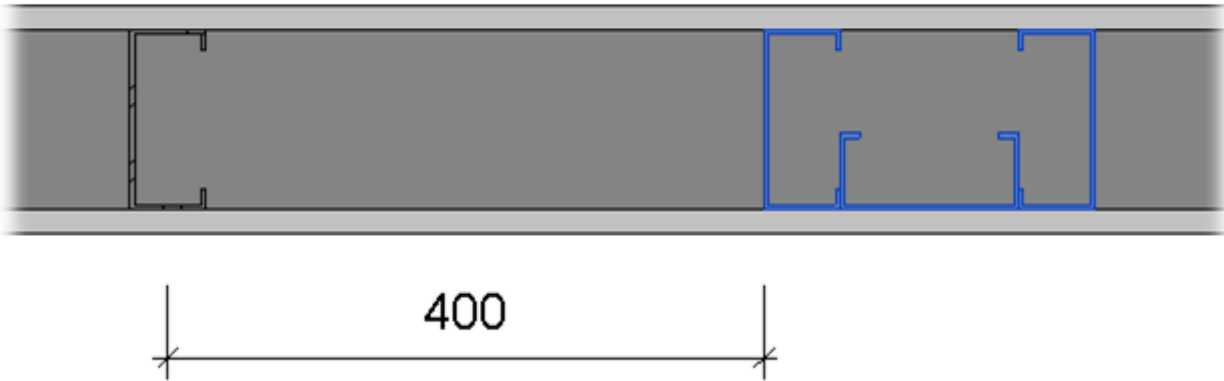

## Custom Join

Additional Vertical Block

Insert Direction from Selected Joist: Left

Distance Lock to: Selected Joist

Distance/Spacing: -400

Custom Join

Configuration

Predefined Layout Name: *Default Configuration* Save to Database Duplicate Rename Delete

Select Layout from Database Configuration: -- Select --

New Item Remove Item Move Up Move Down

	X-Position	Count	Type	Define Depth...	Rotate 90°	Rotate 180°	Flip Facing	Spacing
1	Standard	1	M_MF C+C Stud : C20376-15	<input checked="" type="checkbox"/>	<input type="checkbox"/>	<input type="checkbox"/>	<input type="checkbox"/>	0 mm

Symbolic Preview

The Symbolic Preview area shows a grid with a vertical dashed line. On the left side of the grid, there is a red 'W' symbol. On the right side, there is a vertical stud symbol. A horizontal line is drawn across the grid, and a red horizontal bar is visible below it.

**Custom Join** – is a multi-functional dialog where user can define rules for joins including size, count, position, rotation, spacing, alignment etc. All these rules can be saved and used in other framing configurations or shared with other users. This type of dialog is used frequently in our products, so here you can find [Custom Join detailed description >>](https://agacad.freshdesk.com/support/solutions/articles/44001990031-custom-join) (<https://agacad.freshdesk.com/support/solutions/articles/44001990031-custom-join>).