

MULTI-FRAMING

Modified on: Tue, 17 Sep, 2019 at 7:51 PM

Multi-Framing

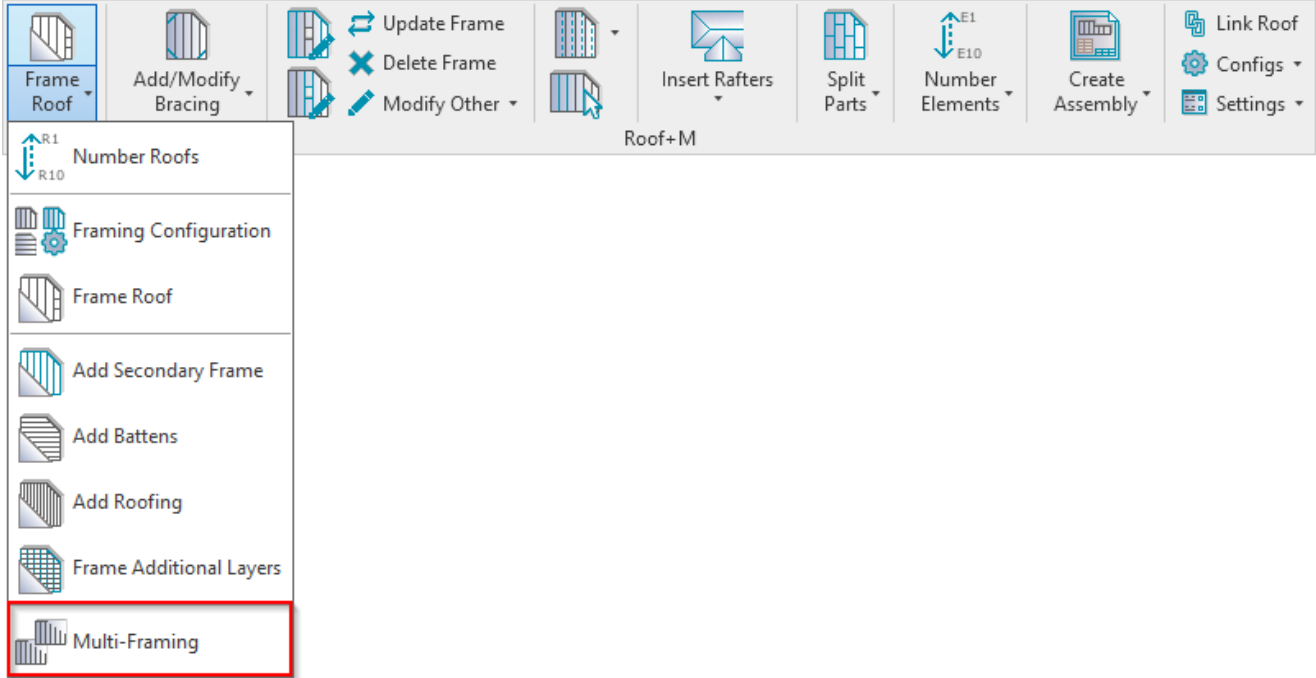

Multi-Framing features work extremely well in big projects, like multi-storey houses.

An additional window opens that contains tools for multi-framing tasks. Multi-Framing is used when there are groups or identical roofs in a given project. Using Multi-Framing tools you can easily transfer framing elements between identical roofs and update them automatically.

Filtering Rules in Model Groups

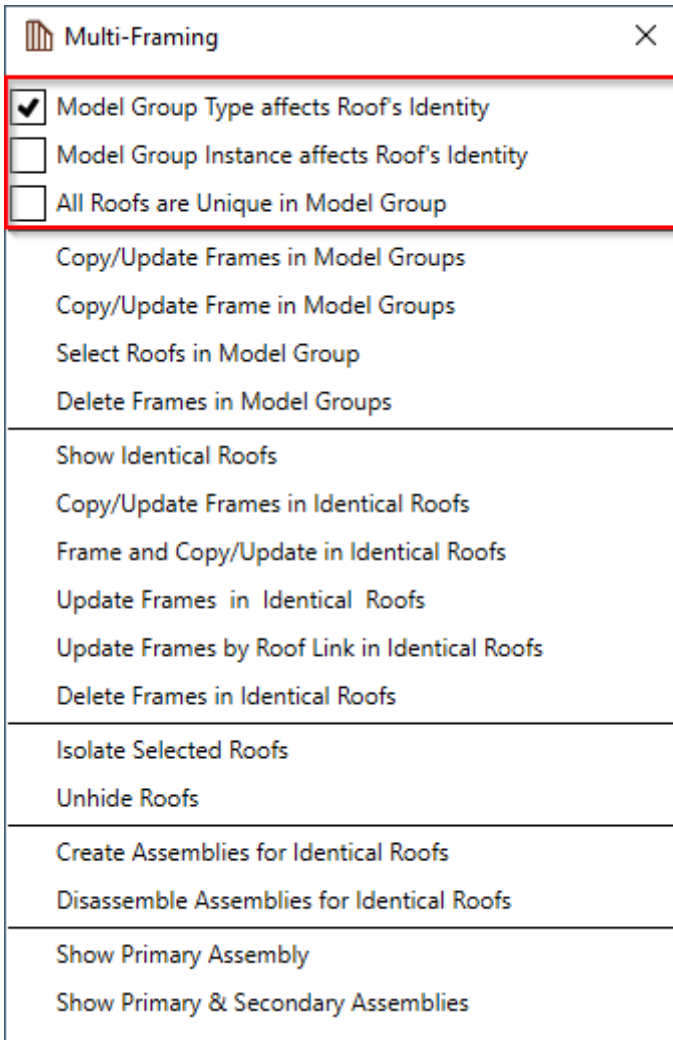

Filtering rules for work with roofs from model groups. **Model Groups** should be created using Revit's **Create Group** function.

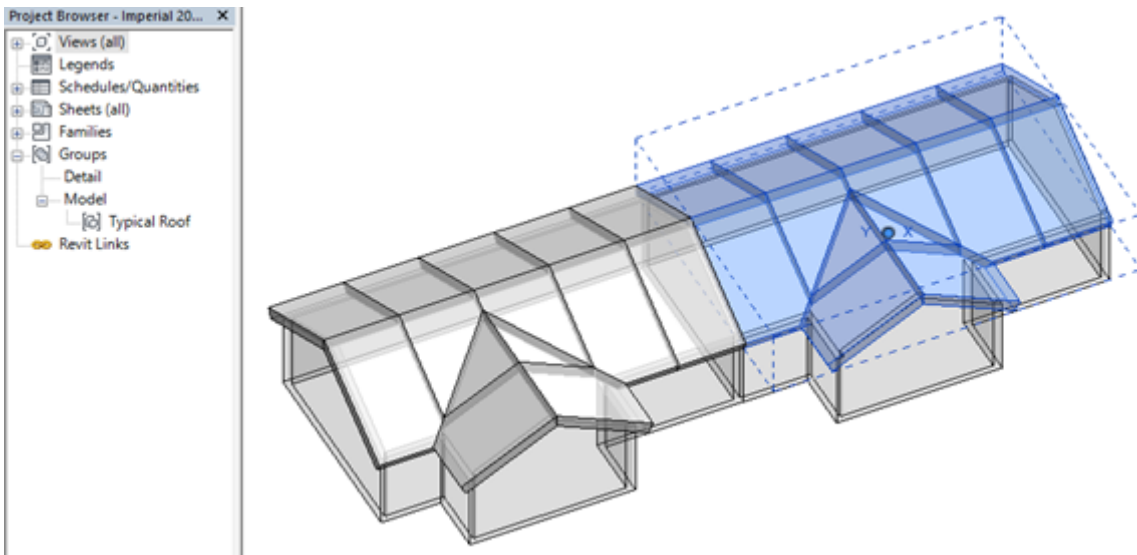

Model Group Type affects Roof's Identity

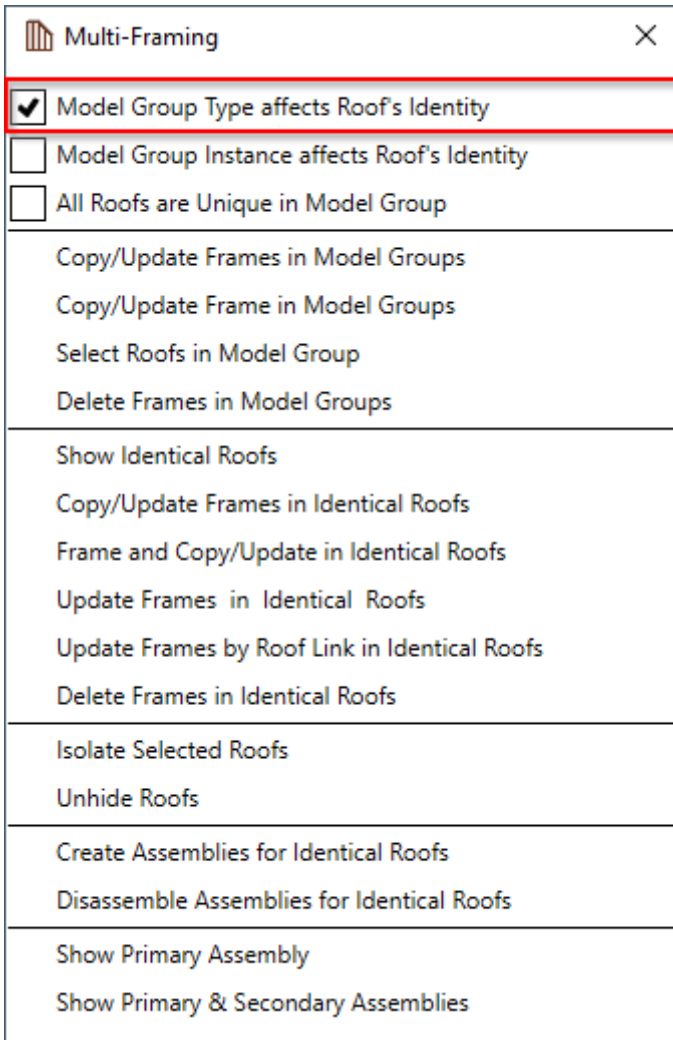

Model Group Type affects Roof's Identity – sets filtering rules if roof's identity is affected by Model Group type. If ticked, only identical roofs of the same Model Group type will be treated as the same roof.

Example: Identical roofs are selected from the same model group type.

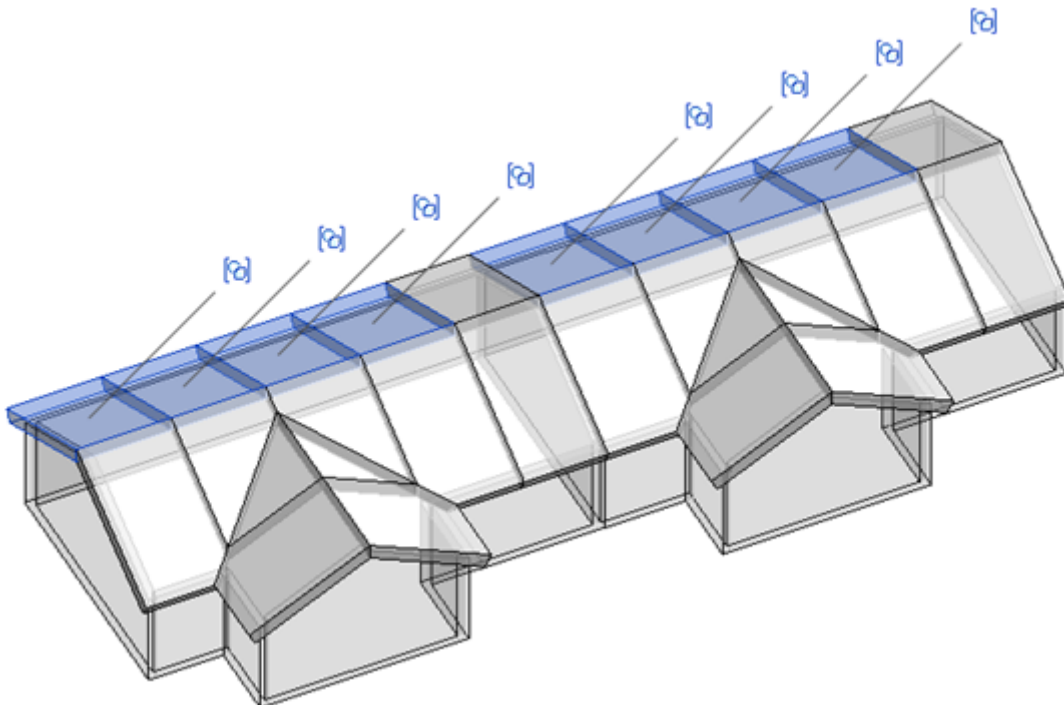

Model Group Instance affects Roof's Identity

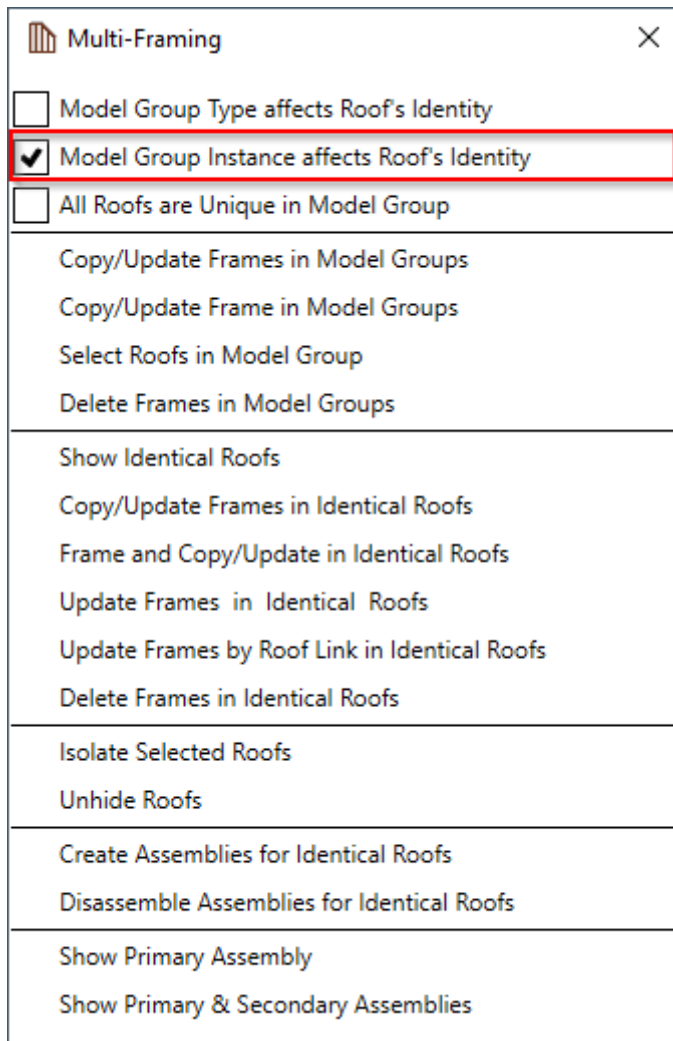

Model Group Instance affects Roof's Identity – sets filtering rules if roof's identity is affected by Model Group instance (only selected Model Group).

Example: Identical roofs are selected from the selected model group instance.

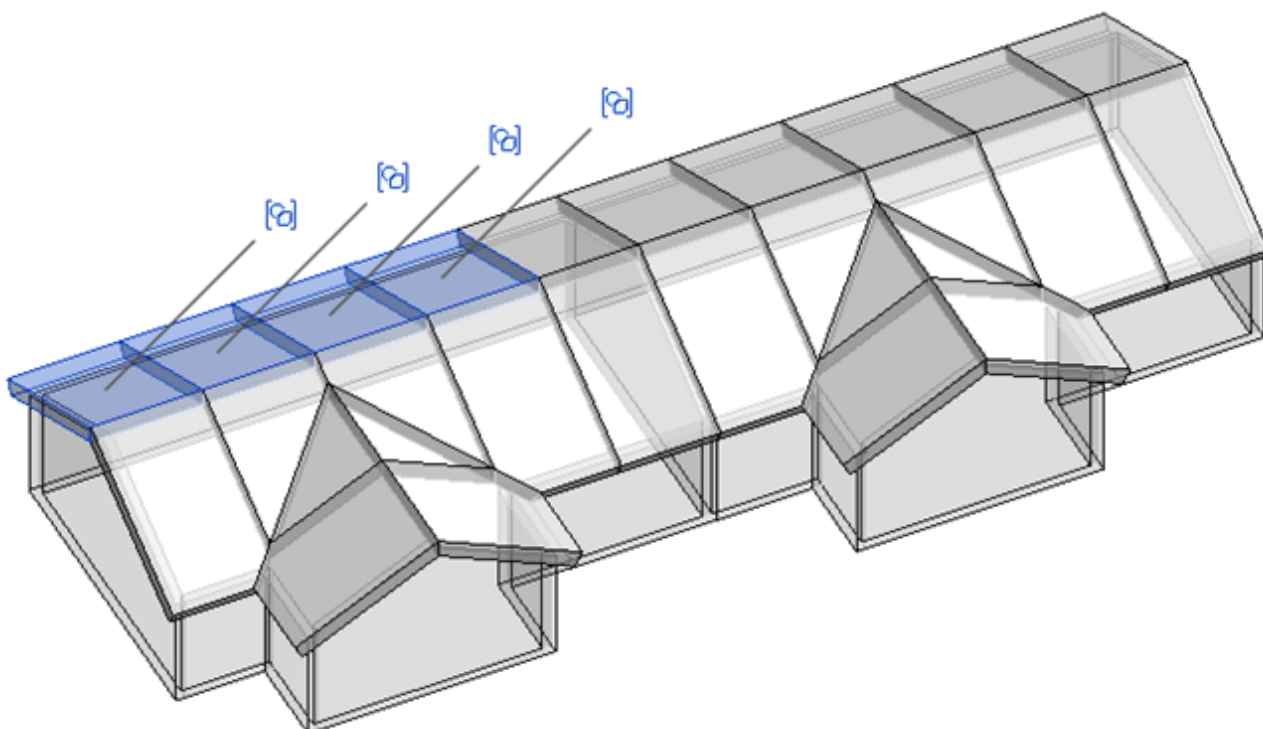

All Roofs are Unique in Model Group

Multi-Framing ×	
<input type="checkbox"/>	Model Group Type affects Roof's Identity
<input type="checkbox"/>	Model Group Instance affects Roof's Identity
<input checked="" type="checkbox"/>	All Roofs are Unique in Model Group
Copy/Update Frames in Model Groups	
Copy/Update Frame in Model Groups	
Select Roofs in Model Group	
Delete Frames in Model Groups	
Show Identical Roofs	
Copy/Update Frames in Identical Roofs	
Frame and Copy/Update in Identical Roofs	
Update Frames in Identical Roofs	
Update Frames by Roof Link in Identical Roofs	
Delete Frames in Identical Roofs	
Isolate Selected Roofs	
Unhide Roofs	
Create Assemblies for Identical Roofs	
Disassemble Assemblies for Identical Roofs	
Show Primary Assembly	
Show Primary & Secondary Assemblies	

All Roofs are Unique in Model Group – lets you treat each Roof Framing individually. This function is recommended when some identical roofs in Model Group need to be framed differently.

Example: Only one roof is selected from model group, which will have unique framing

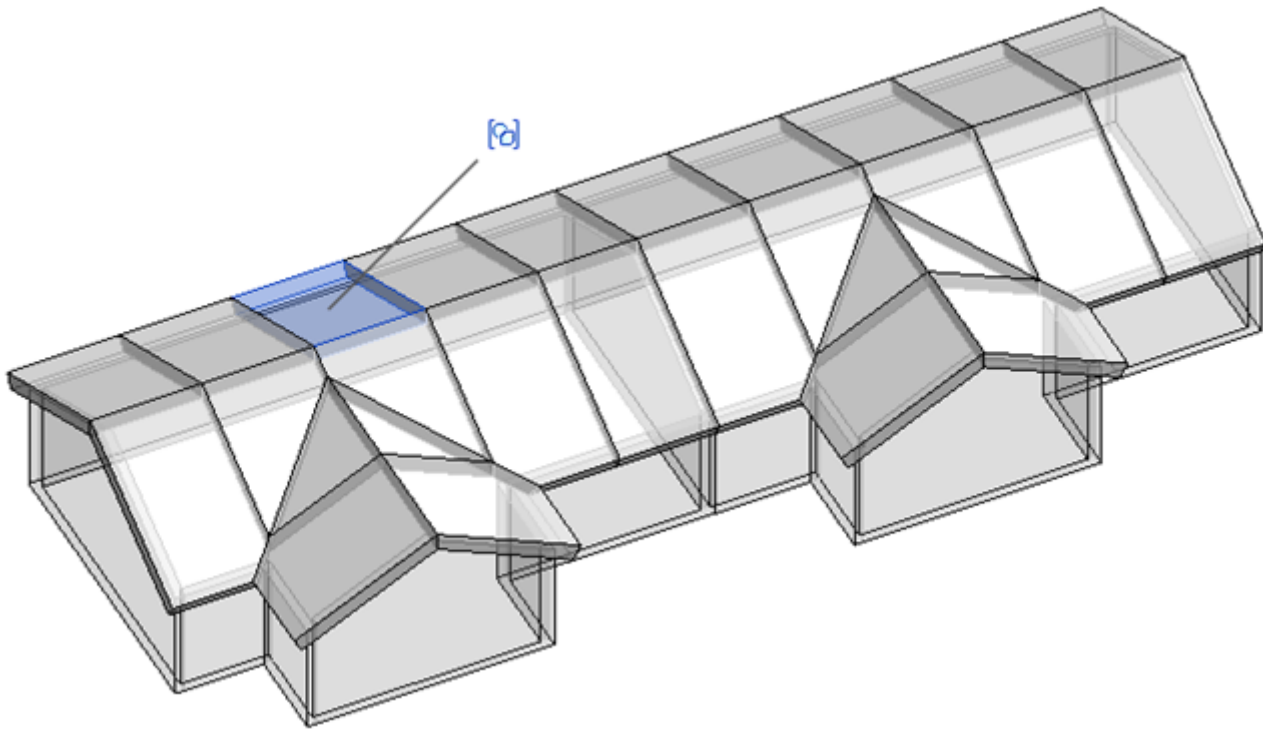

Copy/Update Frames in Model Groups

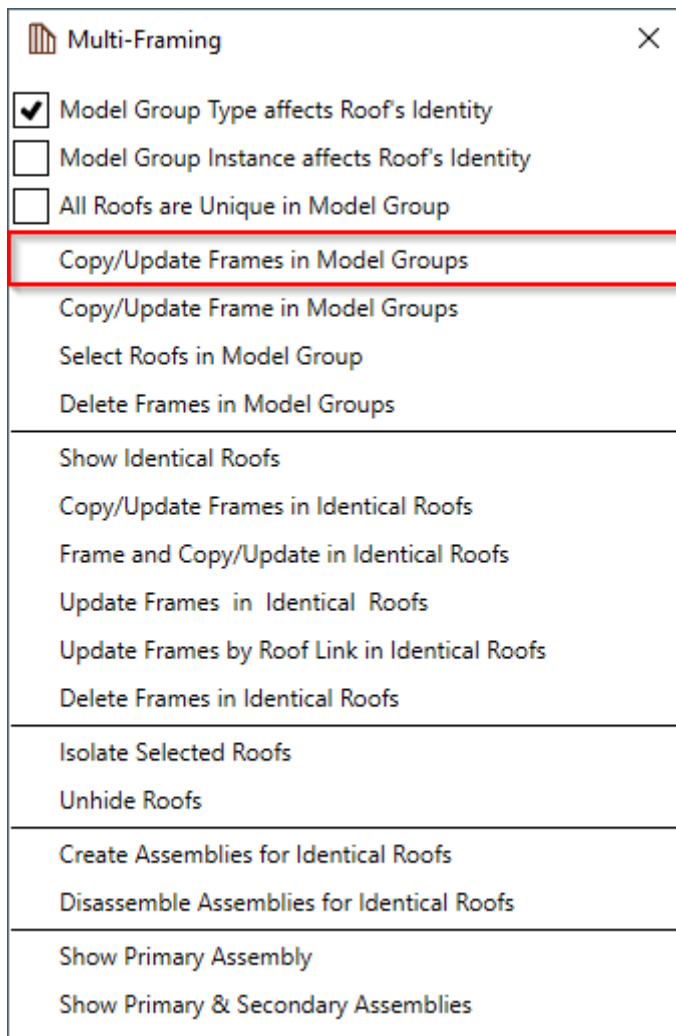

Copy/Update Frame in Model Groups – copies and/or updates all frames from selected Model Group into identical roofs from the same Model Groups.

This feature helps save time because you will not need to frame roofs from the same model groups individually. You just need to frame roofs from one group and then, using this feature, copy/update it to other identical roofs from the same groups.

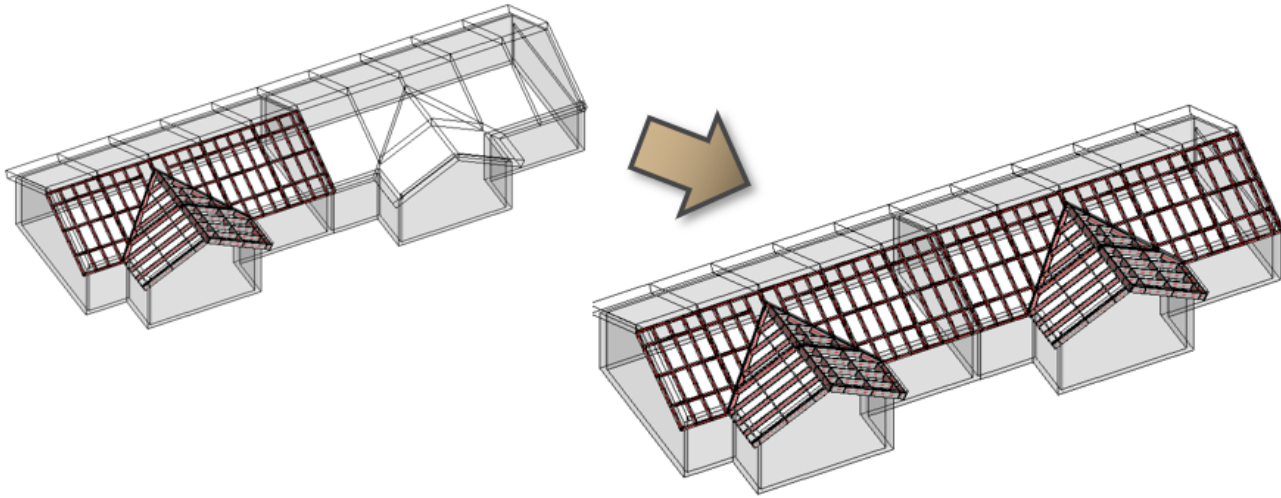

Copy/Update Frame in Model Groups

 Multi-Framing ×
<input checked="" type="checkbox"/> Model Group Type affects Roof's Identity
<input type="checkbox"/> Model Group Instance affects Roof's Identity
<input type="checkbox"/> All Roofs are Unique in Model Group
Copy/Update Frames in Model Groups
Copy/Update Frame in Model Groups
Select Roofs in Model Group
Delete Frames in Model Groups
Show Identical Roofs
Copy/Update Frames in Identical Roofs
Frame and Copy/Update in Identical Roofs
Update Frames in Identical Roofs
Update Frames by Roof Link in Identical Roofs
Delete Frames in Identical Roofs
Isolate Selected Roofs
Unhide Roofs
Create Assemblies for Identical Roofs
Disassemble Assemblies for Identical Roofs
Show Primary Assembly
Show Primary & Secondary Assemblies

Copy/Update Frame in Model Groups – copies (and/or updates) selected frame into identical roofs from the same Model Groups.

This feature helps save time because you will not need to frame roofs from same model groups individually. You just need to frame one roof from one group and then, using this feature, copy/update it to other identical roofs from the same groups.

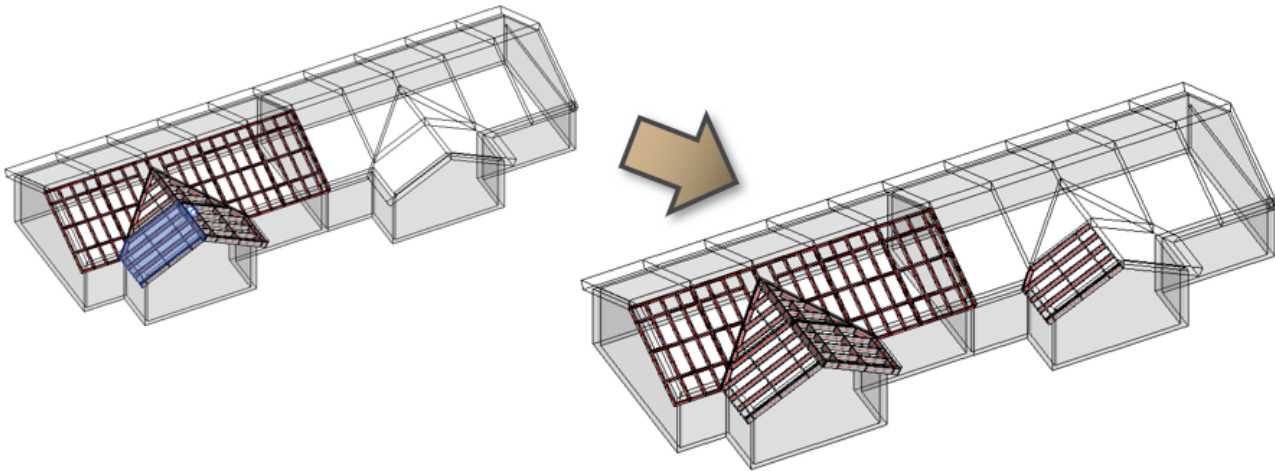

Select Roofs in Model Group

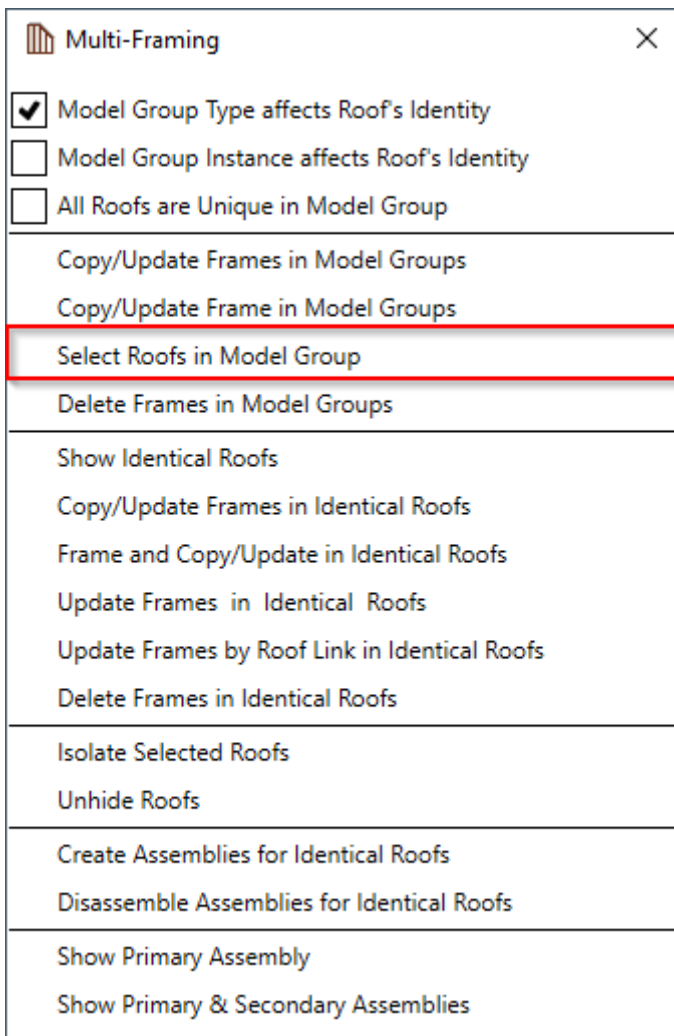

Select Roofs in Model Group – selects all roofs from selected Model Group.

After selecting roofs, you can frame roofs using **Frame Roof** feature.

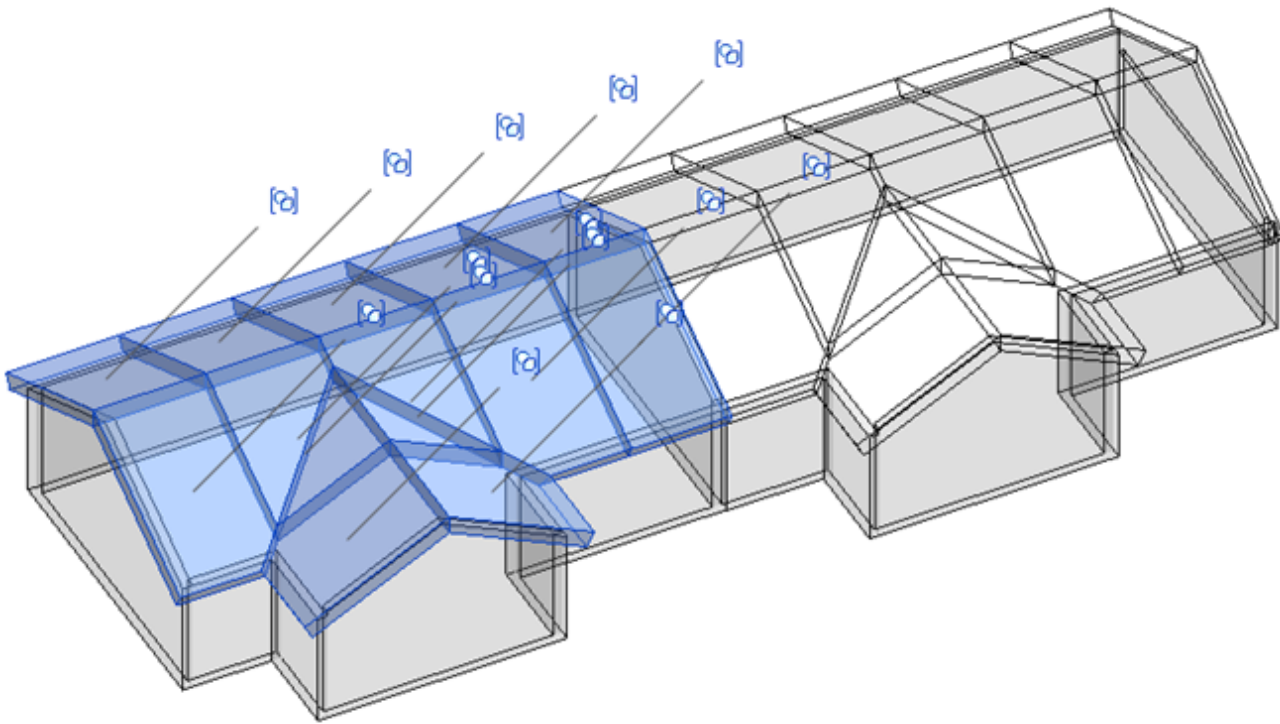

Delete Frames in Model Group

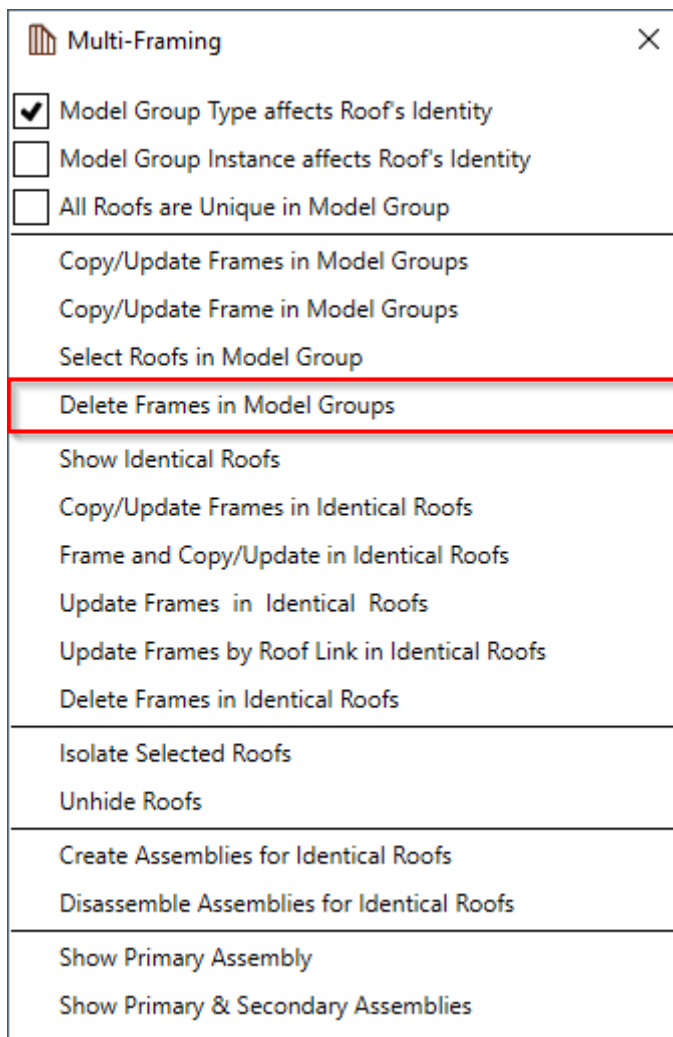

Delete Frames in Model Group – deletes all frames from identical Model Groups.

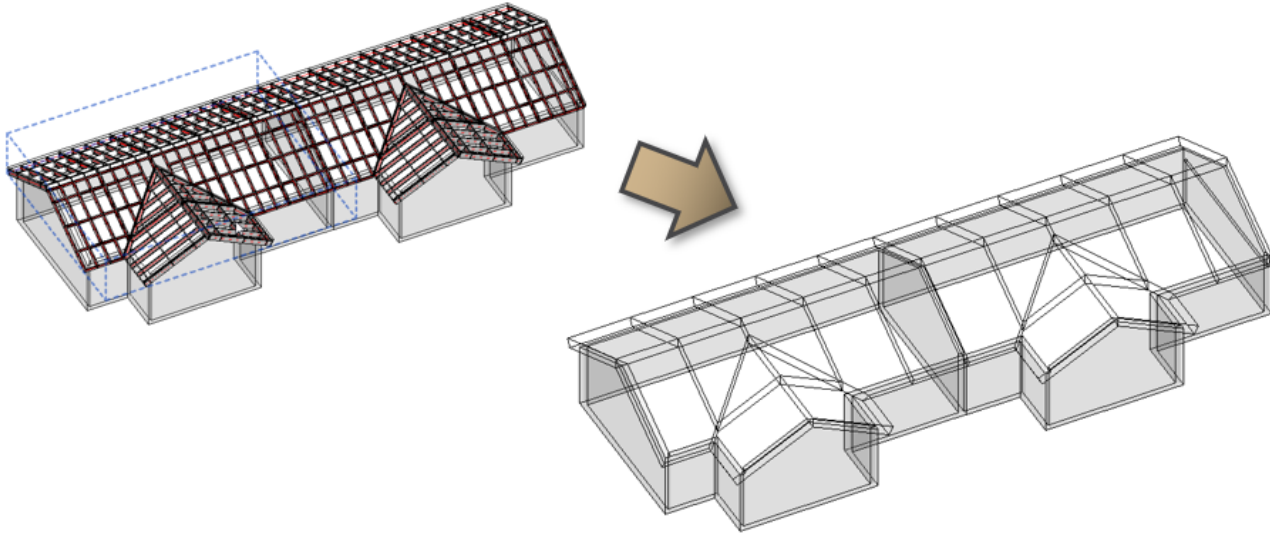

Show Identical Roofs

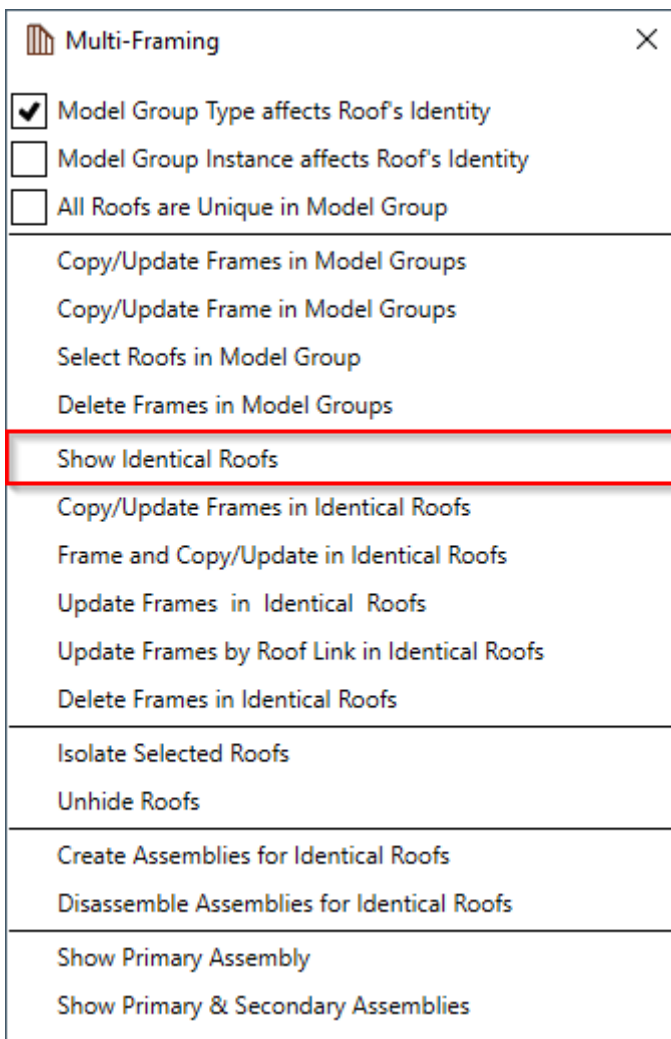

Show Identical Roofs – selects and shows identical roofs in the project according to Model Group filtering rules.

Identical roofs are those roofs that are identical according to their geometry.

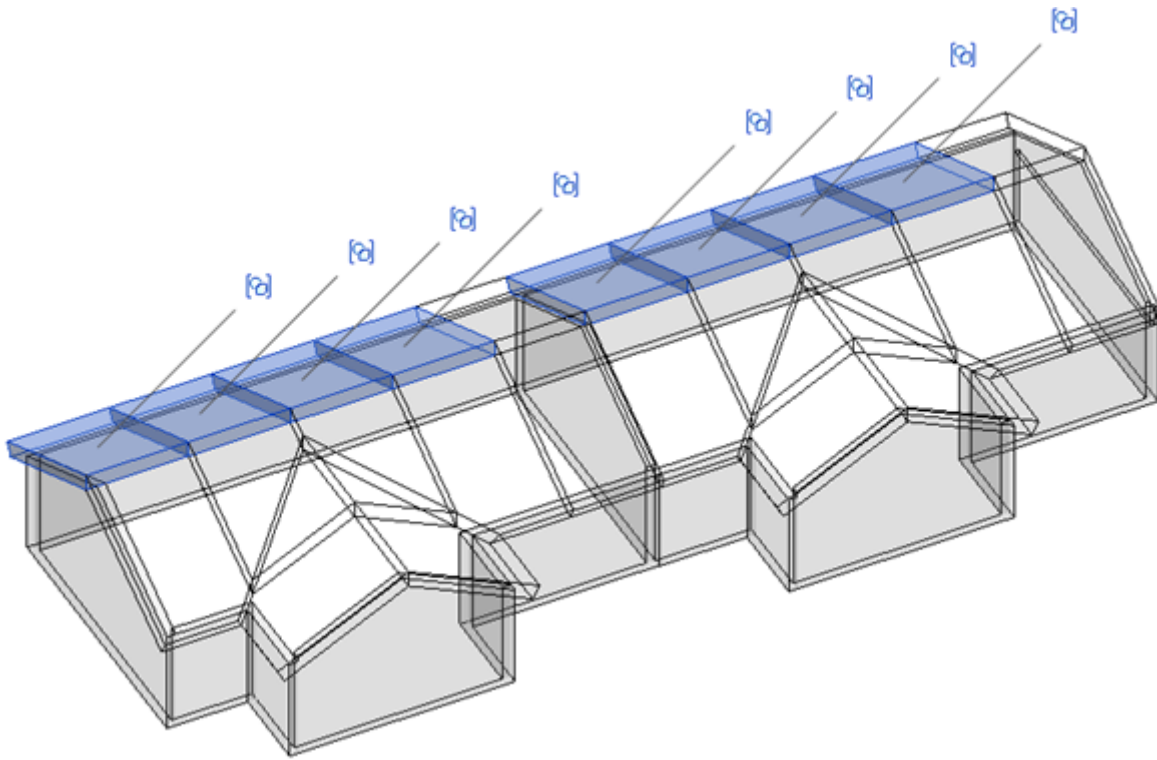

Copy/Update Frames in Identical Roofs

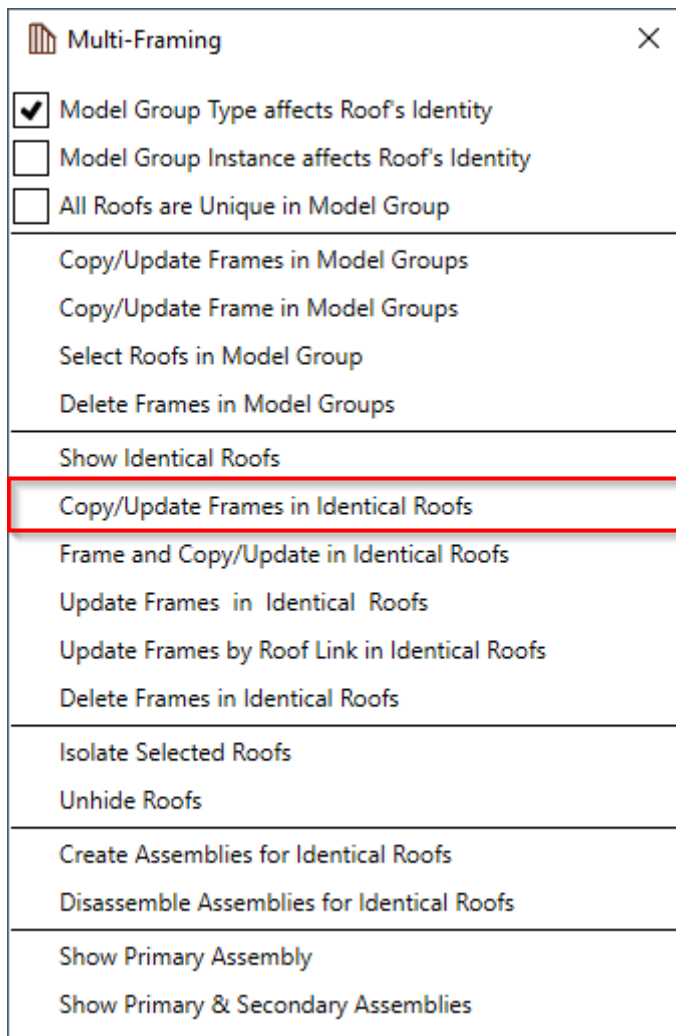

Copy/Update Frames in Identical Roofs – copies selected Frame or Secondary Frame into identical roofs and/or updates existing Frame of identical roofs. All changes will be transferred and overwritten according to the filtering rules.

Identical roofs can be in the group or not.

This function is recommended when a primary roof is framed (with all additional elements if needed) and all identical roofs need to be framed according to the primary roof.

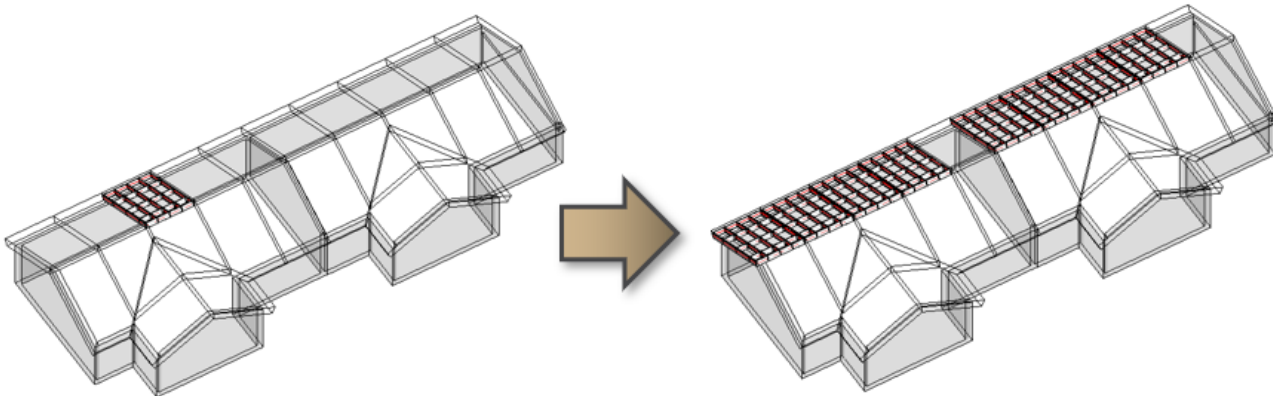

Frame and Copy/Update in Identical Roofs

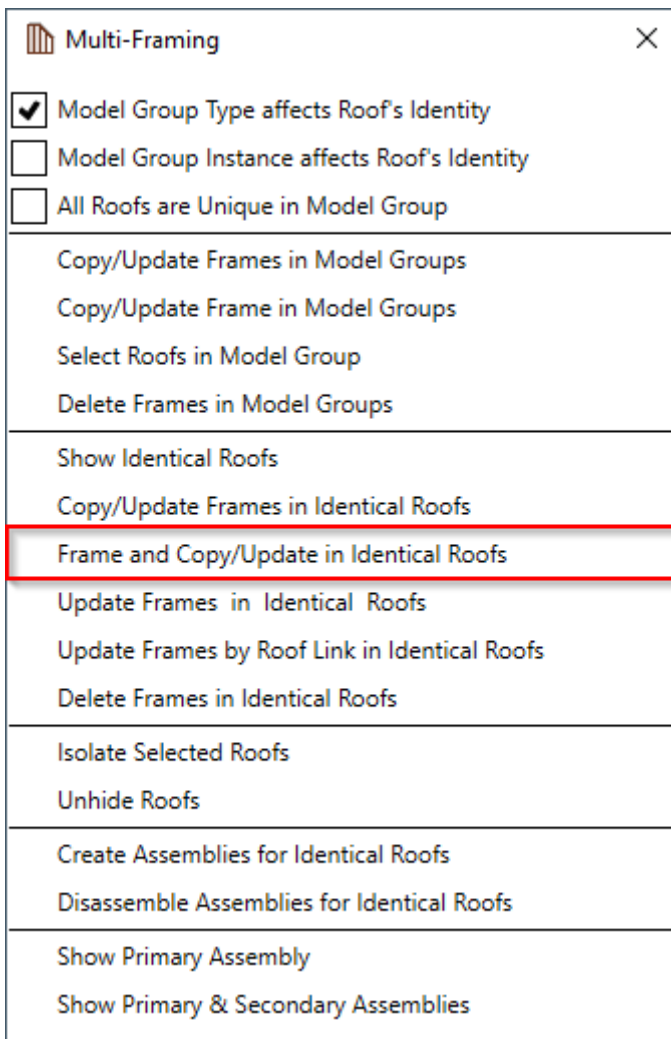

Frame and Copy/Update in Identical Roofs – frames selected roof according to its **Framing Configuration** and then copies selected roof's Frame into identical roofs and/or replaces existing Frame of identical roofs. All framing elements will be transferred and overwritten according to filtering rules.

Identical roofs can be in the group or not.

This function is recommended when all identical roofs have to be framed only according to the **Framing Configuration** and manually-placed elements or modifications are not needed.

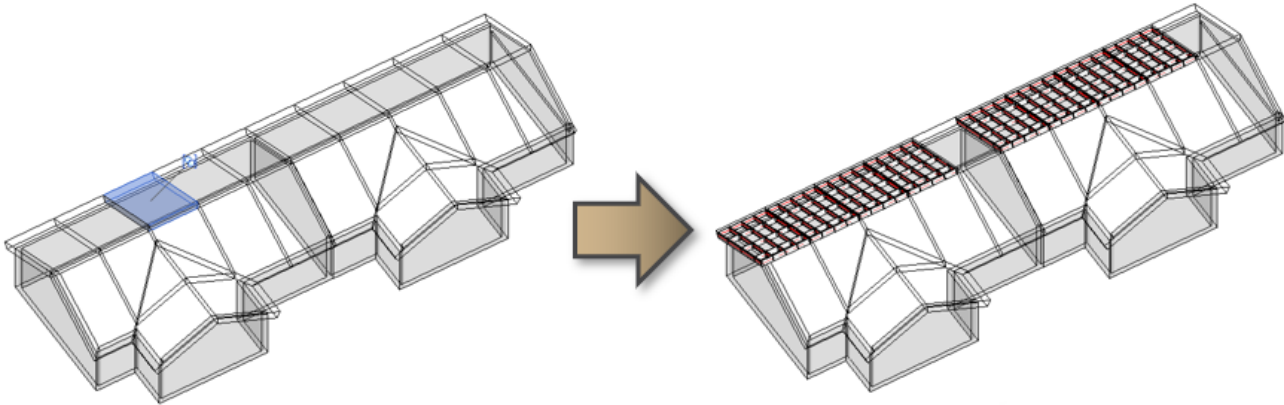

Update Frames in Identical Roofs

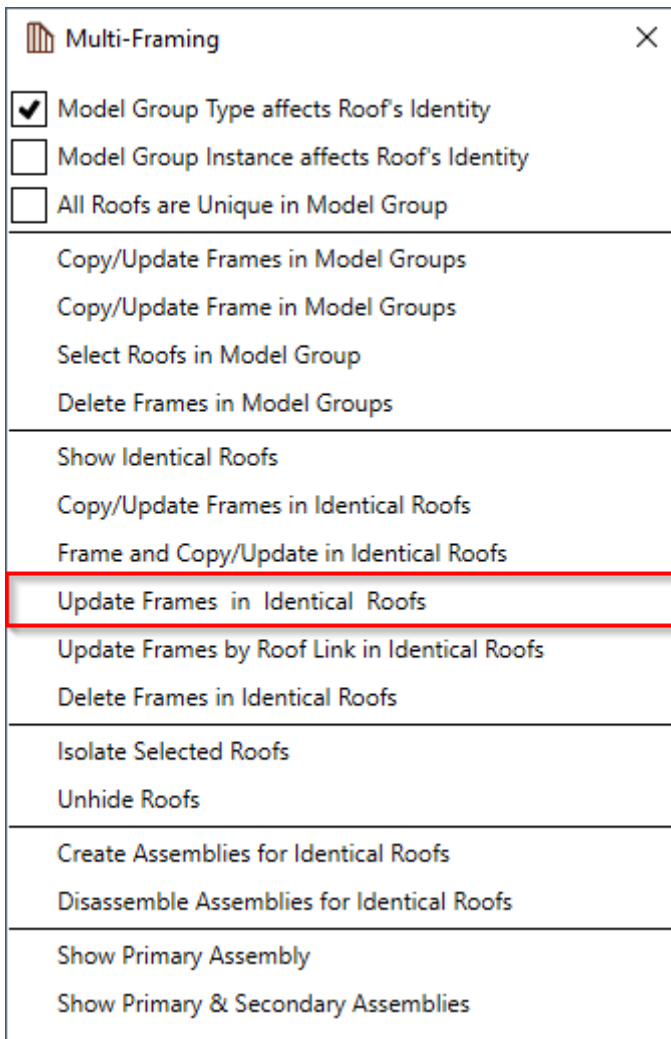

Update Frames in Identical Roofs – updates all framing elements in identical roofs according to the changes that were made to framing elements of the selected roof. All framing elements will update according to filtering rules.

Identical roofs can be in the group or by themselves.

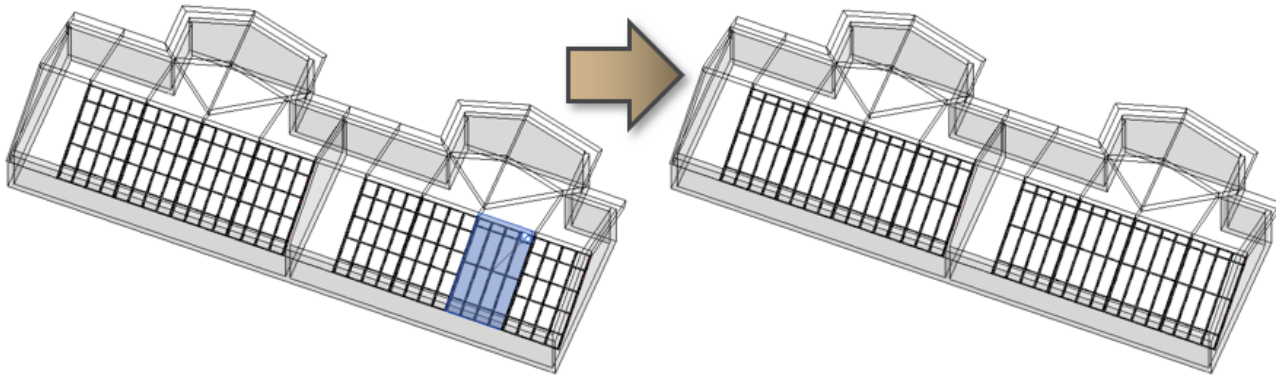

Update Frames by Roof Link in Identical Roofs

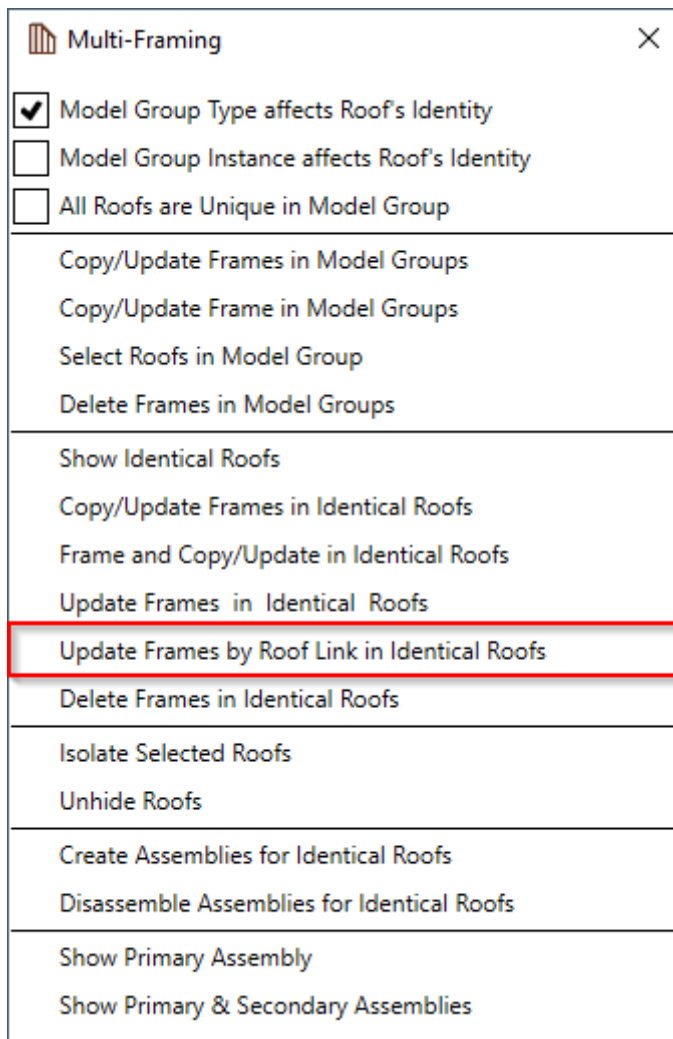

Update Frames by Roof Link in Identical Roofs – updates all framing elements in identical roofs according to **Framing Configuration** of the selected roof in **Link Roof** assignment. All framing elements will be transferred and overwritten according to filtering rules.

Identical roofs can be in the group or by themselves.

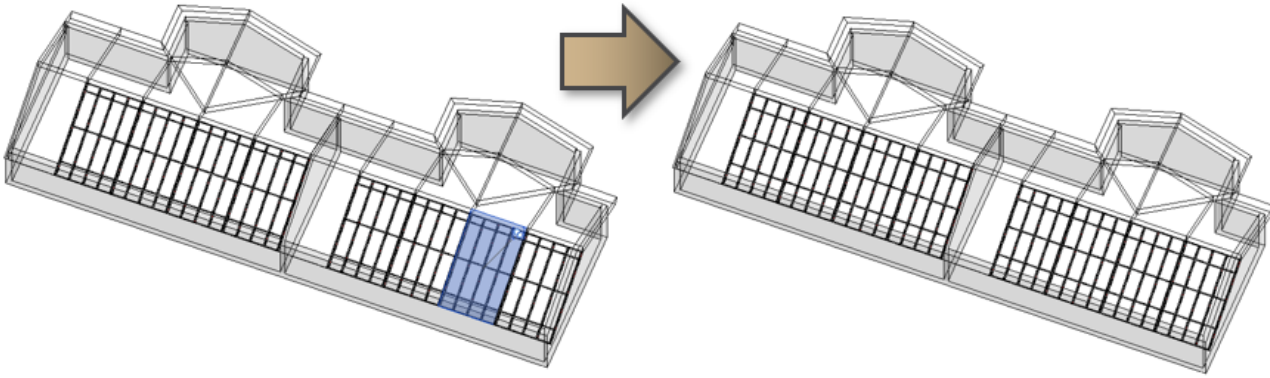

Delete Frame in Identical Roofs

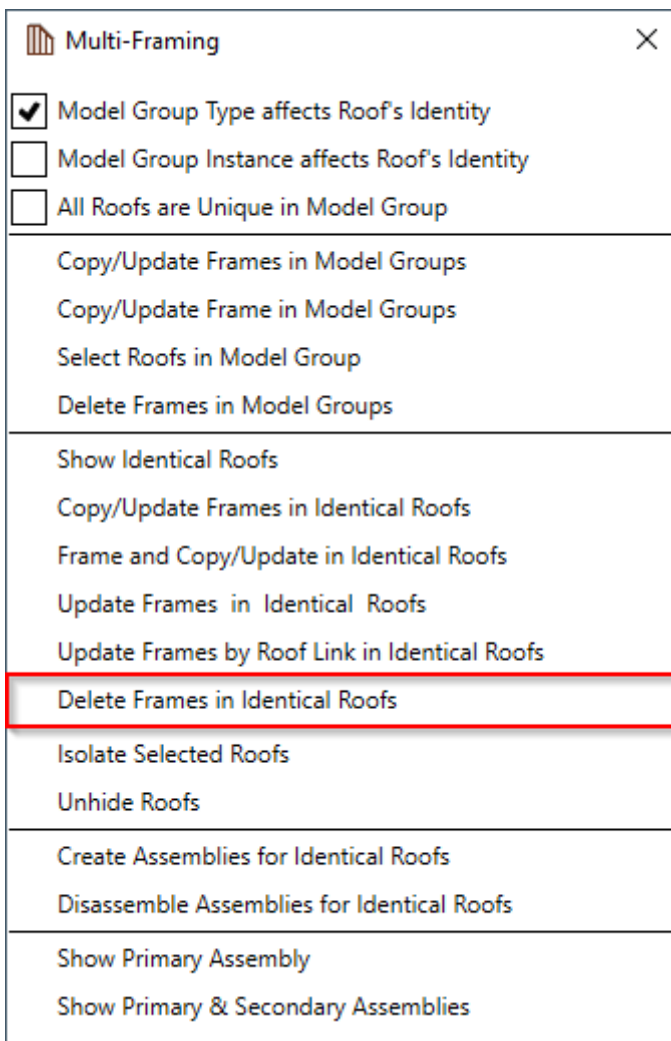

Delete Frames in Identical Roofs – deletes all framing elements in the selected roof and roofs identical to it. Framing will be deleted in accordance with filtering rules.

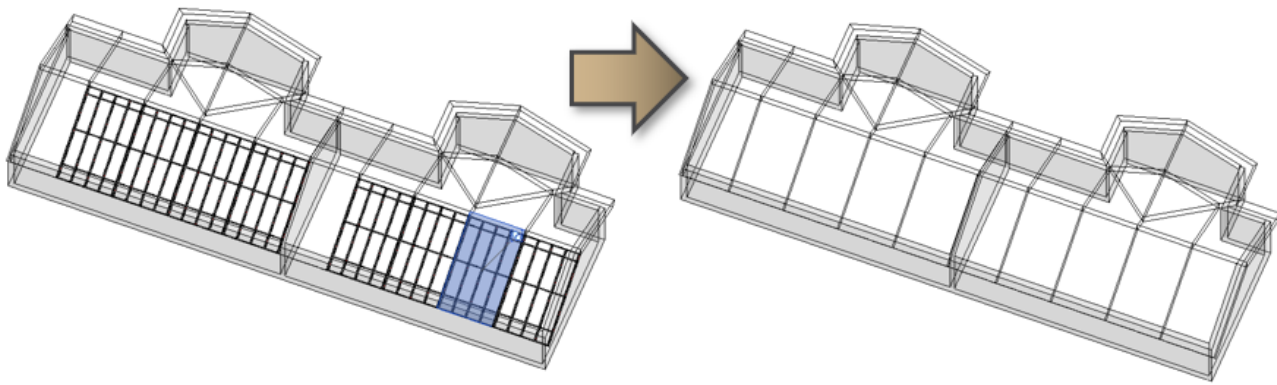

Isolate Selected Roofs

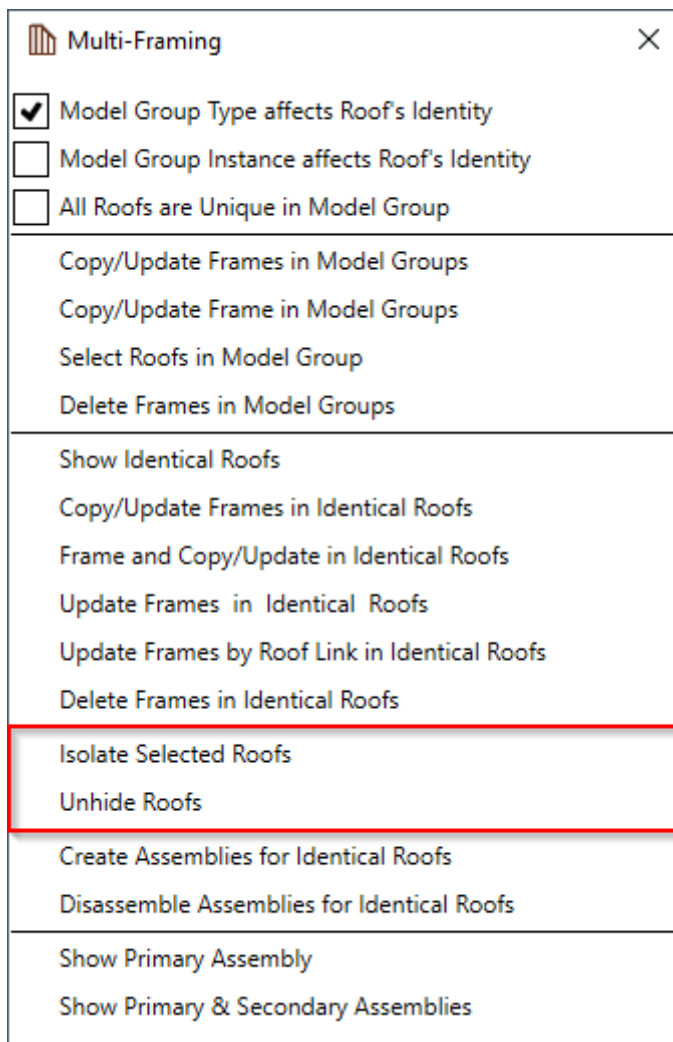

Isolate Selected Roofs – isolates selected roofs, including frames in the active view. All other elements will be permanently hidden in the active view.

To restore hidden elements, use **Unhide Roofs** function.

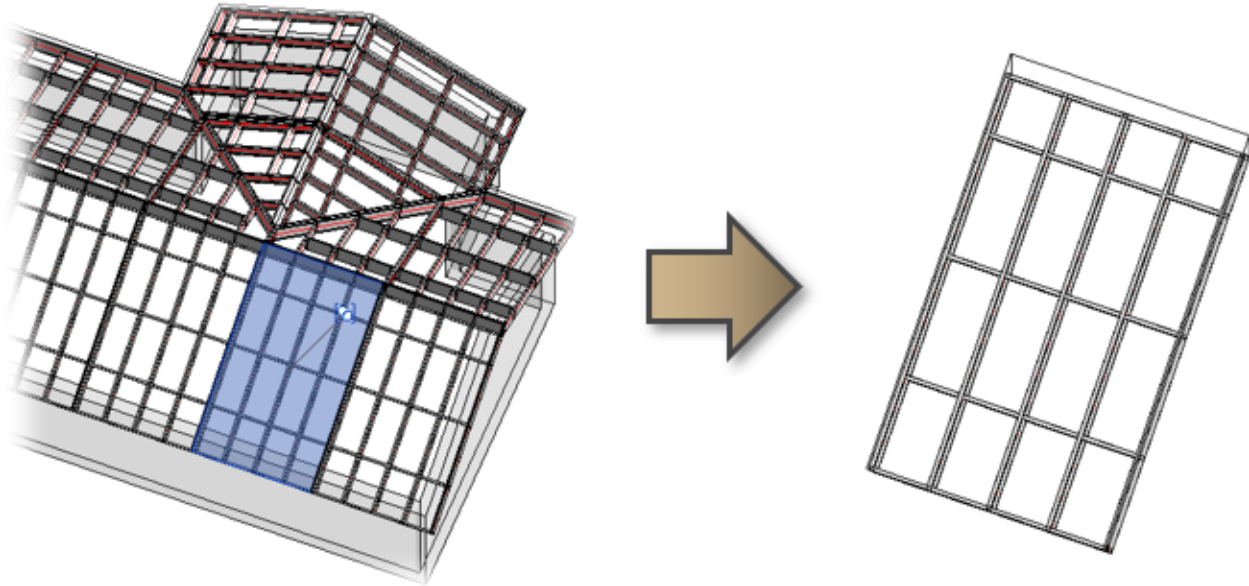

Create Assemblies for Identical Roofs

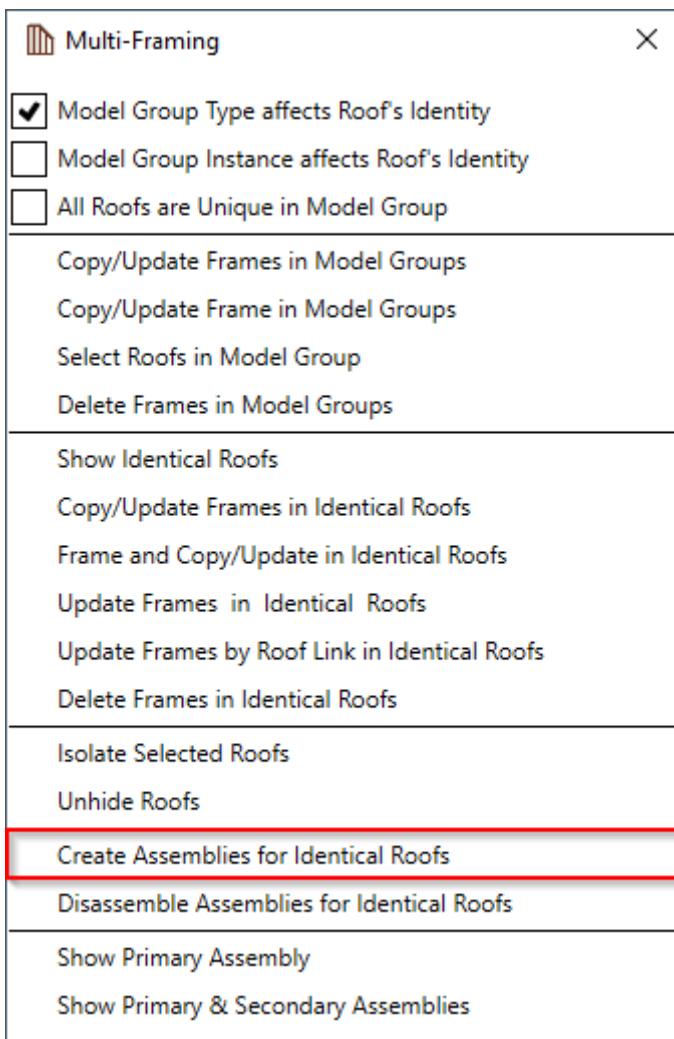

Create Assemblies for Identical Roofs – finds identical roofs from the project and creates assembly, which contains user-predefined shop drawings, including schedules and sheets. One assembly is primary, which can be modified and updated; others are secondary.

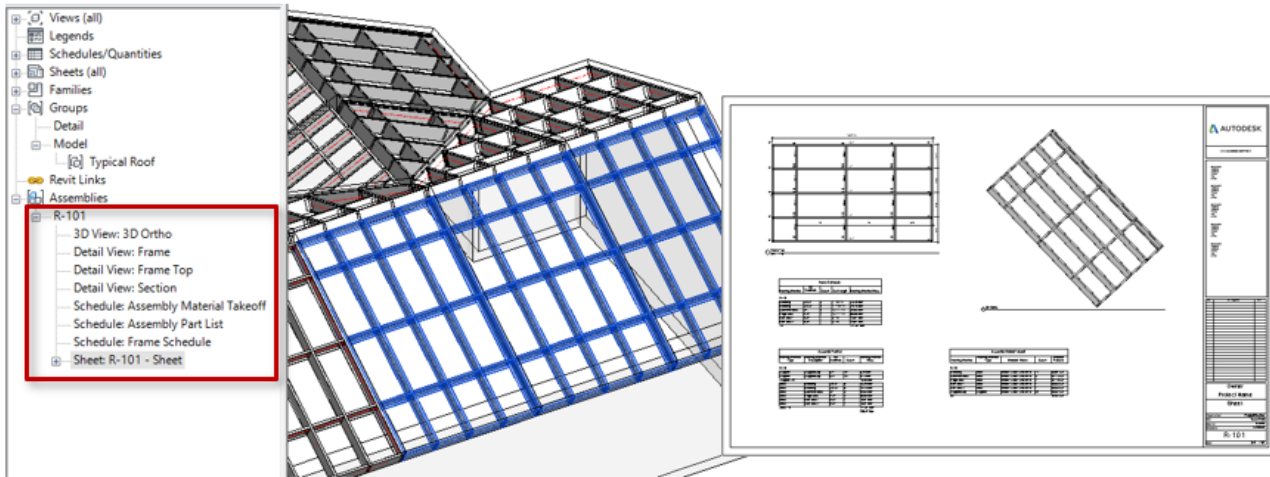

Disassemble Assemblies for Identical Roofs

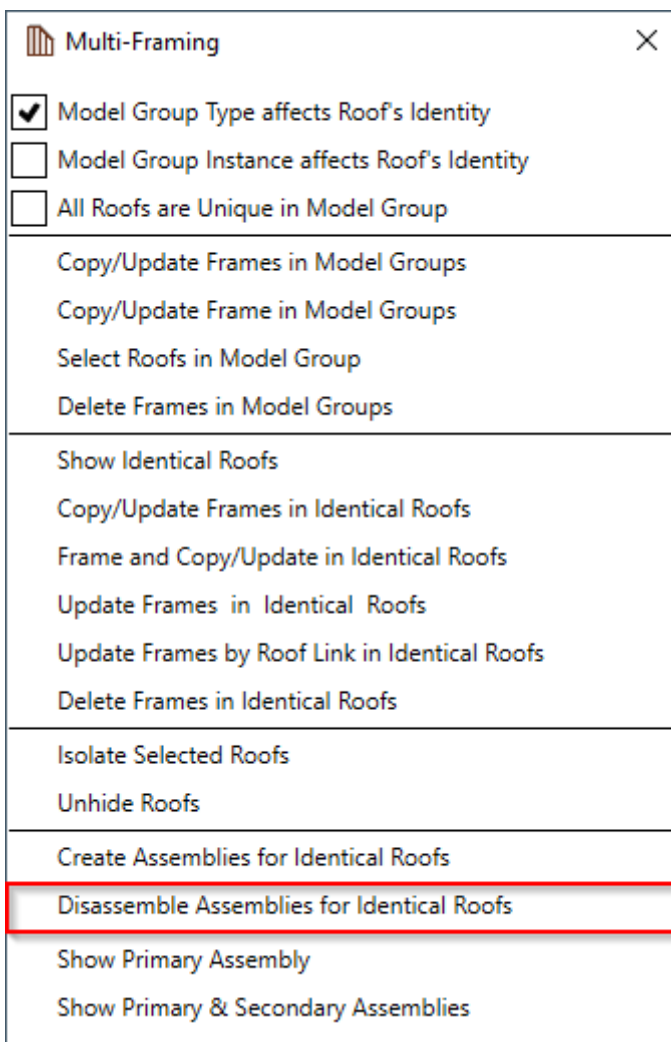

Disassemble Assemblies for Identical Roofs – finds identical assemblies in the project and disassembles them.

Show Primary Assembly

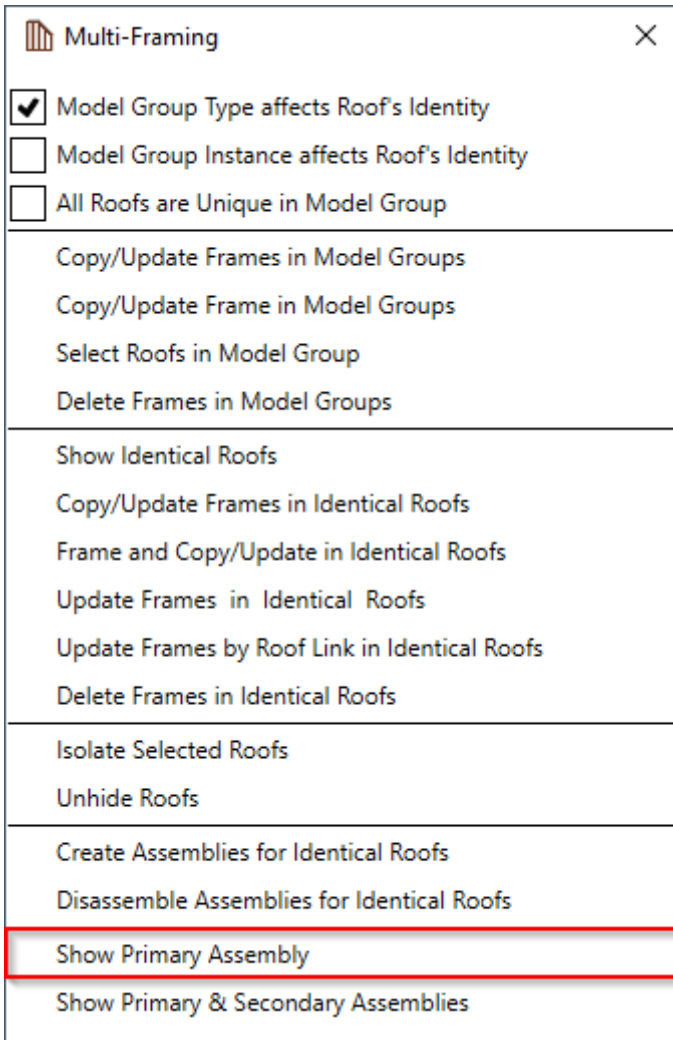

Show Primary Assembly – selects and shows primary assembly so that it can be modified/updated if needed.

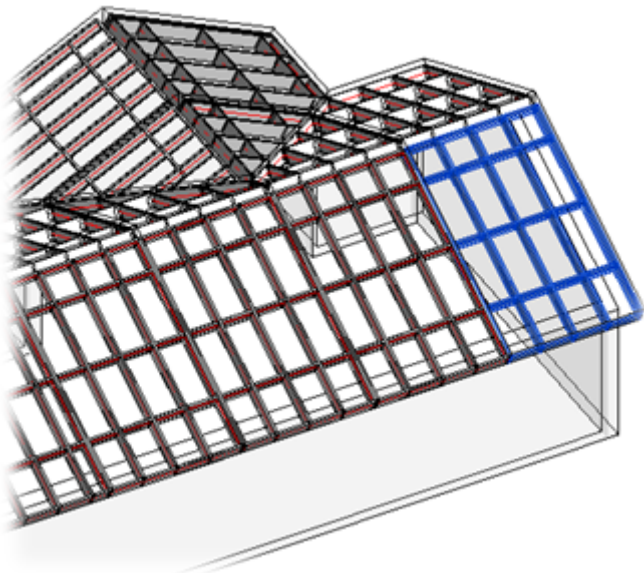

Show Primary & Secondary Assemblies

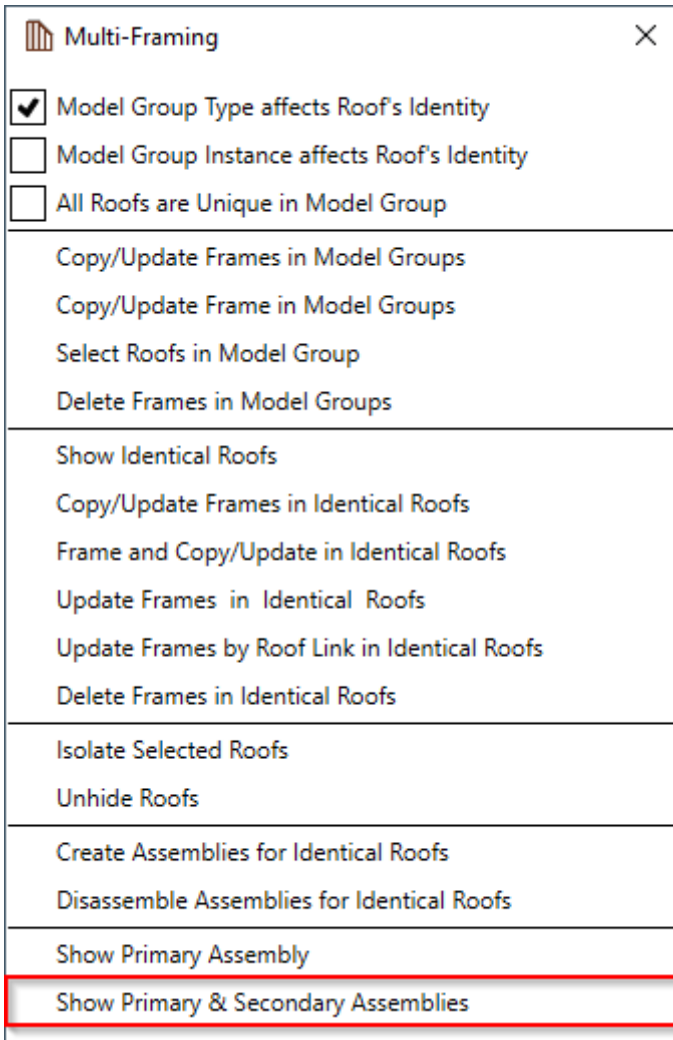

Show Primary & Secondary Assemblies – selects and shows primary and secondary assemblies so that they can be found and checked in a big project.

