

# ADD/MODIFY ELEMENTS – Add Vertical Block

Modified on: Tue, 12 Jan, 2021 at 9:09 PM

## Add/Modify Elements

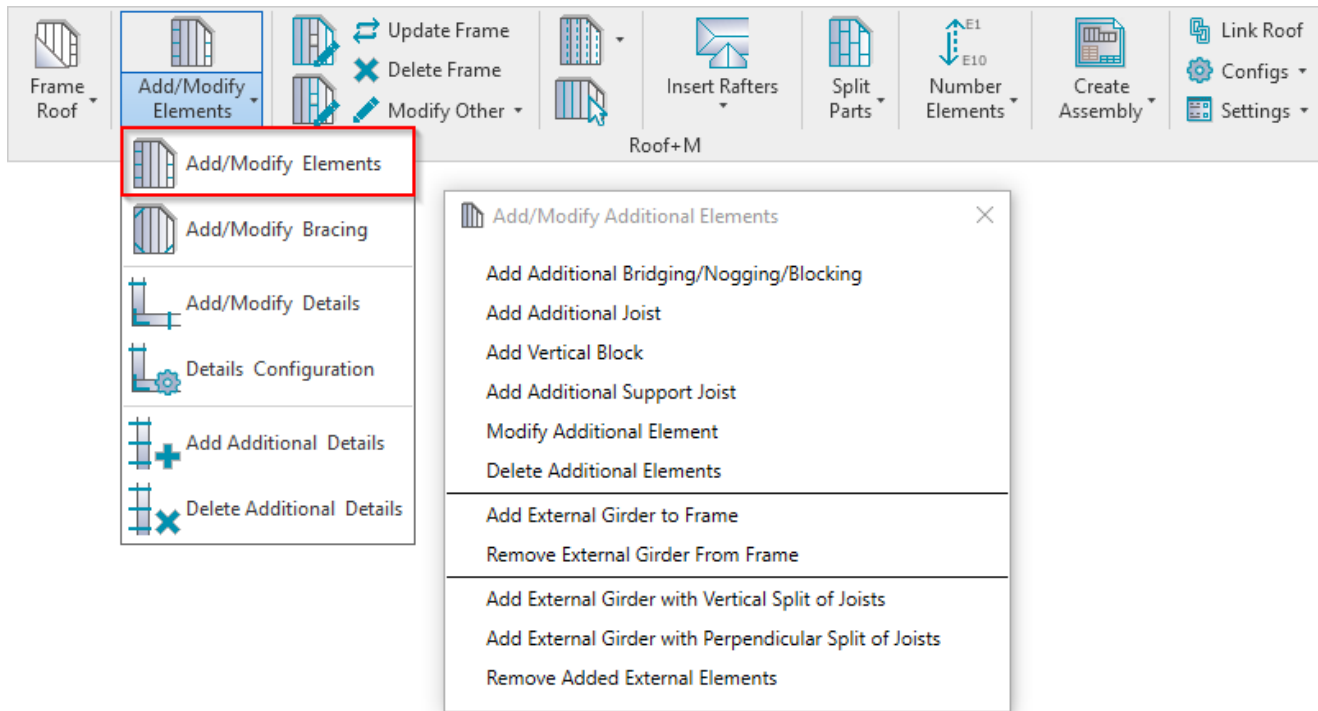

**Add/Modify Elements** – features for adding/modifying additional joists, support joists, bridging/nogging elements, etc.

## Add Vertical Block

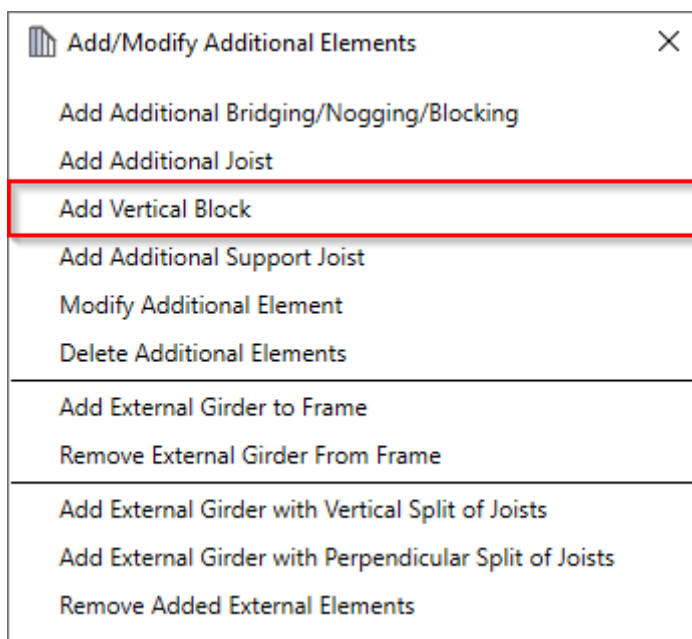

**Add Vertical Block** – adds additional block using joists into selected frame with predefined settings.

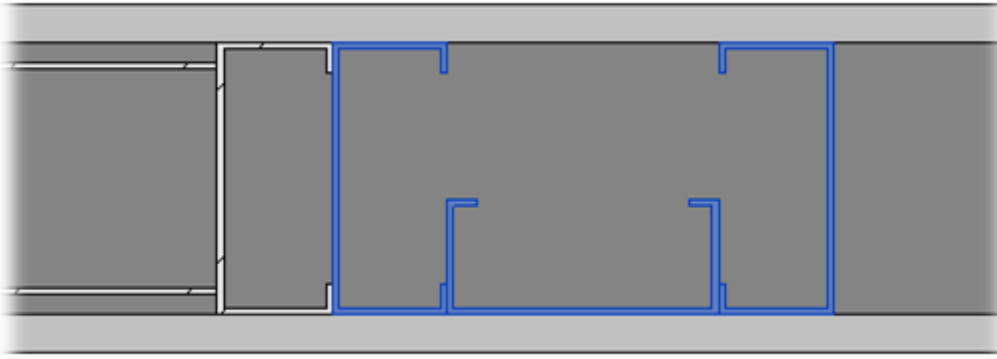

## Distance Lock to

**R** Roof+M. Add Vertical Block

Additional Vertical Block

Insert Direction from Selected Joist: Left

**Distance Lock to**: Selected Joist

Distance/Spacing: 0

Custom Join

Read Layout from Database: -- Select --

Configuration

Predefined Layout Name: *Default Configuration* Save to Database Duplicate Delete

New Item Remove Item Move Up Move Down

	X-Position	Count	Type	Depth by Core	Rotate 90	Rotate 180	Spacing	Position
1	Standard	1	M_MF Blocking Stud-Joist : C07?	<input checked="" type="checkbox"/>	<input type="checkbox"/>	<input type="checkbox"/>	0 mm	Center
2	Standard	1	M_MF Blocking Stud-Joist : C07?	<input checked="" type="checkbox"/>	<input checked="" type="checkbox"/>	<input type="checkbox"/>	0 mm	Internal

Symbolic Preview

OK Close

**Distance Lock to** – an additional vertical block can be inserted with predefined distance from selected joist, roof start/end, or selected external element.

## Distance/Spacing

Additional Vertical Block

Insert Direction from Selected Joist: Left

Distance Lock to: Selected Joist

Distance/Spacing: -400

Custom Join

Read Layout from Database: -- Select --

Configuration

Predefined Layout Name: *Default Configuration*

	X-Position	Count	Type	Depth by Core	Rotate 90	Rotate 180	Spacing	Position
1	Standard	1	M_MF Blocking Stud-Joist : C07!	<input checked="" type="checkbox"/>	<input type="checkbox"/>	<input type="checkbox"/>	0 mm	Center
2	Standard	1	M_MF Blocking Stud-Joist : C07!	<input checked="" type="checkbox"/>	<input checked="" type="checkbox"/>	<input type="checkbox"/>	0 mm	Internal

Symbolic Preview

**Distance/Spacing** – distance/spacing from selected joist, start/end of roof, or selected external element to the block.

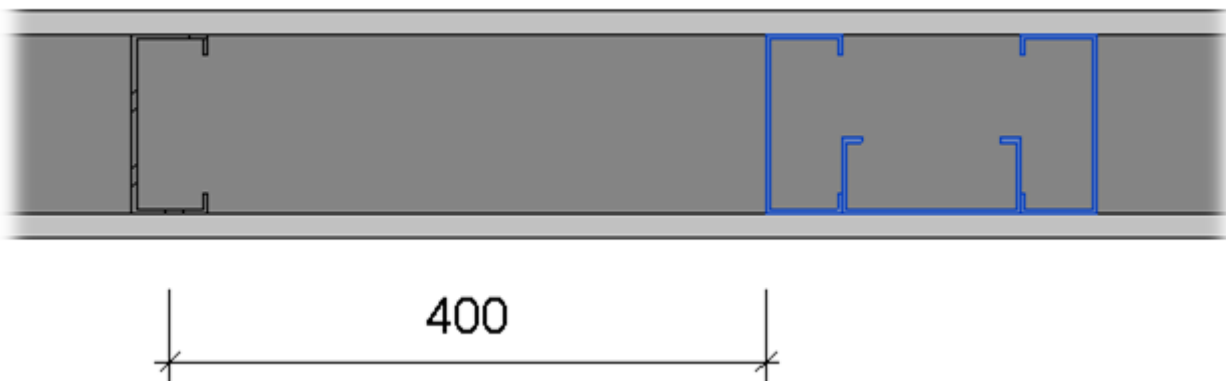

## Custom Join

Additional Vertical Block

Insert Direction from Selected Joist:

Distance Lock to:

Distance/Spacing:

Custom Join

Configuration

Predefined Layout Name: *Default Configuration*

Select Layout from Database Configuration:

	X-Position	Count	Type	Define Depth...	Rotate 90°	Rotate 180°	Flip Facing	Spacing
1	<input type="text" value="Standard"/>	<input type="text" value="1"/>	M_MF Stud-Joist : C20351-15	<input checked="" type="checkbox"/>	<input type="checkbox"/>	<input type="checkbox"/>	<input type="checkbox"/>	0 mm
2	<input type="text" value="Standard"/>	<input type="text" value="1"/>	M_MF Stud-Joist : C20351-15	<input type="checkbox"/>	<input checked="" type="checkbox"/>	<input type="checkbox"/>	<input type="checkbox"/>	0 mm
3	<input type="text" value="Standard"/>	<input type="text" value="1"/>	M_MF Stud-Joist : C20351-15	<input checked="" type="checkbox"/>	<input type="checkbox"/>	<input checked="" type="checkbox"/>	<input type="checkbox"/>	0 mm

Symbolic Preview

**Custom Join** – is a multi-functional dialog where user can define rules for joins including size, count, position, rotation, spacing, alignment etc. All these rules can be saved and used in other framing configurations or shared with other users. This type of dialog is used frequently in our products, so here you can find [Custom Join detailed description >>](https://agacad.freshdesk.com/support/solutions/articles/44001990031-custom-join) (<https://agacad.freshdesk.com/support/solutions/articles/44001990031-custom-join>).