

Shop Drawing Configurations - Assembly Views - additional options

Modified on: Fri, 12 Jun, 2020 at 2:11 PM

Additional options available in Assembly views dialog window:

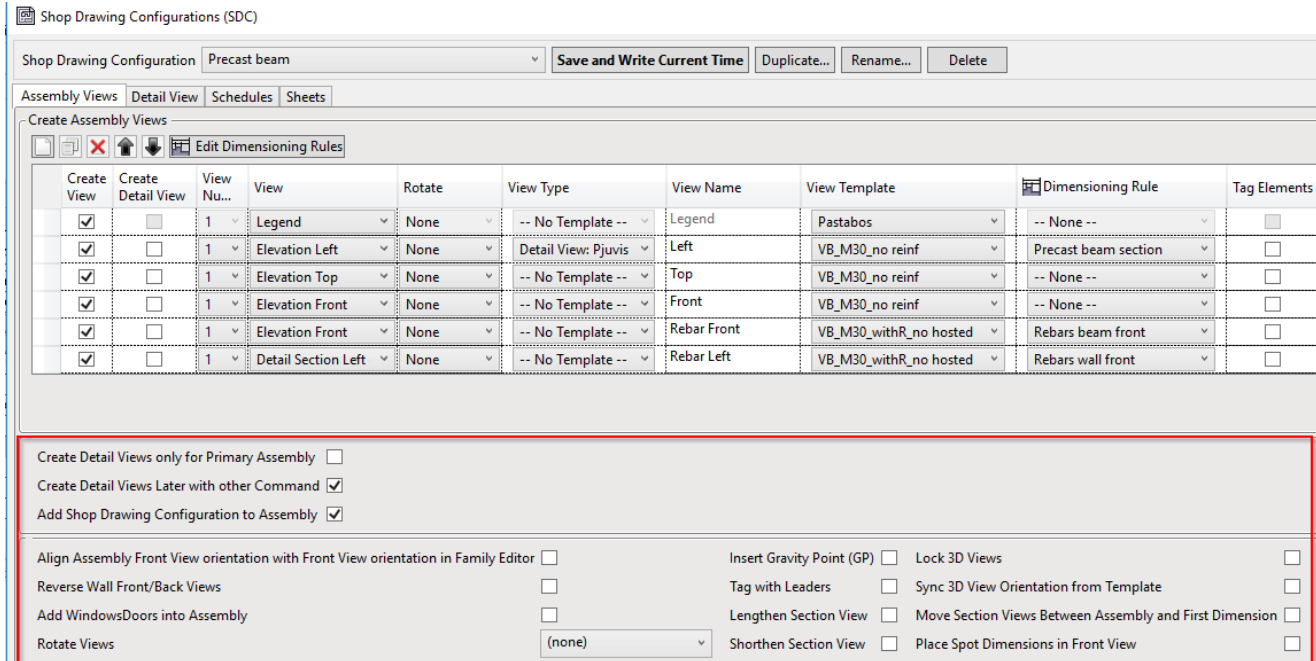

Create Detail Views only for Primary Assembly - If ticked ON, it will create Detail Views only for the Primary Assembly, else, it will create detail views for each assembly instance.

Create Detail Views Later with other Command - If ticked ON, Detail Views will not be created during Create Assembly command. Instead you will have to use a separate command later to do that.

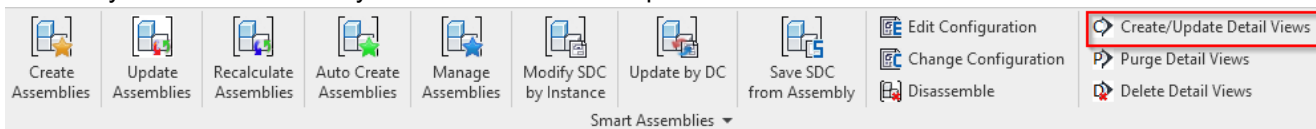

Add Shop Drawing Configuration to Assembly - This allows you to save configurations from Assembly by using Save SDC From Assembly command.

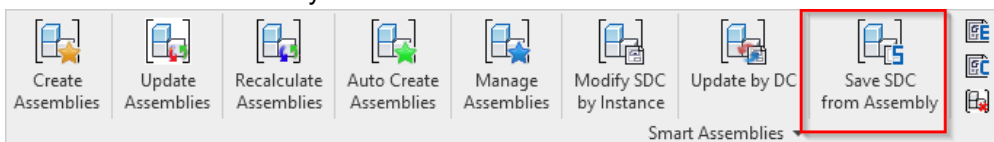

Align Assembly Front View orientation with Front view orientation in Family Editor - important for loadable Families. Front View of Assembly will be oriented as Front View in Family Editor.

Reverse Wall Front/Back Views - It will rotate assembly origin for Wall by 180 degrees, so Front View will show back side of the wall. (By default Front View is the exterior side of the Wall.)

Add WindowsDoors into Assembly - By default Window and Door Families are not added to assembly. If ticked ON, the Create and Update Assembly commands will add window/door families to assembly automatically.

Rotate Views - Select this option to rotate all views at once.

Insert Gravity Point (GP) - Insert Gravity Point of Assembly. (GP will be created only if all elements have materials assigned.)

Tag with Leaders - Related to the Tag Elements option in Assembly Views. If that one and this one are checked, then Tags will have Leaders.

Lengthen Section View - Move section heads outside dimension lines:

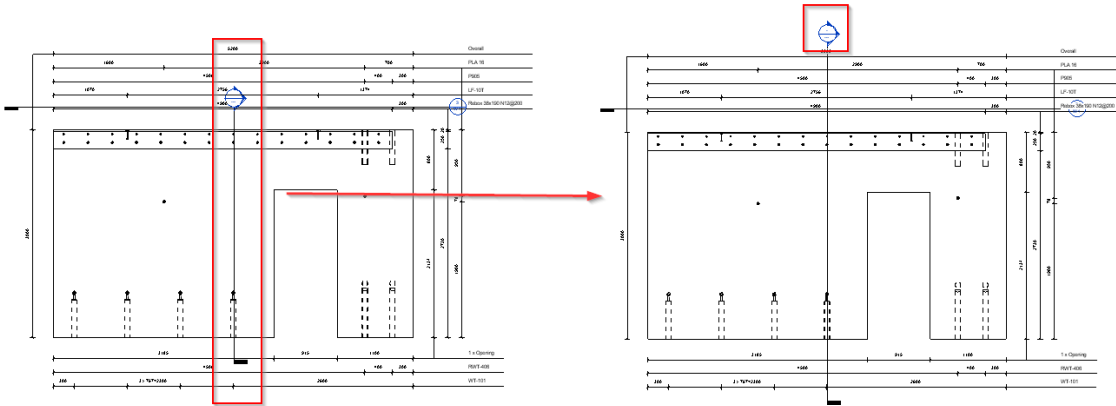

Shorten Section View - Move section heads, so they would be close to the Host as much as possible:

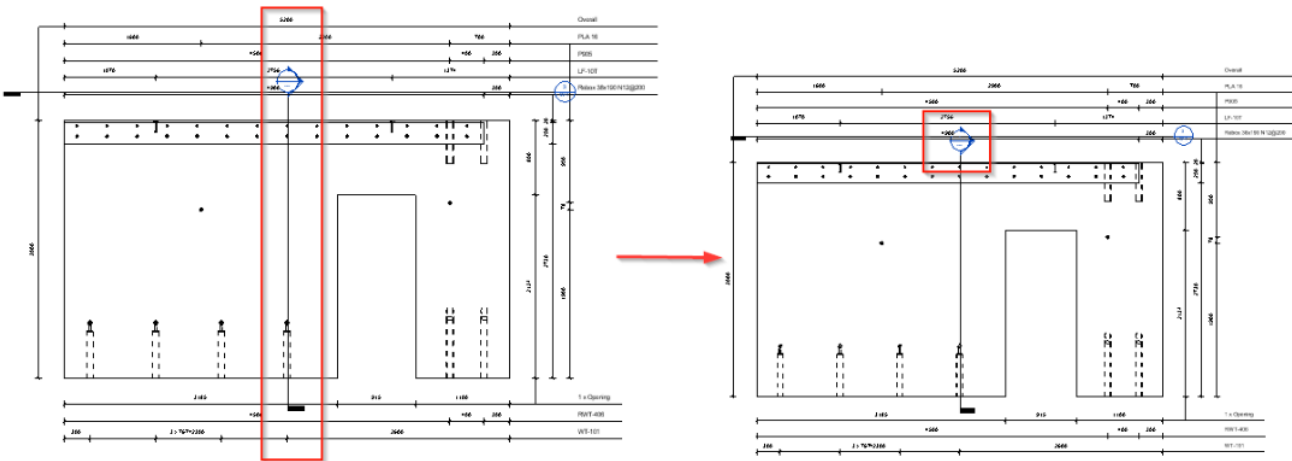

Lock 3D Views - After assembly has been created, 3D view will be locked.

Sync 3D View Orientation from Template - If ticked ON, orientation of 3D view will be based on Template Assembly's 3D view orientation.

Move Section Views Between Assembly and First Dimension - It will move elevation views closer to assembly, as stated in the name of the checkbox.

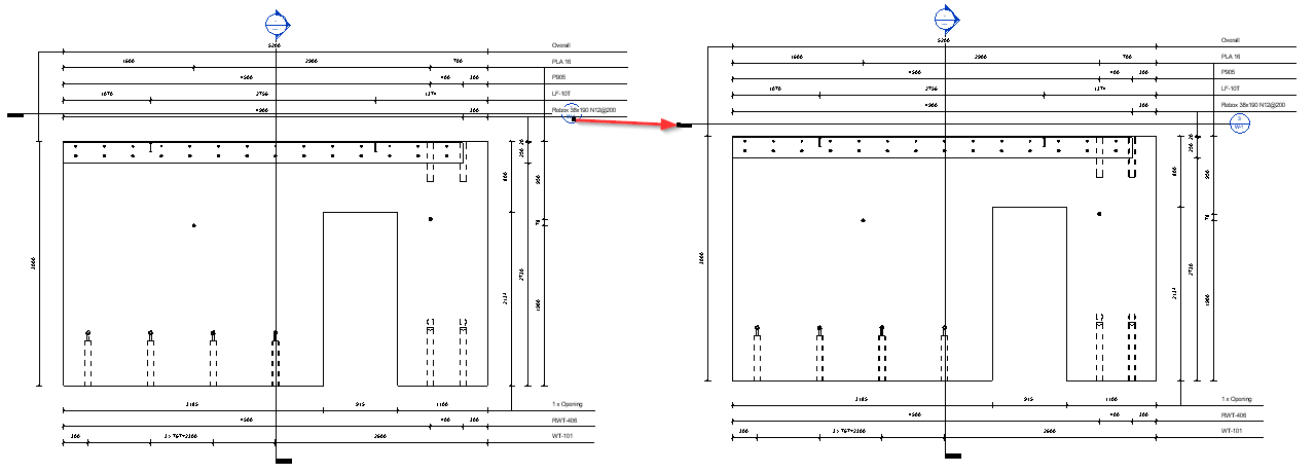

Place Spot Dimensions in Front View - For elements of Wall category, tool will place Top & Bottom spot elevations in the Front View.

