

## Special Parameters for Gravity Point

Modified on: Mon, 8 Mar, 2021 at 1:26 PM

You can add parameters with special names to get the coordinates of the Gravity Point for your assembly.

Parameters should be named as GP\_X and GP\_Y, should be Length type, and should be selected for Generic Model Category as Gravity Point Family.

**Parameter Properties**

**Parameter Type**

Project parameter  
(Can appear in schedules but not in tags)

Shared parameter  
(Can be shared by multiple projects and families, exported to ODBC, and appear in schedules and tags)

Select... Export...

**Parameter Data**

Name: GP\_X

Discipline: Common

Type of Parameter: Length

Group parameter under: Construction

Tooltip Description: <No tooltip description. Edit this parameter to write a custom tooltip. Custom tooltips hav...>

Edit Tooltip...

Type

Instance

Values are aligned per group type

Values can vary by group instance

**Categories**

Filter list: <show all>

Hide un-checked categories

- Duct Placeholders
- Duct Systems
- Ducts
- Electrical Circuits
- Electrical Equipment
- Electrical Fixtures
- Entourage
- Fire Alarm Devices
- Flex Ducts
- Flex Pipes
- Floors
- Furniture
- Furniture Systems
- Generic Models
- Grids
- HVAC Zones
- Levels
- Lighting Devices
- Lighting Fixtures
- Lines

Check All Check None

Add to all elements in the selected categories

OK Cancel Help

Coordinates will be calculated from the bottom left corner of the assembly when looking at the Front view.

Modify | Generic Models  Moves With Nearby Elements  Activate Dimensions

Properties {3D} Temporary Hide/Isolate

M\_Gravity\_Center std

Generic Models (1) Edit Type

Element Mass	
DC	
Details Created-Updated	
Assembly Created-Updated	
Assembly Depth	
Assembly Length	
Assembly Height	
Exclude from GP	<input checked="" type="checkbox"/>
GP_X	1281.2
GP_Y	2039.7

Dimensions

Volume 0.004 m<sup>3</sup>

Identity Data

Assembly Name L1-SW-2

Image

Properties help Apply

Project Browser - test 10 29 Webinar End morning.rvt

- Views (all)
- Structural Plans

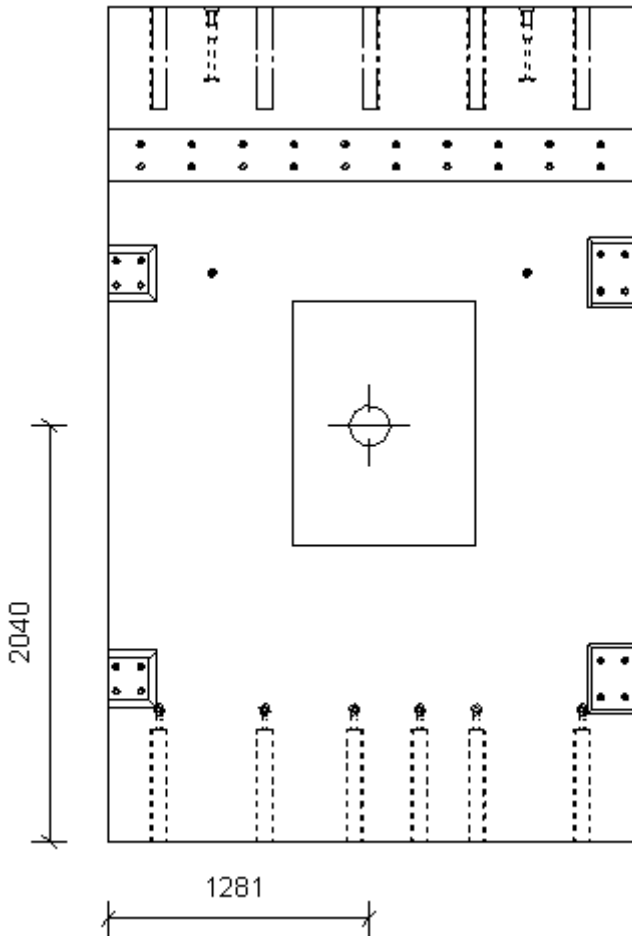

If these are shared parameters, then you can add them to the schedule:

A	B	C
Family	GP_X	GP_Y
M_Gravity_Center	1281	2040