

Floor Supports

Modified on: Wed, 5 Aug, 2020 at 3:10 PM

- Use the **Floor Supports** command to define Revit floor supports prior to using **Panel Layout** subdivision functionality.
- Select **Floor Supports** from the **Floor Panel Layout** menu.

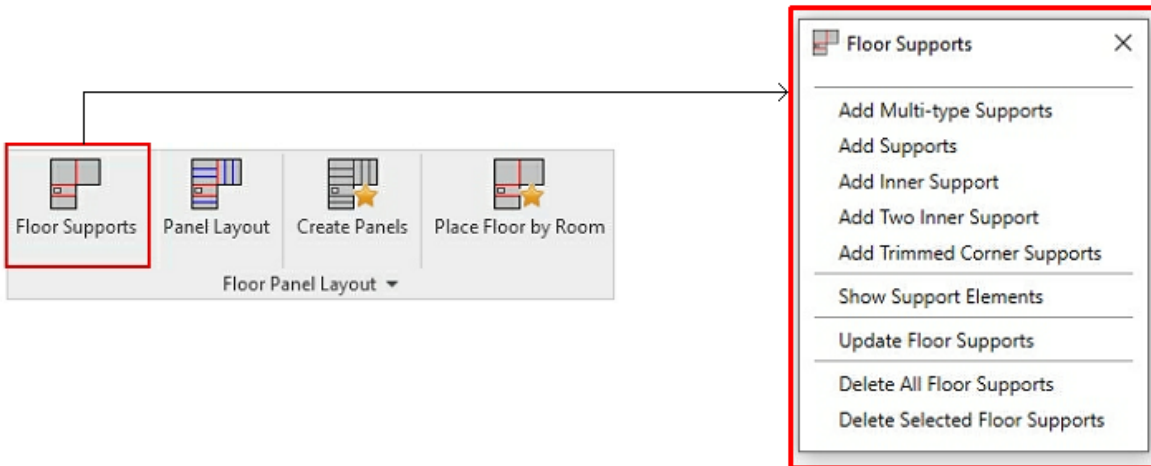

- Select **Add Supports** in the **Floor Supports** menu.

Note: Floor supports may be structural framing (beams), walls, or grid elements.

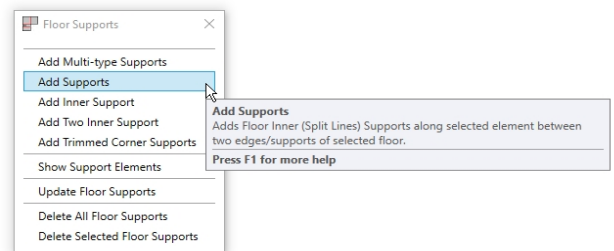
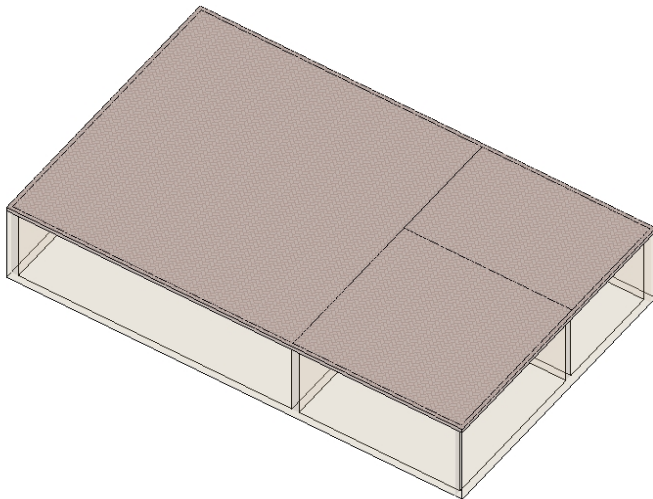

- Follow the instructions by picking floor and supports.

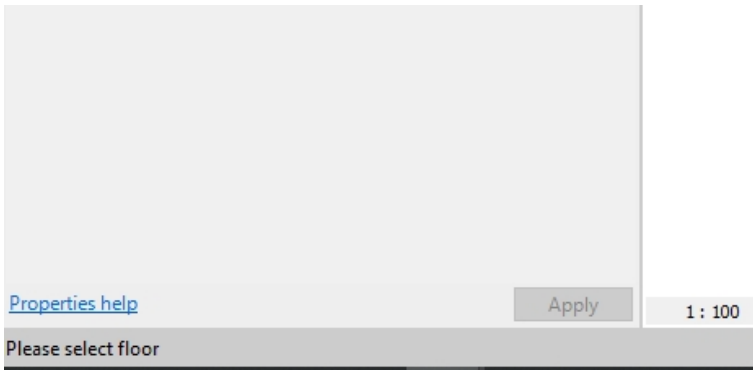

- As floor supports are added, a **Split Line** will be generated at the center of the support element.

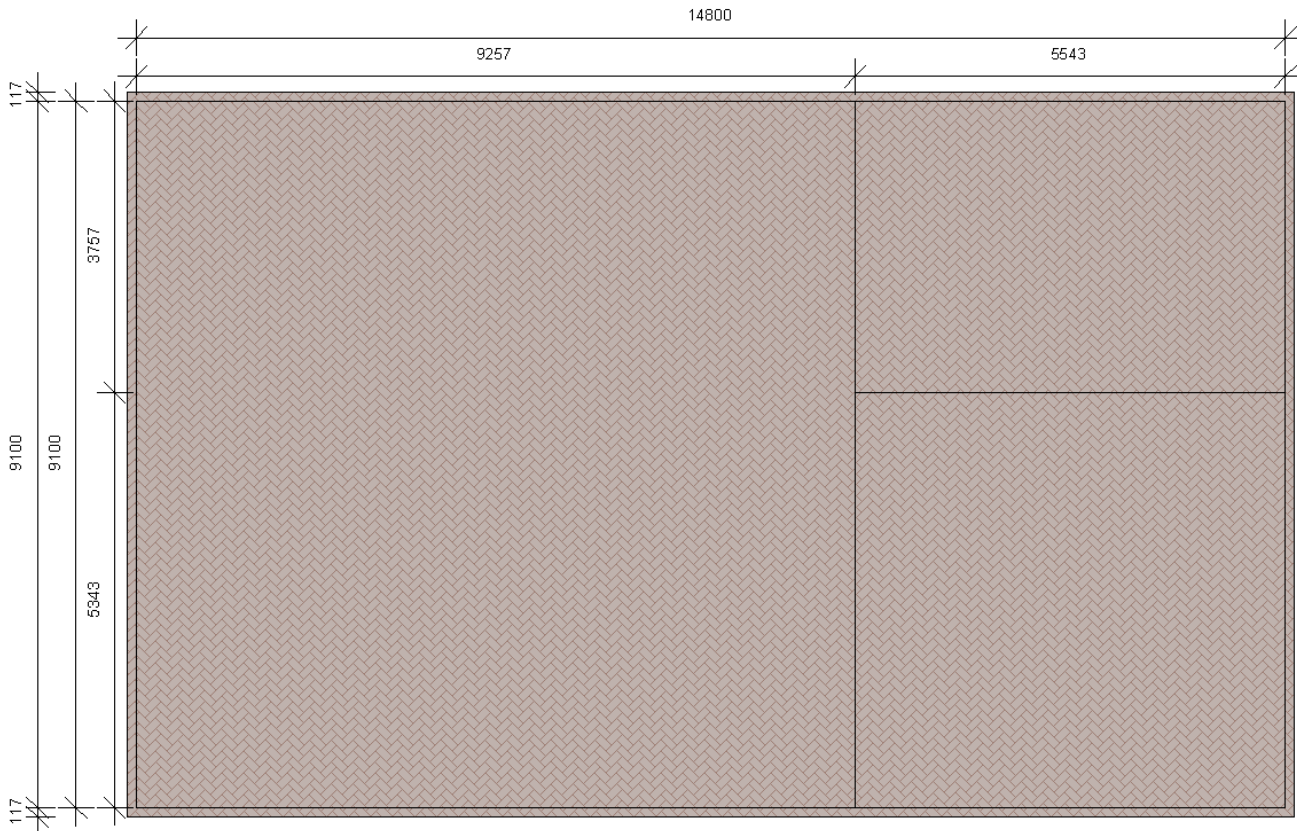

- Floor panels will be cantilevered or offset from the selected support elements by the values input in **Panel Settings - Cantilevered Offsets from Supports**

Panel Settings

Cantilever Offsets from Supports

Unassigned **Structural Wall** Structural Framing Grid

Default Side Cantilevers

Left

Right

Default End Cantilevers

Start

End

Global Shared Parameters

Panel Width

Panel Length

Floor Types

Precast Floor

Thickness 150

Hole Types

Insert Holes

Cast in Place Floor

Thickness 150

Offset From Level

Floor Supports

Add Multi-type Supports

Add Supports

Add Inner Support

Add Two Inner Support

Add Trimmed Corner Supports

Show Support Elements

Update Floor Supports

Delete All Floor Supports

Delete Selected Floor Supports

Options in the **Floor Supports** menu.

- **Add Multi-type Supports** - allows different types of supports to be selected (i.e. walls/beams/grids/structural framing)
- **Add Supports** - allows only one type of supporting elements to be selected (i.e. walls)
- **Add Inner Support / Add Two Inner Support** - allows for supports to be selected at the inside of the floor perimeter
- **Add Trimmed Corner Supports** - allows you to form a corner support by selecting two corner elements

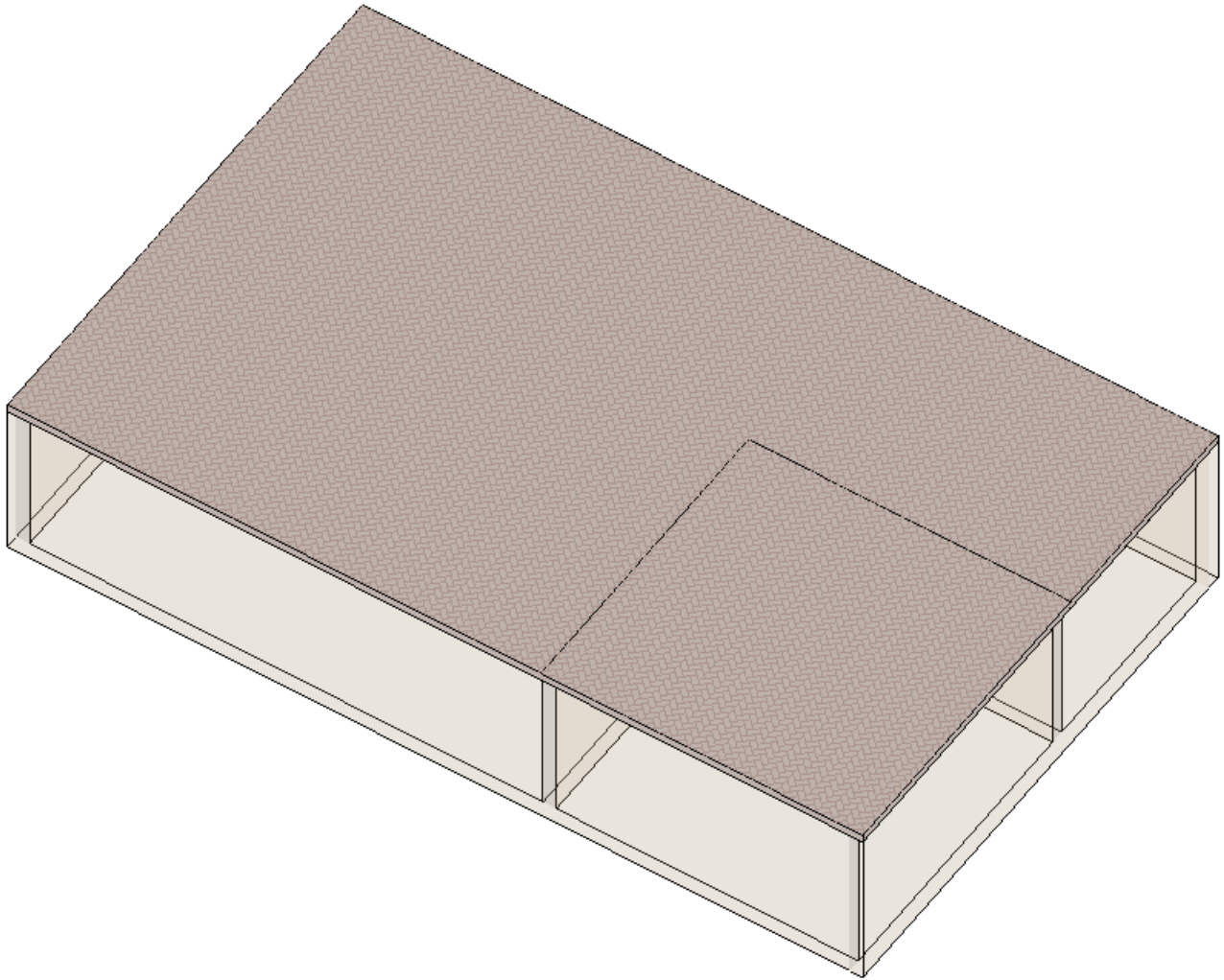

- **Show Support Elements** - allows you to see which elements were selected as supporting

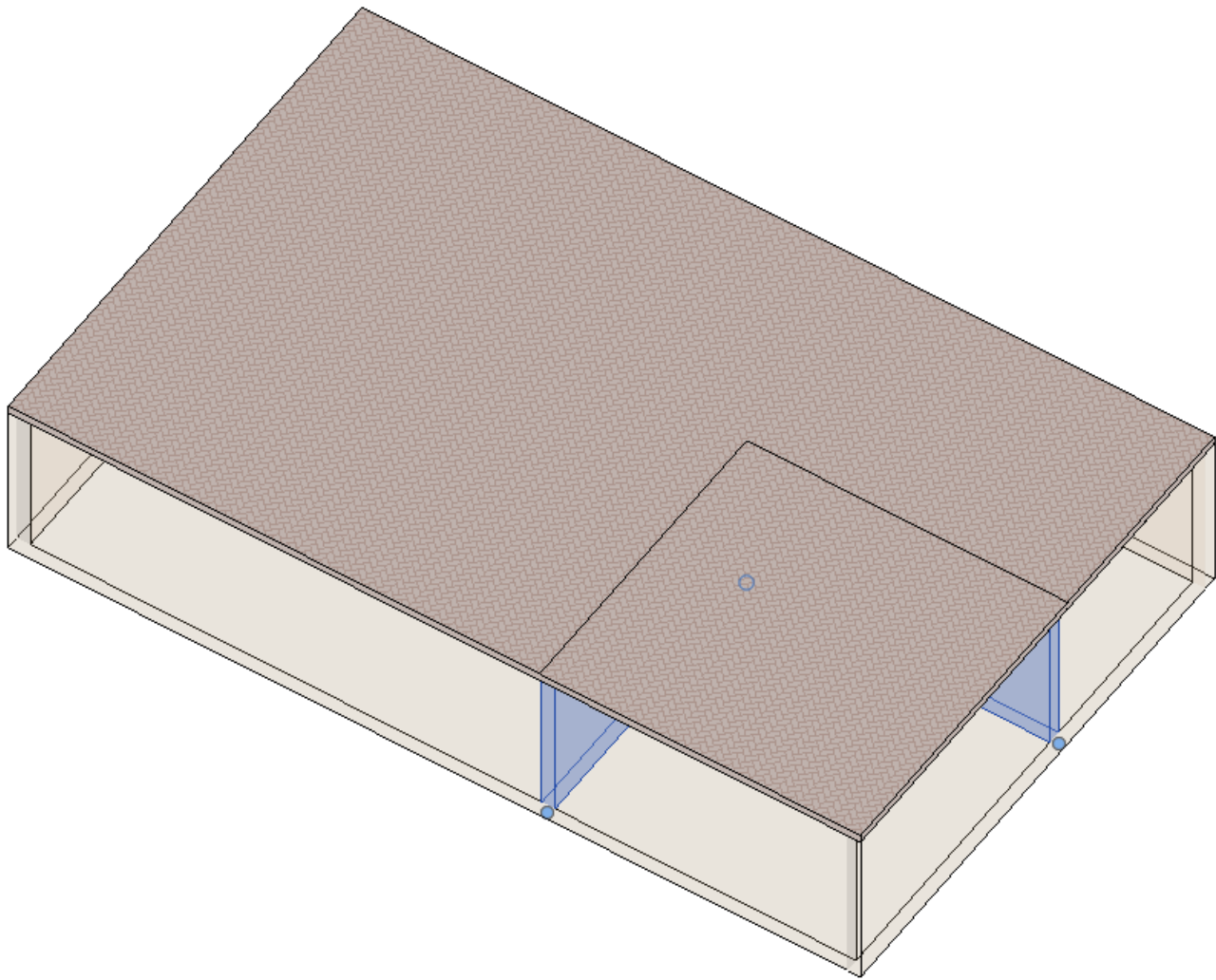

- **Update Floor Supports** - allows you to update floor support division (i.e. split lines) if support layout has changed
- **Delete All Floor Supports** - deletes all support elements and split lines which were generated with **Floor Supports** function. All support lines added manually (using Revit functionality) will remain.
- **Delete Selected Floor Supports** - deletes only the selected support and support line. It will update remaining supports according to the changed layout.