

Column Link

Modified on: Fri, 4 Sep, 2020 at 11:46 AM

This command links Rebar Configuration with the selected Structural Column Type. Choose which configuration should be used on each Type. Only after linking configuration to column Type, you can use the Create Rebar command.

1. Create Rebar Configuration.
2. Select Structural Column element in the model and click **Column Link**.

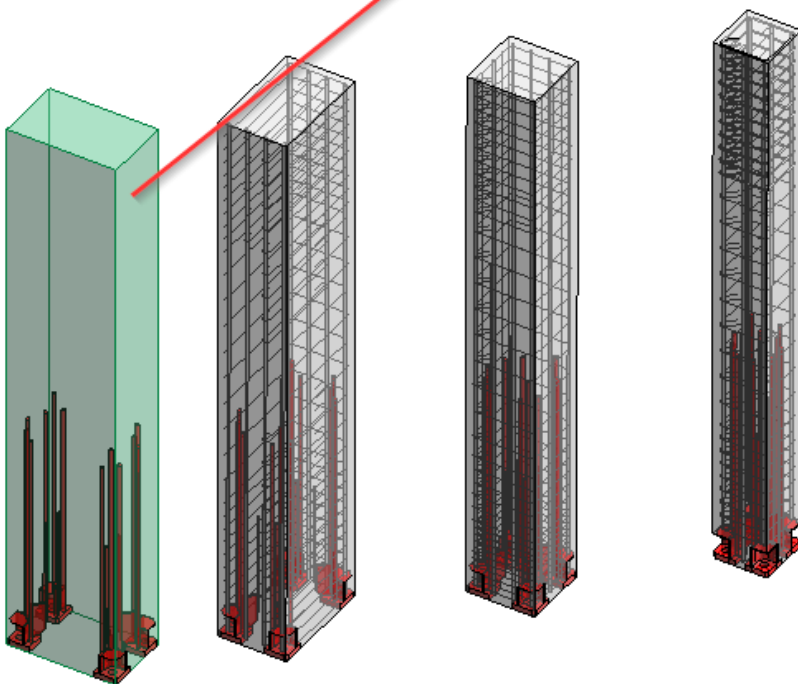
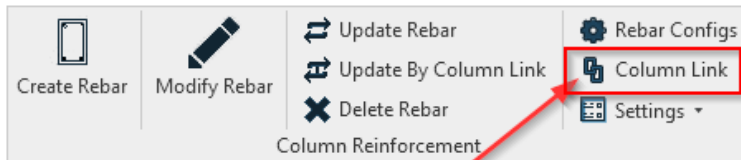

3. In the following dialog window, assign configuration for each Type which should be reinforced.

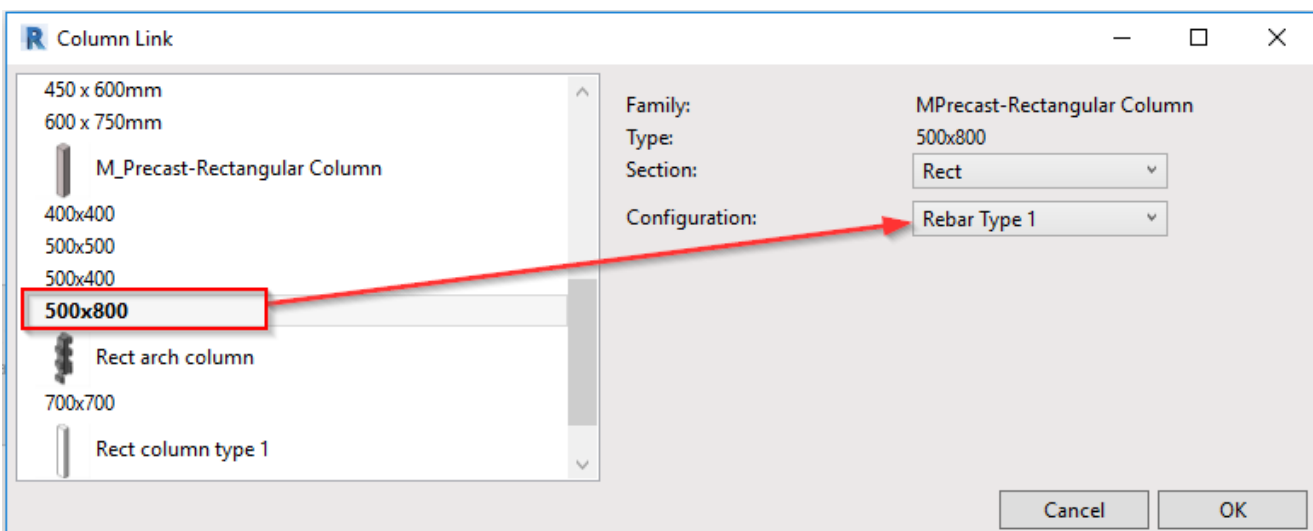

Now you can use the **Create Rebar** command for this Structural Column Type, which already has configurations assigned through the Column Link.