

# FRAMING CONFIGURATION – Opening Framing – General

Modified on: Sun, 1 Sep, 2019 at 9:15 PM

**Framing Configuration** may be found in two locations:

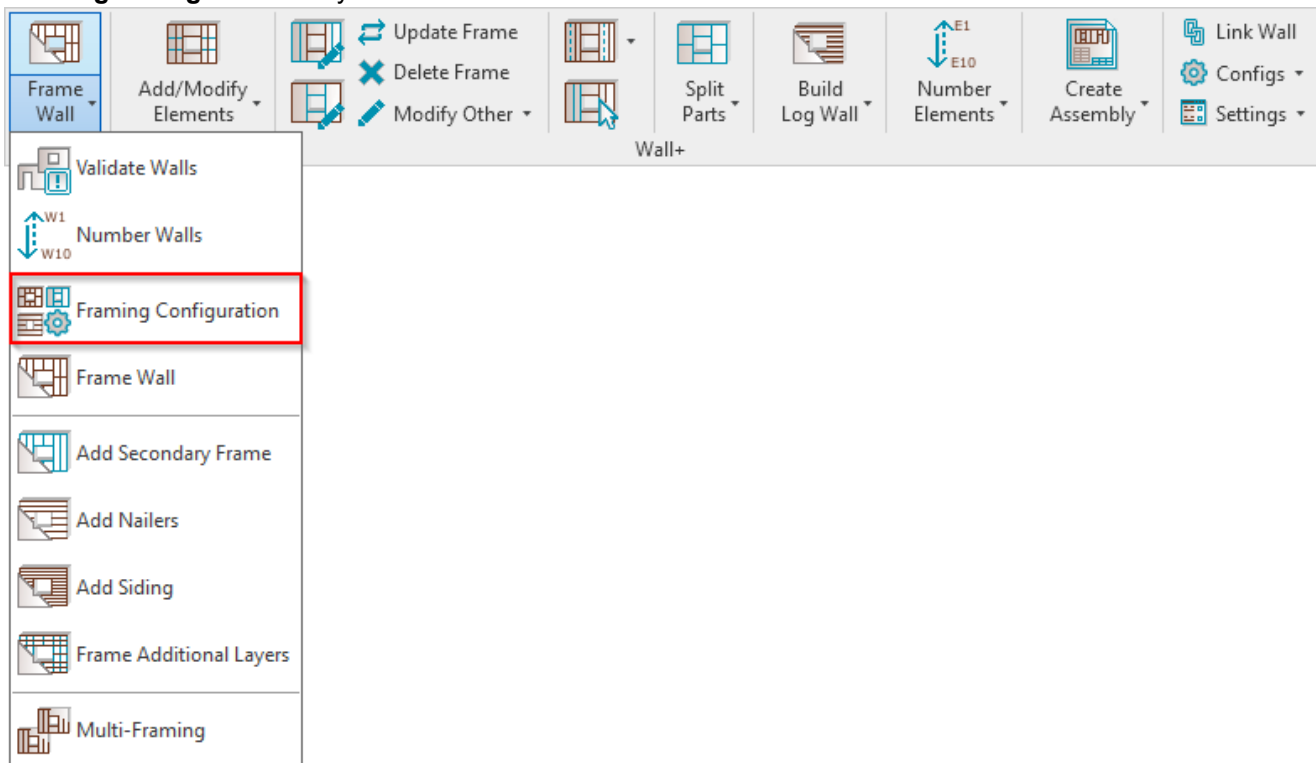

OR:

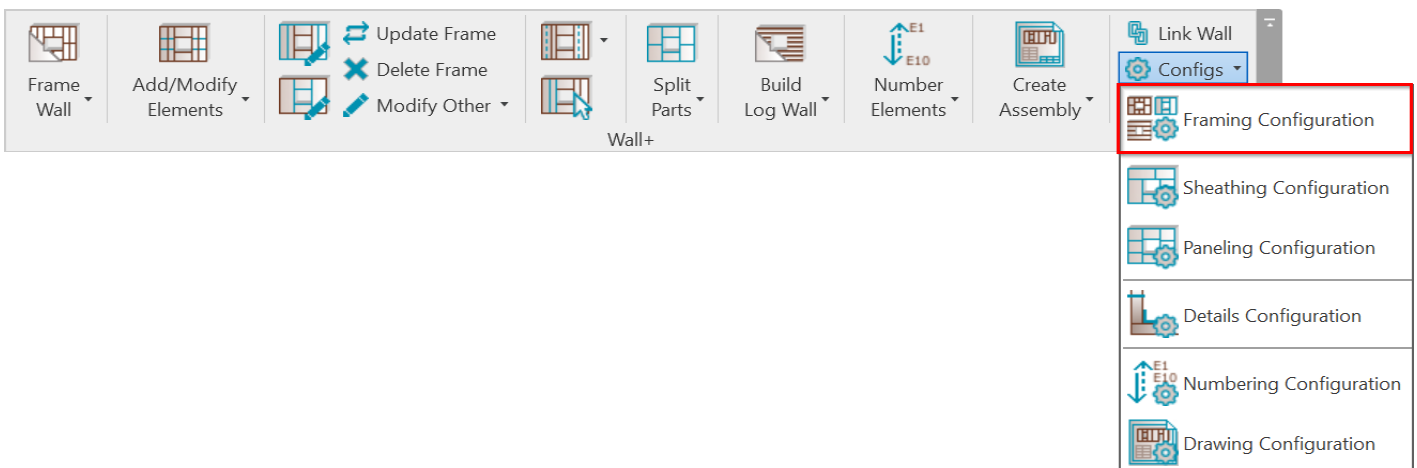

## Opening Framing

Window Framing Door Framing Opening Framing Window - Window Join Framing Window - Door Join Framing

Edit Configurations

Non-structural Walls. Width of Openings:

From	To	Configuration	Preassembled	Opening Element Preassembled
0	1500	M_Window Non-bearing Framing	<input type="checkbox"/>	<input type="checkbox"/>
1500	10000	M_Window Non-bearing Framing 1501	<input type="checkbox"/>	<input type="checkbox"/>

Edit Configurations

Structural Walls. Width of Openings:

From	To	Configuration	Preassembled	Opening Element Preassembled
0	1000	M_Window Bearing Framing	<input type="checkbox"/>	<input type="checkbox"/>
1000	1500	M_Window Bearing Framing 1001	<input type="checkbox"/>	<input type="checkbox"/>
1500	10000	M_Window Bearing Framing 1501	<input type="checkbox"/>	<input type="checkbox"/>

Settings for framing **Windows**, **Doors**, and other **Openings**.

Settings for **Window – Window Join Framing** and **Window – Door Join Framing**.

Window, Door, or Opening settings are saved under separate names and can be adjusted for different opening sizes (From – To).

Also, the software will recognize if the opening is inserted into a structural (bearing) or non-structural wall.

## Window Framing

Window Framing Door Framing Opening Framing Window - Window Join Framing Window - Door Join Framing

Edit Configurations

Non-structural Walls. Width of Openings:

From	To	Configuration	Preassembled	Opening Element Preassembled
0	1500	M_Window Non-bearing Framing	<input type="checkbox"/>	<input type="checkbox"/>
1500	10000	M_Window Non-bearing Framing 1501	<input type="checkbox"/>	<input type="checkbox"/>

Edit Configurations

Structural Walls. Width of Openings:

From	To	Configuration	Preassembled	Opening Element Preassembled
0	1000	M_Window Bearing Framing	<input type="checkbox"/>	<input type="checkbox"/>
1000	1500	M_Window Bearing Framing 1001	<input type="checkbox"/>	<input type="checkbox"/>
1500	10000	M_Window Bearing Framing 1501	<input type="checkbox"/>	<input type="checkbox"/>

**Window Framing** – settings for framing single windows.

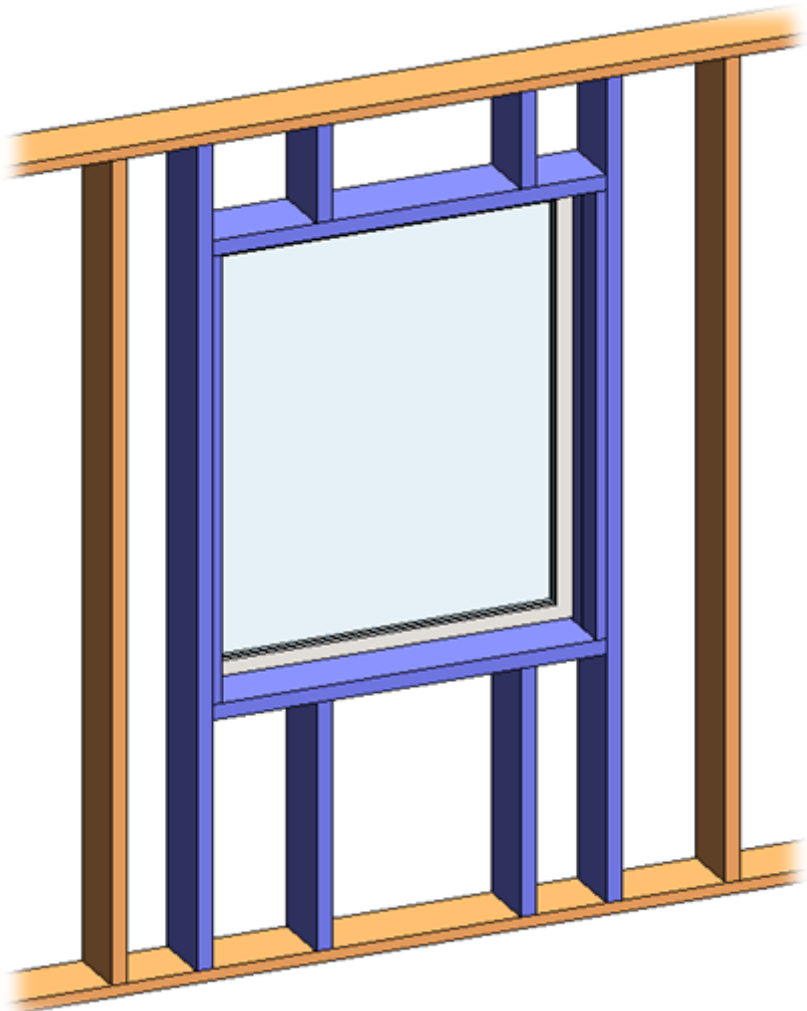

Door Framing

Common Settings

Wall Framing

Opening Framing

L Connection

End Connection

Window Framing

**Door Framing**

Opening Framing

Window - Window Join Framing

Window - Door Join Framing

Edit Configurations

Non-structural Walls. Width of Openings:

From	To	Configuration	Preamsembled	Opening Element Preamsembled
0	10000	M_Door Non-bearing Framing	<input type="checkbox"/>	<input type="checkbox"/>

Edit Configurations

Structural Walls. Width of Openings:

From	To	Configuration	Preamsembled	Opening Element Preamsembled
0	10000	M_Door Bearing Framing	<input type="checkbox"/>	<input type="checkbox"/>

Door Framing – settings for framing single doors.

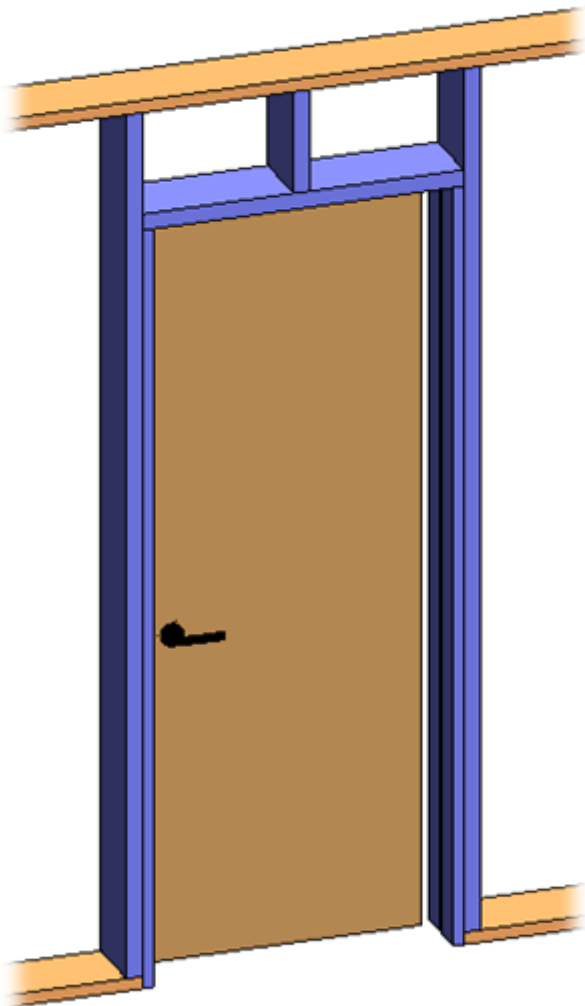

Opening Framing

Common Settings

Wall Framing

Opening Framing

L Connection

End Connection

Window Framing

Door Framing

Opening Framing

Window - Window Join Framing

Window - Door Join Framing

Edit Configurations

Non-structural Walls. Width of Openings:

From	To	Configuration	Preassembled	Opening Element Preassembled
0	10000	M_Opening Non-bearing Framing	<input type="checkbox"/>	<input type="checkbox"/>

Edit Configurations



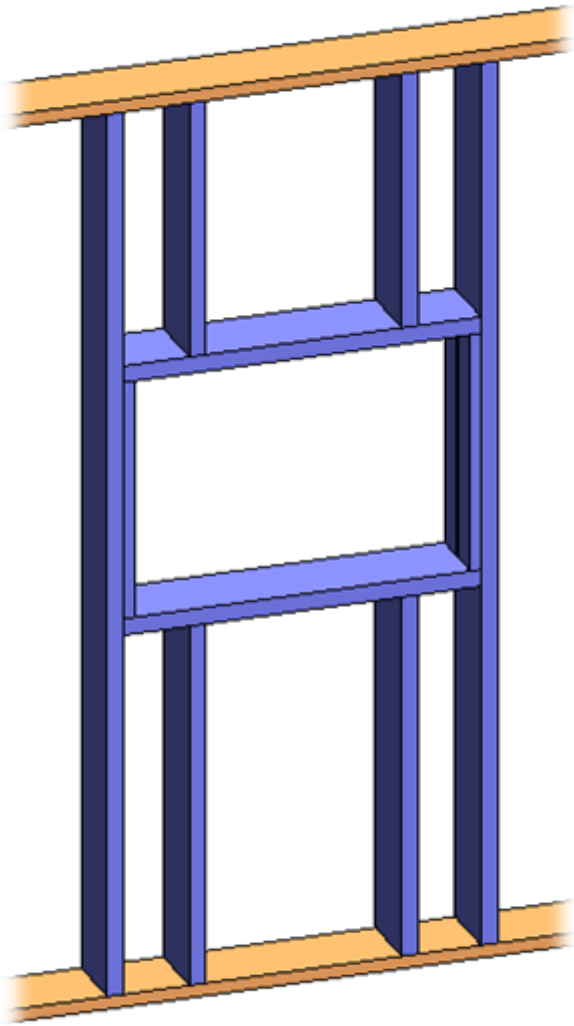

Structural Walls. Width of Openings:

From	To	Configuration	Preassembled	Opening Element Preassembled
0	10000	M_Opening Bearing Framing	<input type="checkbox"/>	<input type="checkbox"/>

**Opening Framing** – settings for framing single openings which are mostly used for Ducts, Pipes. or other MEP elements.



## Window – Window Join Framing

-  Common Settings
-  Wall Framing
-  Opening Framing
-  L Connection
-  End Connection



Window Framing

Door Framing

Opening Framing



Window - Window Join Framing

Window - Door Join Framing



Edit Configurations

Non-structural Walls. Width of Join:

From	To	Configuration	Preassembled	Opening Element Preassembled
0	150	M_Window-Window Non-bearing Framing	<input type="checkbox"/>	<input type="checkbox"/>



Edit Configurations

Structural Walls. Width of Join:

From	To	Configuration	Preassembled	Opening Element Preassembled
0	150	M_Window-Window Bearing Framing	<input type="checkbox"/>	<input type="checkbox"/>

**Window – Window Join Framing** – settings for framing joined windows. Window – window join settings are saved under a separate name and they can be adjusted for different join sizes (From – To).

<https://agacad.freshdesk.com/support/solutions/articles/44001251363-framing-configuration-opening-framing-general>

5/9

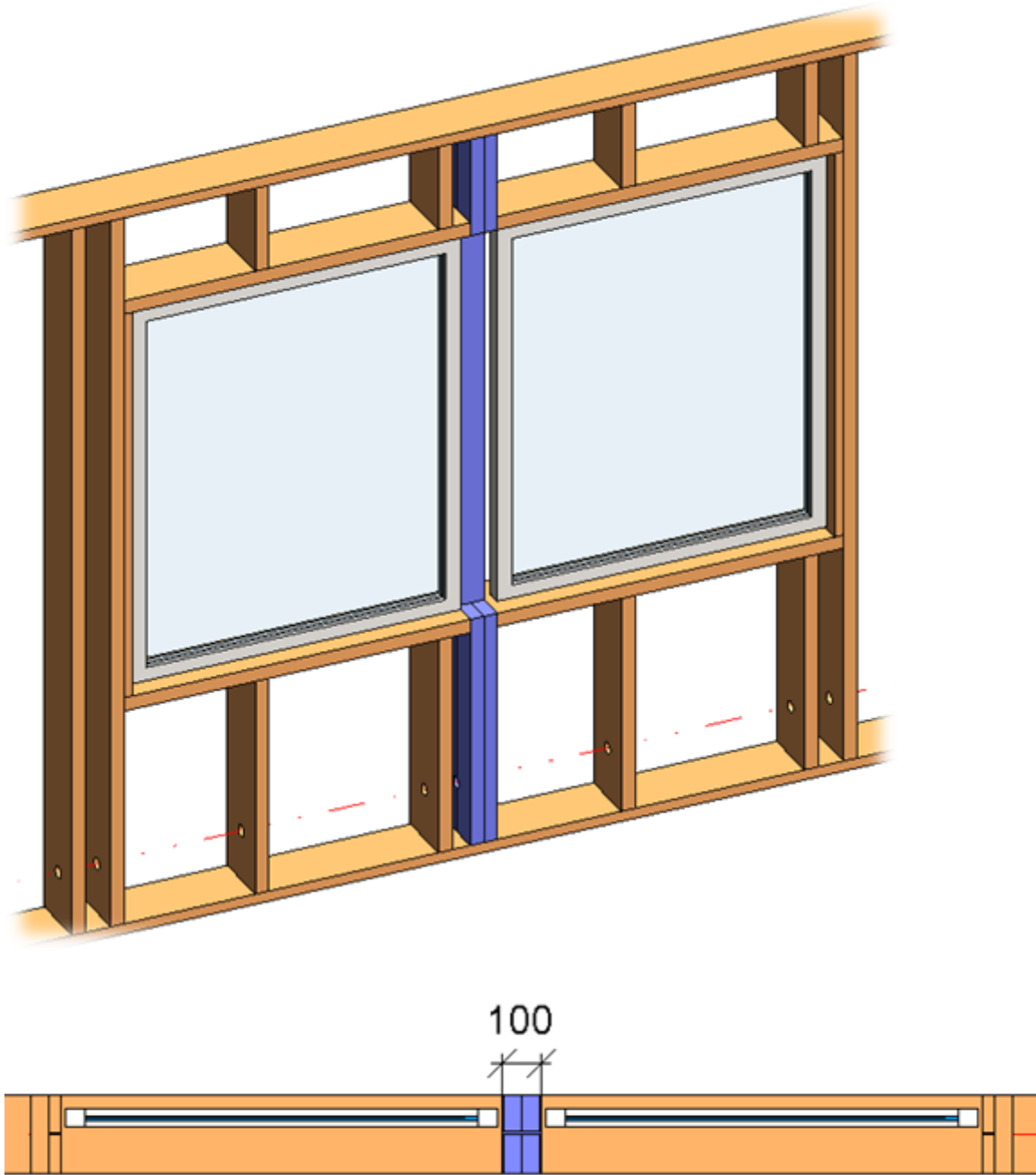

Window – Door Join Framing

Common Settings

Wall Framing

Opening Framing

L Connection

End Connection

Window Framing

Door Framing

Opening Framing

Window - Window Join Framing

Window - Door Join Framing

Edit Configurations

Non-structural Walls. Width of Join:

From	To	Configuration	Preassembled	Opening Element Preassembled
0	180	M_Window-Door Non-bearing Framing	<input type="checkbox"/>	<input type="checkbox"/>

Edit Configurations

Structural Walls. Width of Join:

From	To	Configuration	Preassembled	Opening Element Preassembled
0	180	M_Window-Door Bearing Framing	<input type="checkbox"/>	<input type="checkbox"/>

**Window – Door Join Framing** – settings for framing joined window and door. Window – door join settings are saved under a separate name and they can be adjusted for different join sizes (From – To).

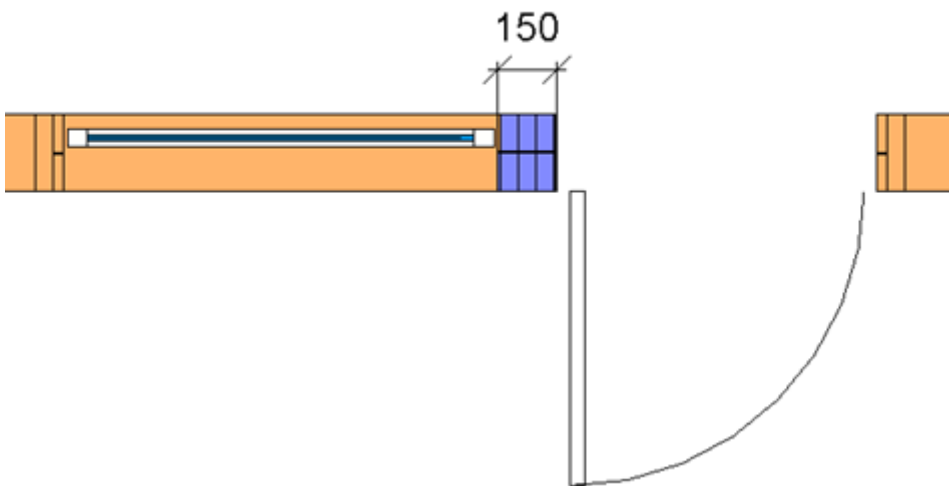
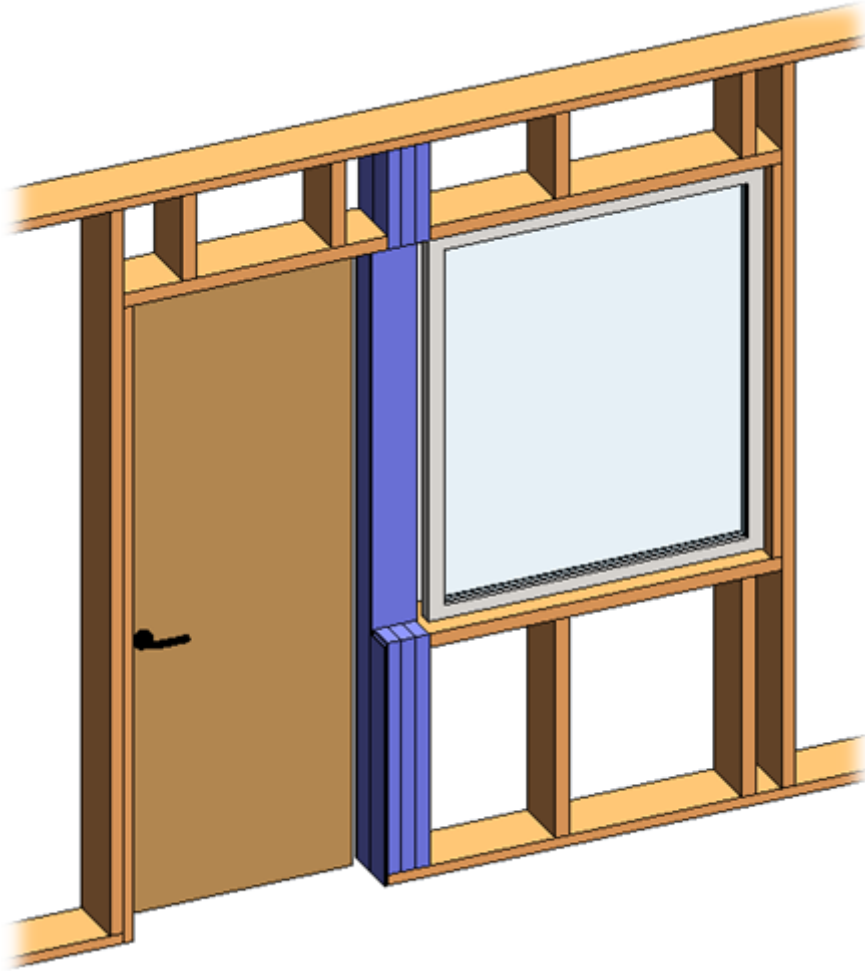

## Preassembling

**Preassembled** – fills in information for framing elements (like kings, trimmers, sills, etc.) from the selected configuration. The configuration can be later scheduled and separately displayed in shop drawings.

**Opening Element Preassembled** – fills in information for window, door, or other opening, which can later be scheduled and separately displayed in shop drawings.

Window Framing Door Framing Opening Framing Window - Window Join Framing Window - Door Join Framing

Edit Configurations

Non-structural Walls. Width of Openings:

From	To	Configuration	Preassembled	Opening Element Preassembled
0	1500	M_Window Non-bearing Framing	<input checked="" type="checkbox"/>	<input checked="" type="checkbox"/>
1500	10000	M_Window Non-bearing Framing 1501	<input type="checkbox"/>	<input type="checkbox"/>

Edit Configurations

Structural Walls. Width of Openings:

From	To	Configuration	Preassembled	Opening Element Preassembled
0	1000	M_Window Bearing Framing	<input type="checkbox"/>	<input type="checkbox"/>
1000	1500	M_Window Bearing Framing 1001	<input type="checkbox"/>	<input type="checkbox"/>
1500	10000	M_Window Bearing Framing 1501	<input type="checkbox"/>	<input type="checkbox"/>

Fills in information for these parameters:

### FM Module Type

For Windows, Doors, and Openings – writes opening type (Window, Door, Opening, JoinedOpening).

For Connections – writes join configuration name.

**FM Module Mark** – writes **FM Module Type** + **Mark** (from Wall) + **Mark** (from Window, Door or Opening) + unique number.

**FM Module Preassembled** – writes Yes/No if element is (or is not) included in the preassembly.

### Example:

King is included in the preassembly so **FM Module Type** parameter has Window value, because this King belongs to the window, **FM Module Mark** parameter contains **FM Module Type** parameter value (Window) + current wall **Mark** value (can be seen near **FM HostMemberSortMark**) + current window **Mark** + unique number.



Properties



M\_WF Stud  
LMBR 45x200

Structural Framing (Other) (1) Edit Type

Framing	Wall
Framing Member Description	King Post
FM SortMark	
Framing Layer	Frame
Framing Member Mark	KP
FM HostMemberSortMark	W-1
Framing Member Mass	
Framing Member Volume	0.034 m³
Framing Member Cut Length	3820.0
FM Module Mark	Window W-1 Wind-1 2
CNC Part Number	
CNC Part Name	
FM Module Type	Window
FM Module Preassembled	<input checked="" type="checkbox"/>
CNC Part Position	
FM Wood Grade	
FM Wall Layer	Frame
SDC	
Assembly Depth	
Assembly Length	
Assembly Height	
FM Module Number	

Phasing

[Properties help](#) Apply

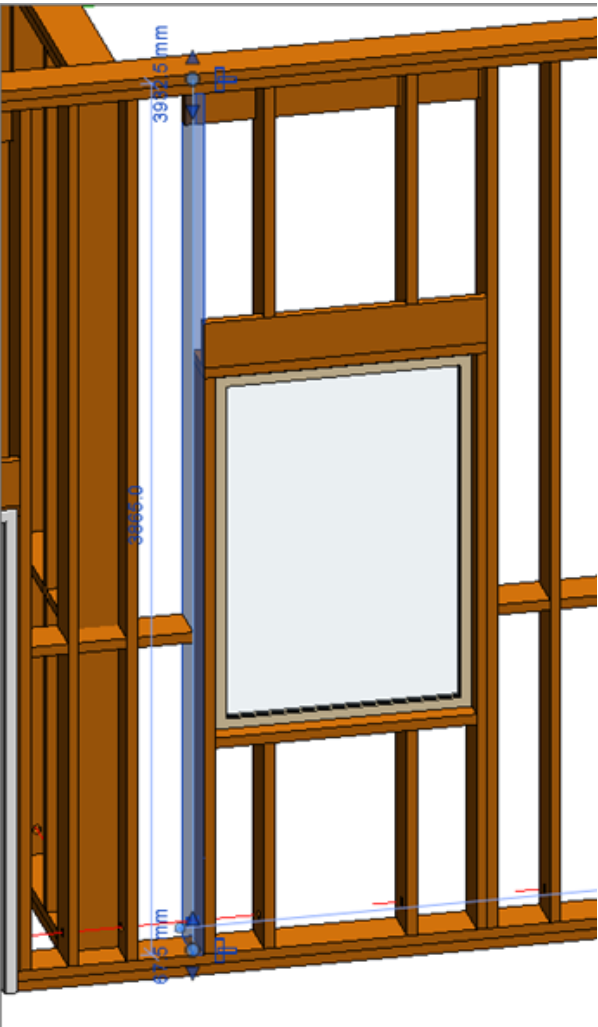

All these parameters can later be used in the schedules and view filters.