

# FRAMING CONFIGURATION – L Connection – General

Modified on: Mon, 2 Sep, 2019 at 7:54 PM

Innovative and powerful features allow you to create multi-layer framing with complex connections.

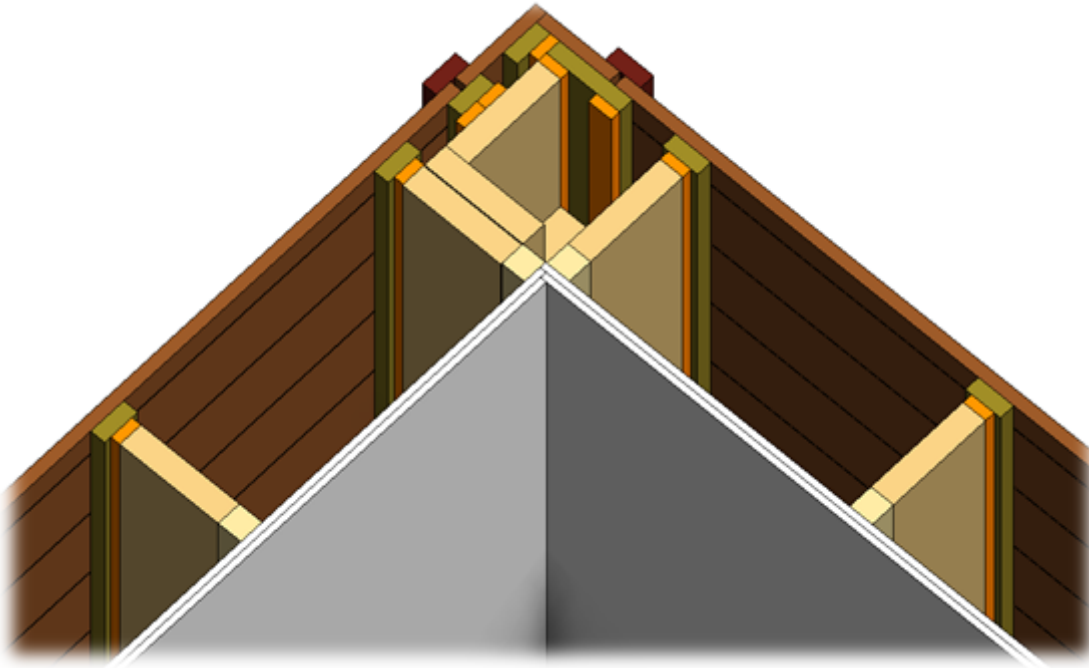

## 1. Modify wall joins using Revit Wall Joins function

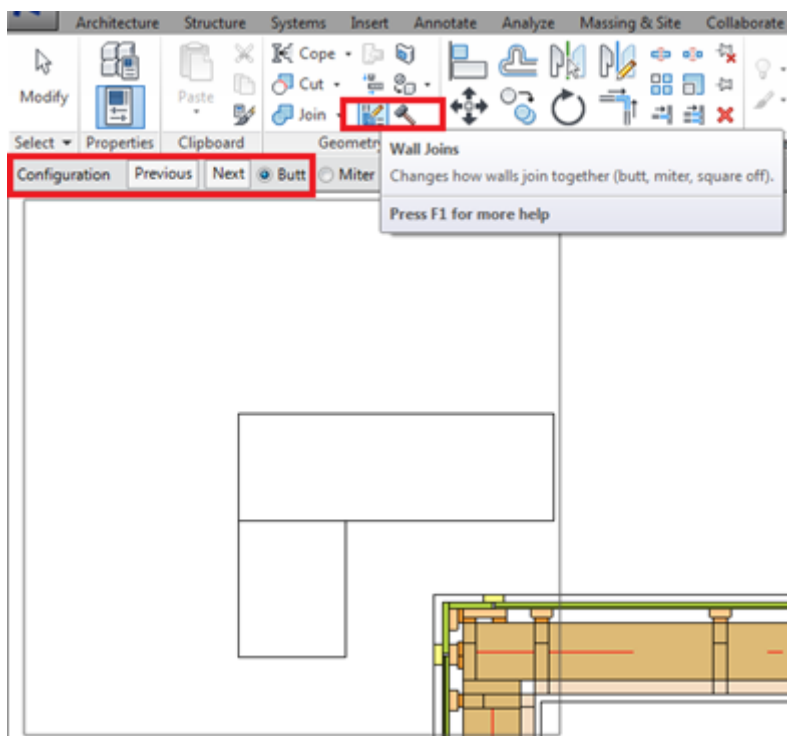

## 2. Build wall Parts and switch on its Visibility in the plan view:

The screenshot shows the 'Properties' dialog box for a 'Floor Plan' view. The 'Parts Visibility' property is highlighted with a red box and is set to 'Show Parts'. Other properties include View Scale (1 : 100), Scale Value (100), Display Model (Normal), Detail Level (Fine), Orientation (Project North), and Discipline (Architectural).

Graphics	
View Scale	1 : 100
Scale Value 1:	100
Display Model	Normal
Detail Level	Fine
<b>Parts Visibility</b>	<b>Show Parts</b>
Visibility/Graphics Overri...	Edit...
Graphic Display Options	Edit...
Orientation	Project North
Wall Join Display	Clean all wall joins
Discipline	Architectural
Show Hidden Lines	By Discipline
Color Scheme Location	Background
Color Scheme	<none>
System Color Schemes	Edit...