

ALIGN/TRIM/EXTEND – Align Elements

Modified on: Mon, 16 Nov, 2020 at 8:41 PM

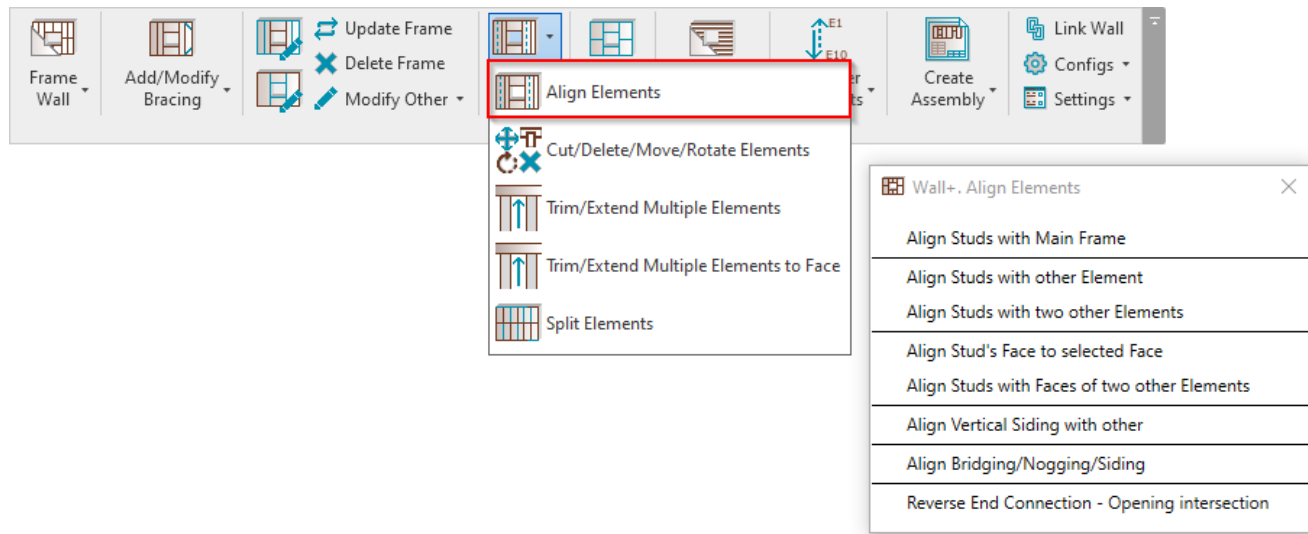

Align Elements – features for aligning studs, vertical sidings, opening cripples, bridging/noggin etc.

Align Studs with Main Frame

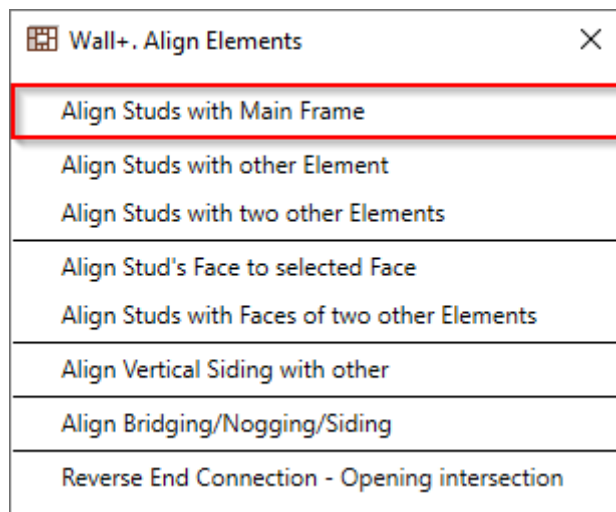

Align Studs with Main Frame – use if studs from another layer, like secondary frame or vertical nailers, have to be aligned with studs from main frame.

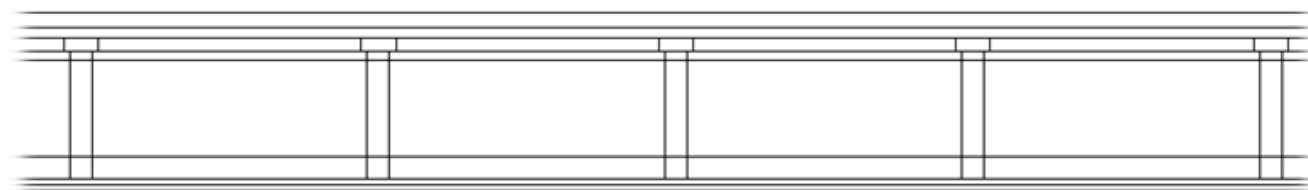

Align Studs with other Element

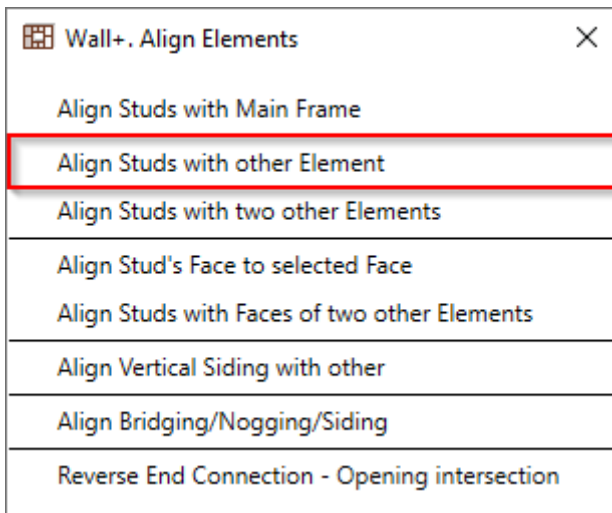

Align Studs with other Element – aligns studs with trusses, truss system grids, or studs from other frames.

Steps:

1. Run **Align Studs with other Element** → Select any Structural Framing element (e.g., truss bottom chord or element from Truss System Grid):

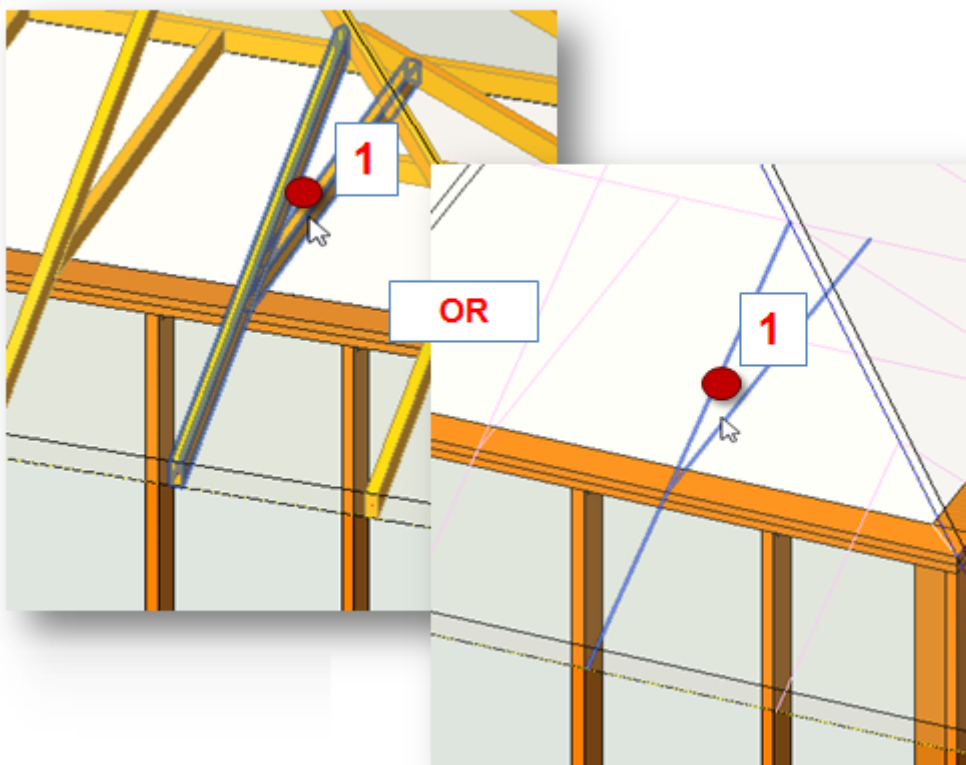

2. Select a stud from the frame that has to be aligned:

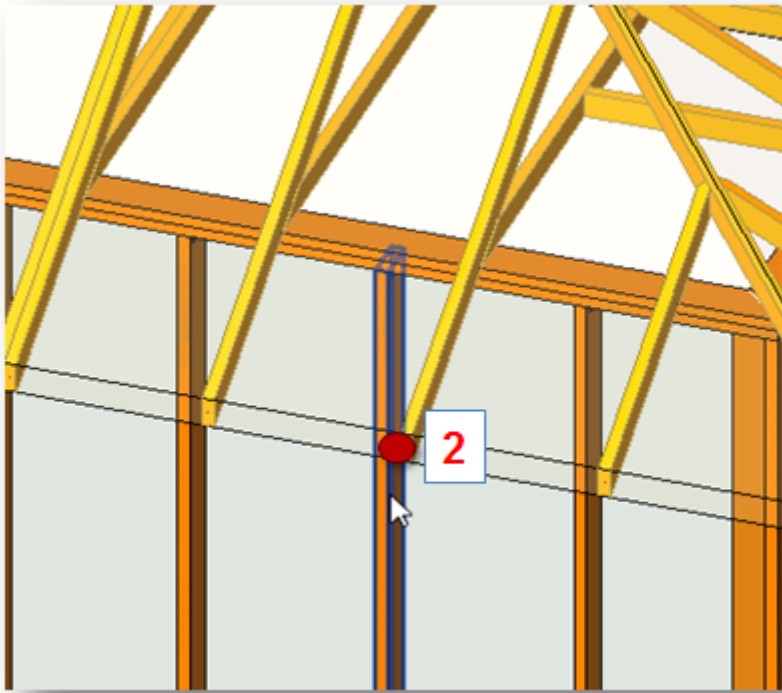

Result – all studs from the frame are aligned:

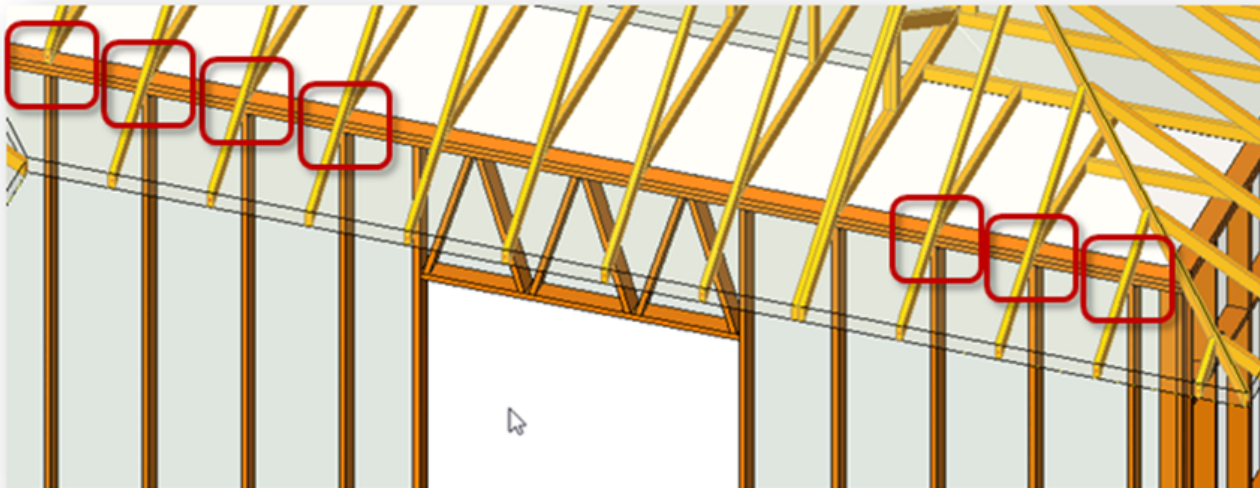

Align Studs with two other Elements

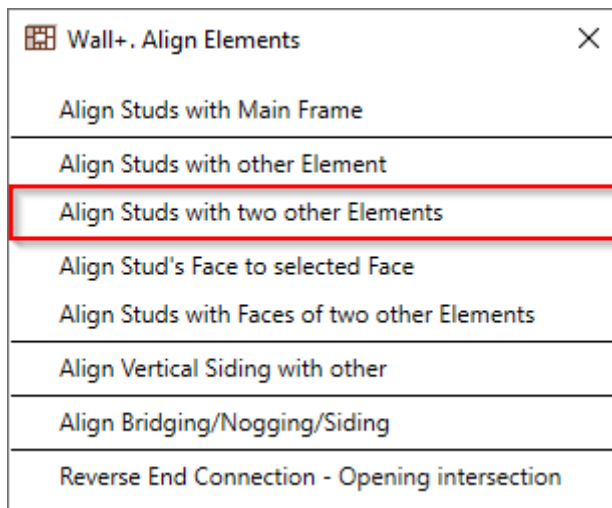

Align Studs with two other Elements – aligns studs with two selected trusses, truss system grids, or studs from other frames.

Steps:

1. Run **Align Studs with two other Elements** → Select two *Structural Framing elements* (e.g., truss top chord or two elements from Truss System Grid):

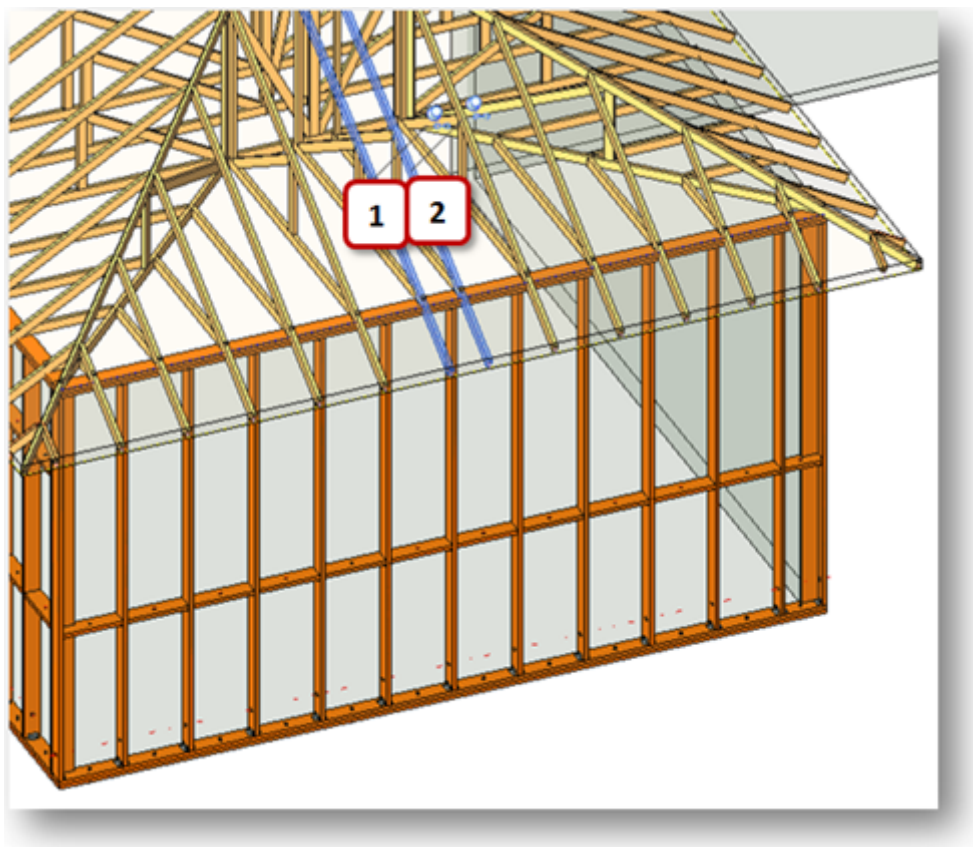

2. Select a stud that has to be aligned:

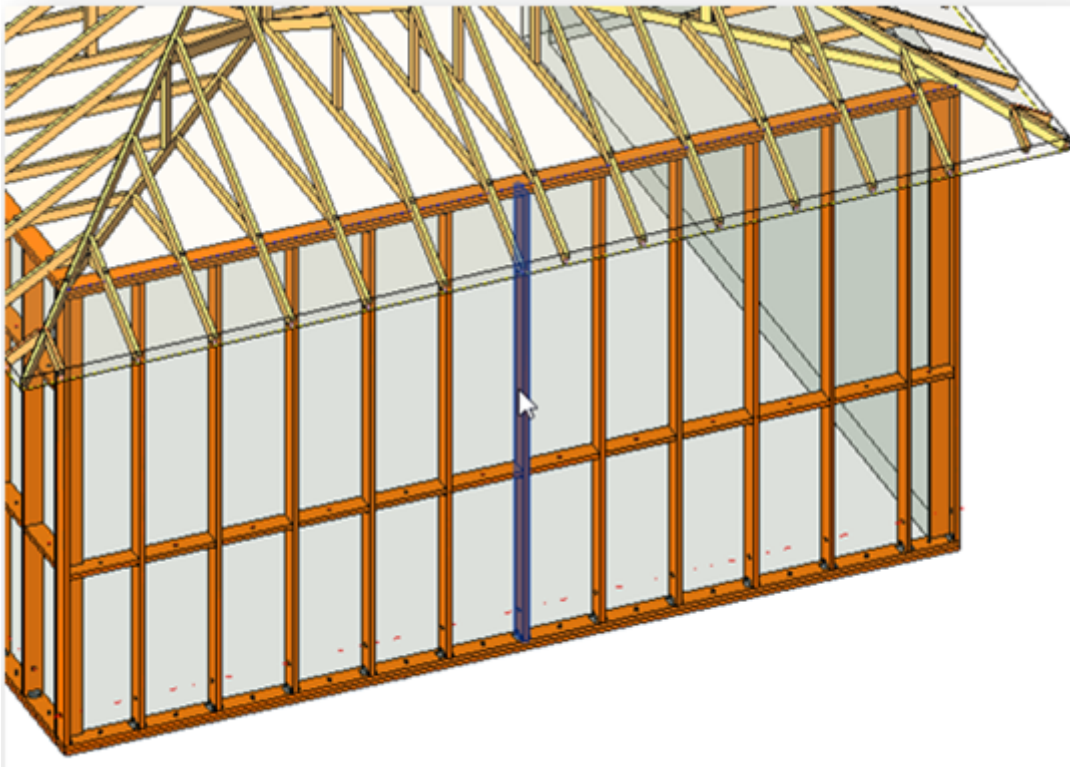

Result – all studs from the frame are aligned:

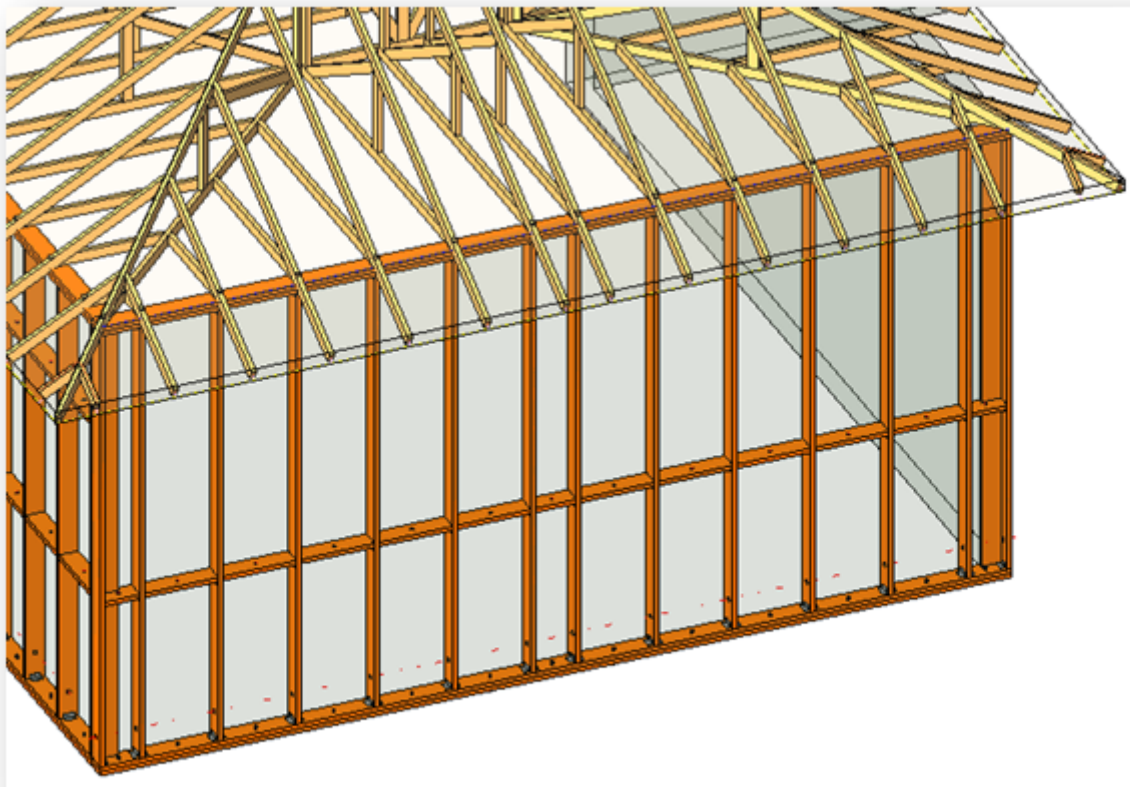

Align Stud's Face to selected Face

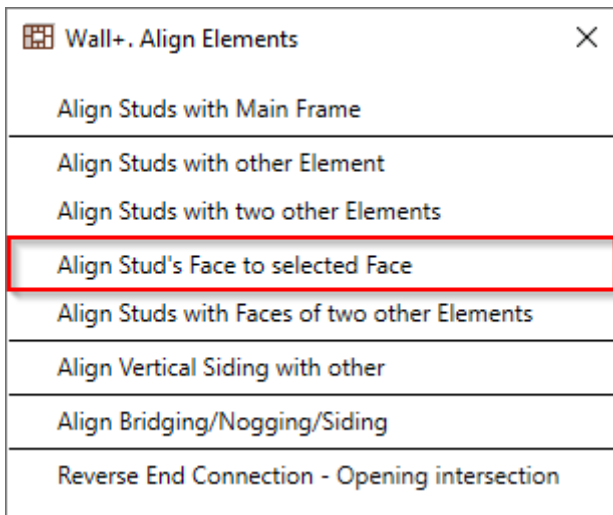

Align Stud's Face to selected Face – aligns stud's face with selected element face.

Steps:

1. Run **Align Stud's Face to selected Face** → Select face of any element;
2. Select a stud that has to be aligned:

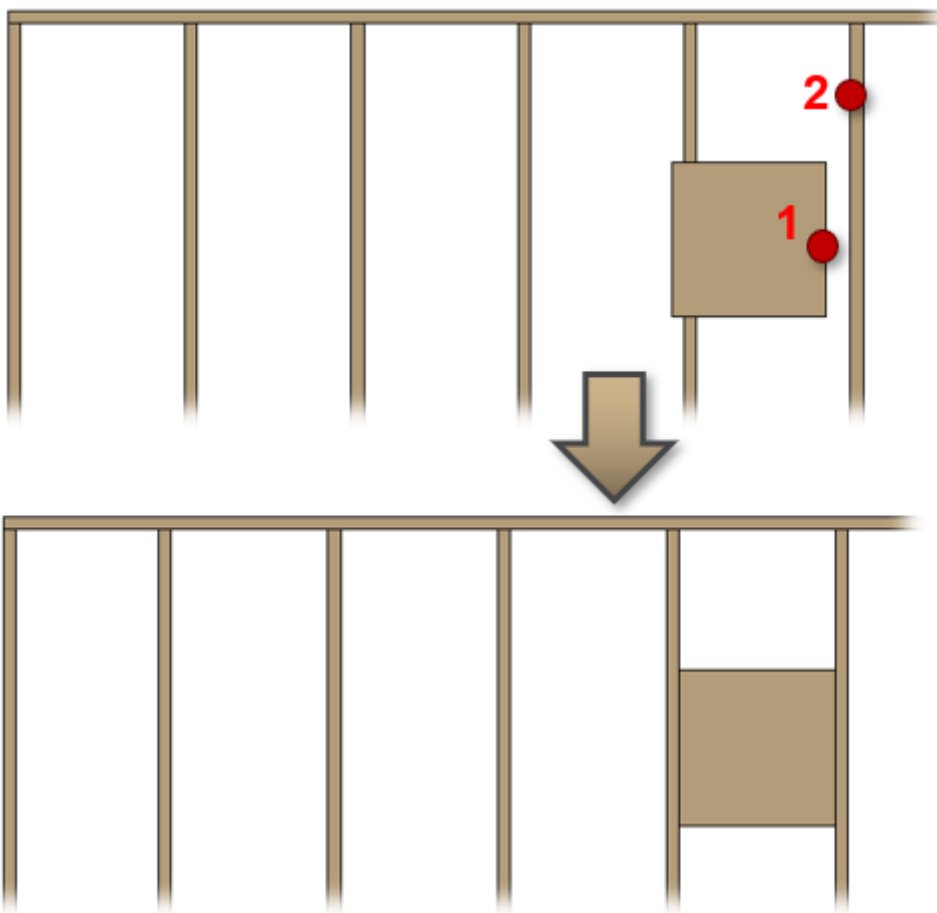

Align Studs with Faces of two other Elements

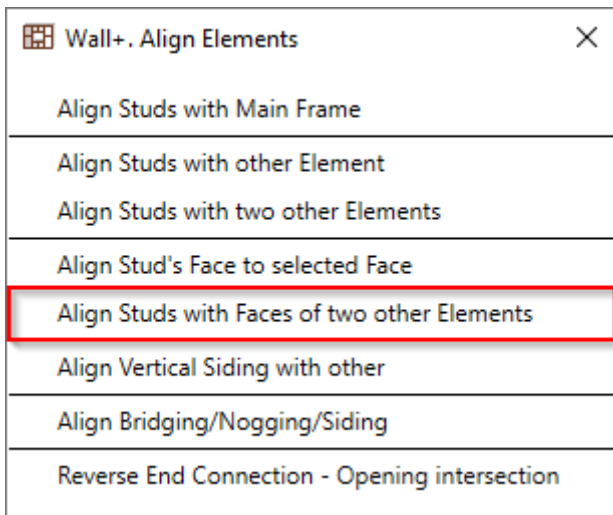

Align Studs with Faces of two other Elements – aligns studs with two selected faces from other elements.

Steps:

1. Run **Align Studs with Faces of two other Elements** → Select two faces of any element;
2. Select a stud that has to be aligned:

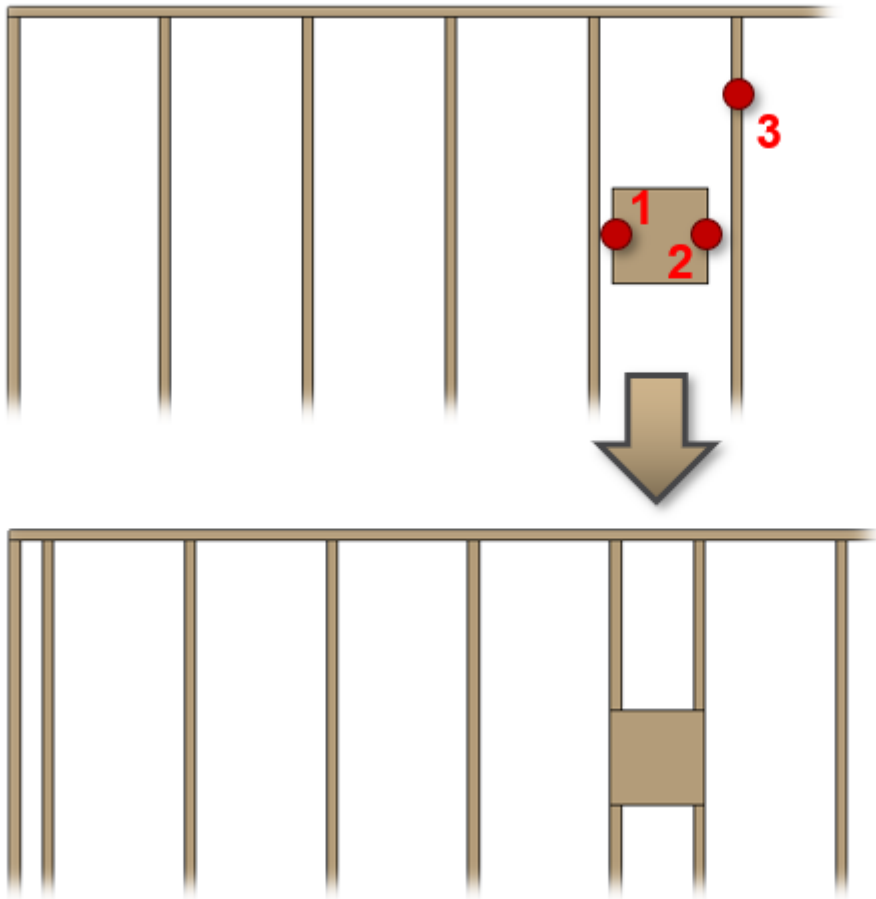

Align Vertical Siding with other

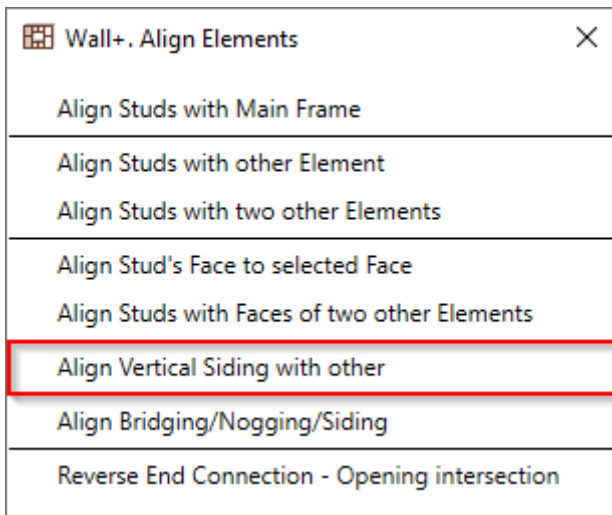

Align Vertical Siding with other – aligns vertical siding with siding in a connected wall.

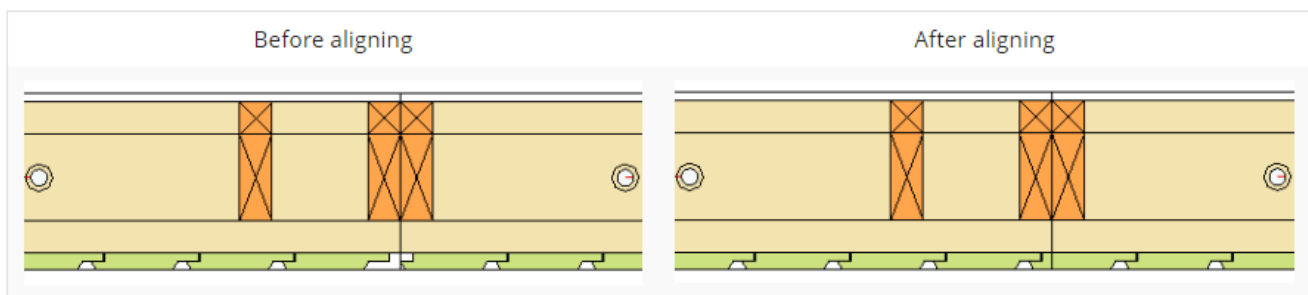

Align Opening Cripples with Studs (in older versions)

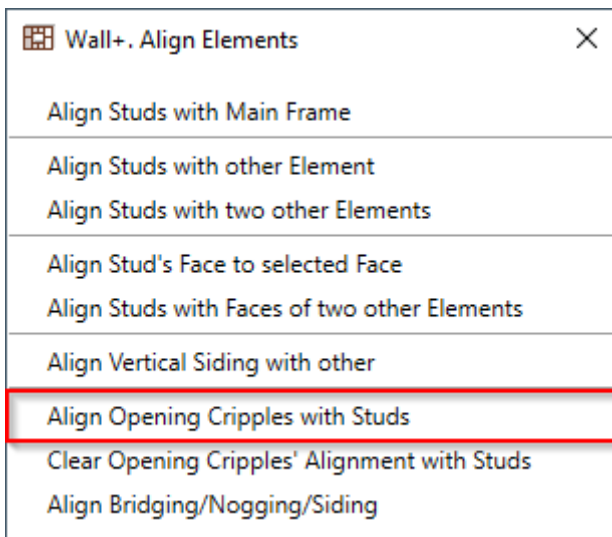

Align Opening Cripples with Studs – aligns opening cripples with trusses, truss system grids, or studs from other frames.

*Run **Align Opening Cripples with Studs** → Select any opening cripple:*

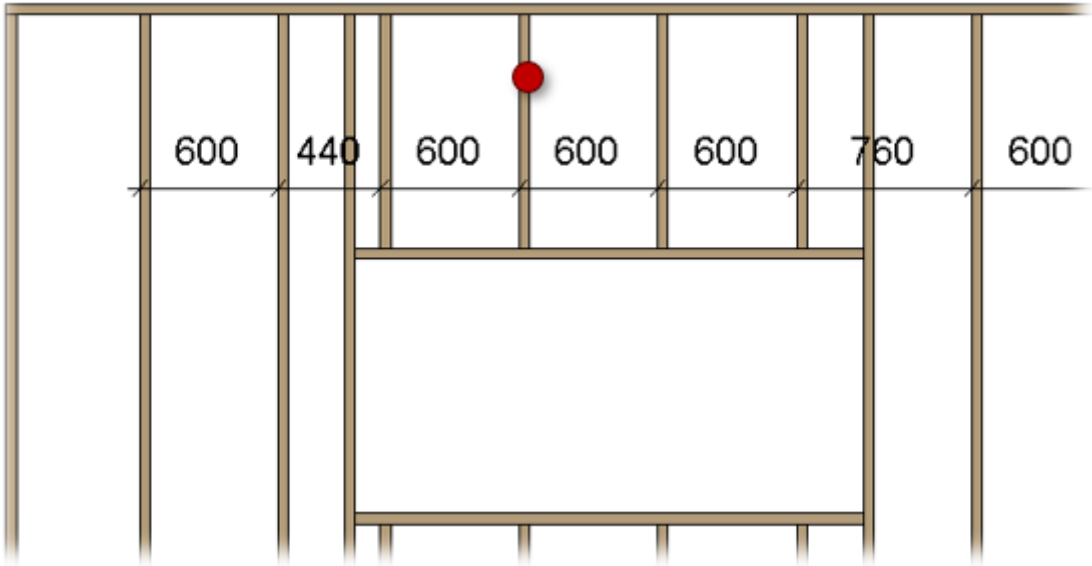

Result – all opening cripples are aligned:

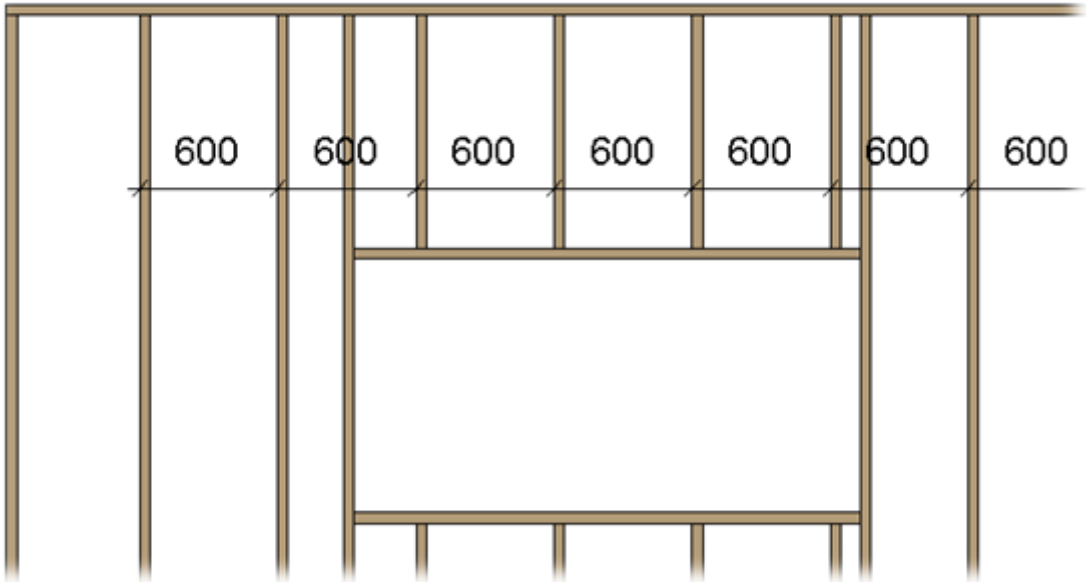

Clear Opening Cripples’ Alignment with Studs (in older versions)

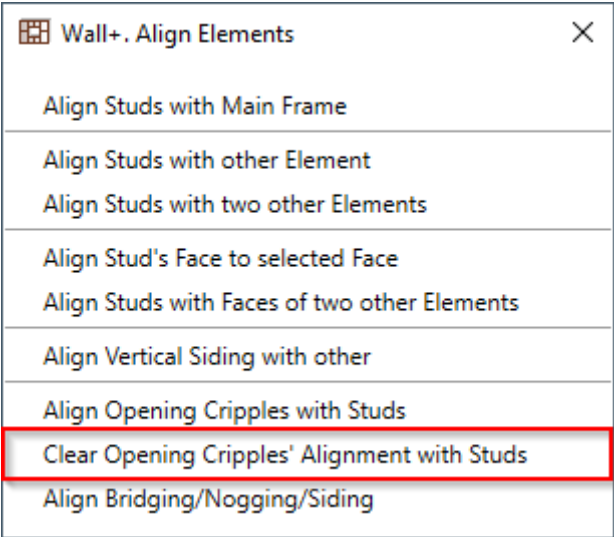

Clear Opening Cripples’ Alignment with Studs – removes alignment of cripples returning, them to default positions.

Align Bridging/Nogging/Siding

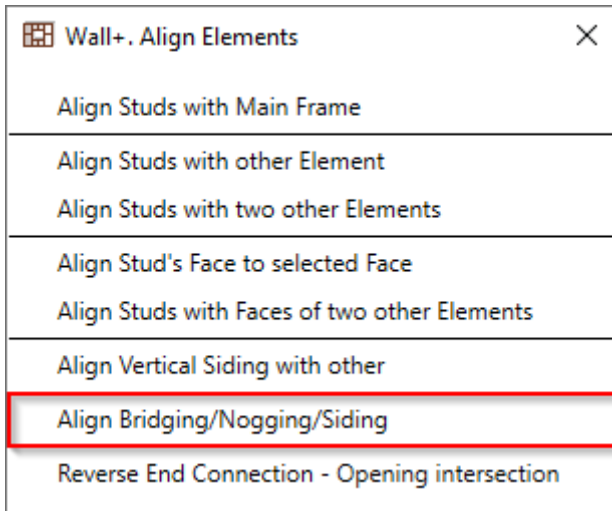

Align Bridging/Nogging/Siding – aligns bridging/noggings or sidings with other selected element.

Example: All bridgings are aligned with a bridging from other wall:

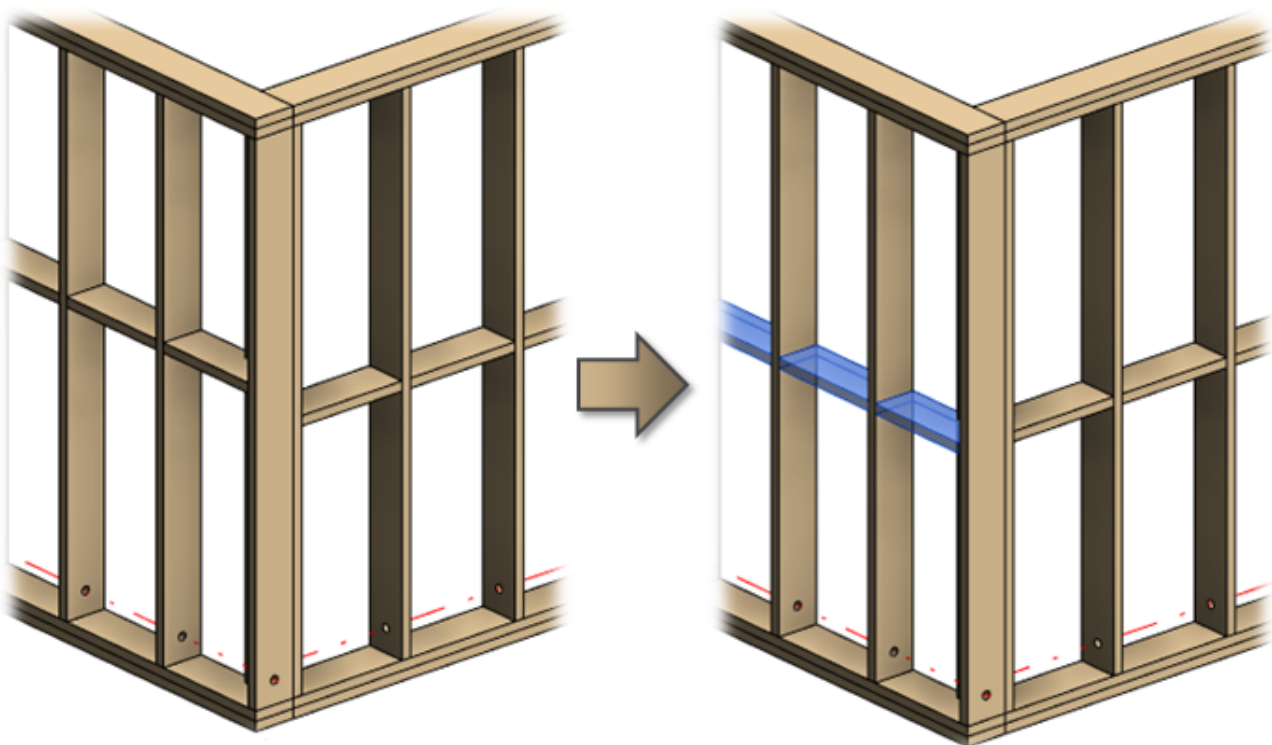

Reverse End Connection - Opening Intersection

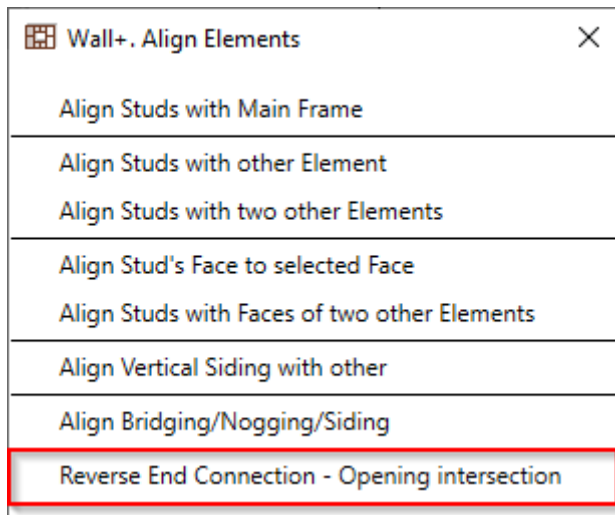

Reverse End Connection - Opening Intersection – used when opening is located in the frame end. Usually king stud stays and end stud is removed. While using this function end stud stays and openings' horizontal elements connect to end stud.

