

SHEATHING and PANELING LAYOUTS – Main Features

Modified on: Sat, 7 Sep, 2019 at 4:31 PM

Sheathing and Paneling Layouts

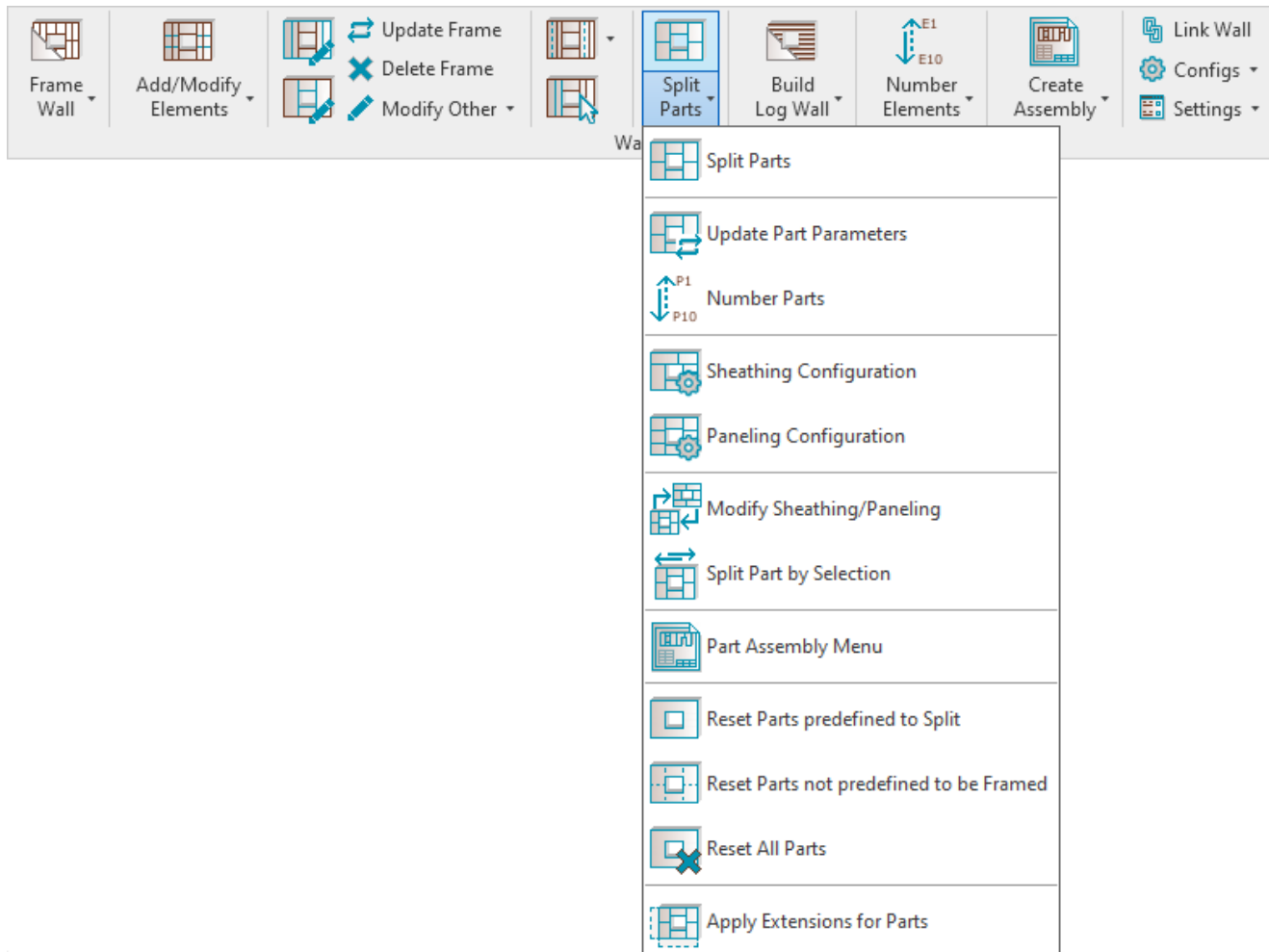

Wood Framing Wall+ automates the creation of sheathing and paneling layouts. Sheathing or paneling layouts can be generated and split by existing studs, joists, or other predefined rules.

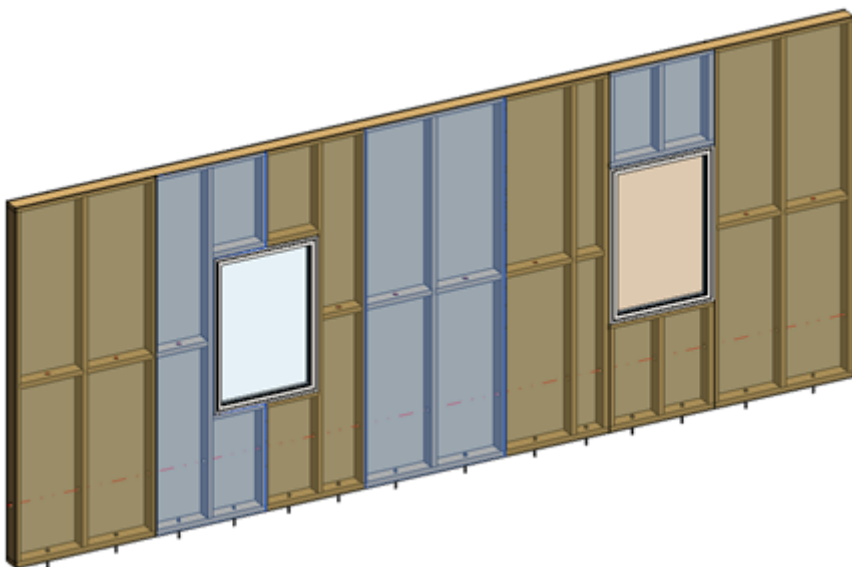

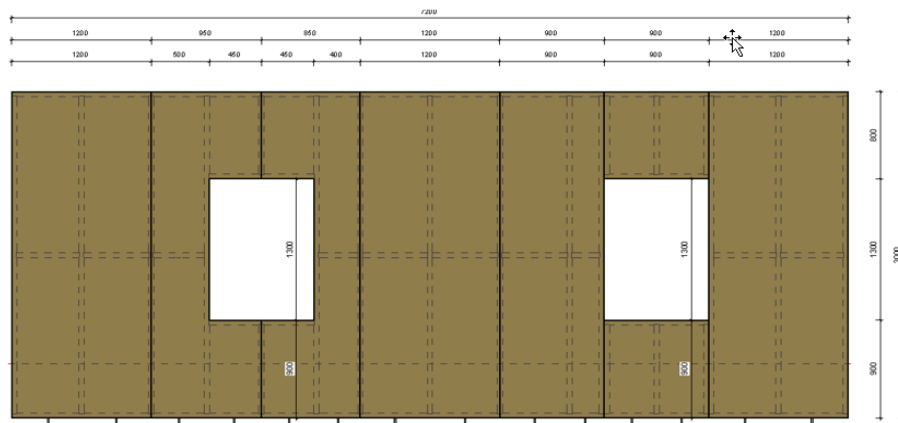

Sheathing Schedule				
FM SortMark	Thickness	Area	Count	Framing Member Mass
F4				
SH - 1	0.75	5.87 SF	2	12.64 lbm
SH - 2	0.75	3.00 SF	1	6.46 lbm
SH - 3	0.75	3.00 SF	1	6.46 lbm
SH - 4	0.75	6.99 SF	2	15.06 lbm
SH - 5	0.75	7.01 SF	2	15.09 lbm
SH - 6	0.75	10.31 SF	2	22.21 lbm
SH - 7	0.75	26.19 SF	2	56.40 lbm
SH - 8	0.75	96.00 SF	6	206.76 lbm
SH - 9	0.75	33.03 SF	2	71.15 lbm
SH - 10	0.75	38.81 SF	2	83.59 lbm
SH - 11	0.75	41.17 SF	2	88.67 lbm
SH - 12	0.75	44.92 SF	2	96.76 lbm
SH - 13	0.75	140.85 SF	6	303.35 lbm
SH - 14	0.75	144.00 SF	6	310.14 lbm
SH - 15	0.75	167.82 SF	6	361.44 lbm
SH - 16	0.75	168.18 SF	6	362.23 lbm
SH - 17	0.75	188.85 SF	6	406.73 lbm
56		1126.00 SF		2425.14 lbm

Before you start

Sheathing or paneling is created using Revit **Parts**.

In order to see the sheathing or paneling, you have to select **Show Parts** or **Show Both** in **View Properties** → **Parts Visibility**.

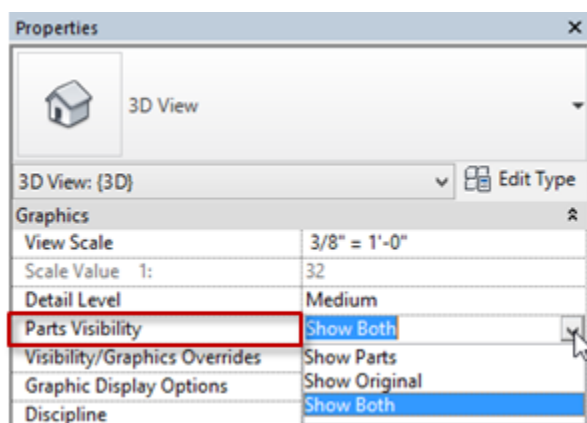

In the **Element Properties** you can find all information about every created sheathing/paneling segment. This information can later be used in tags and schedules.

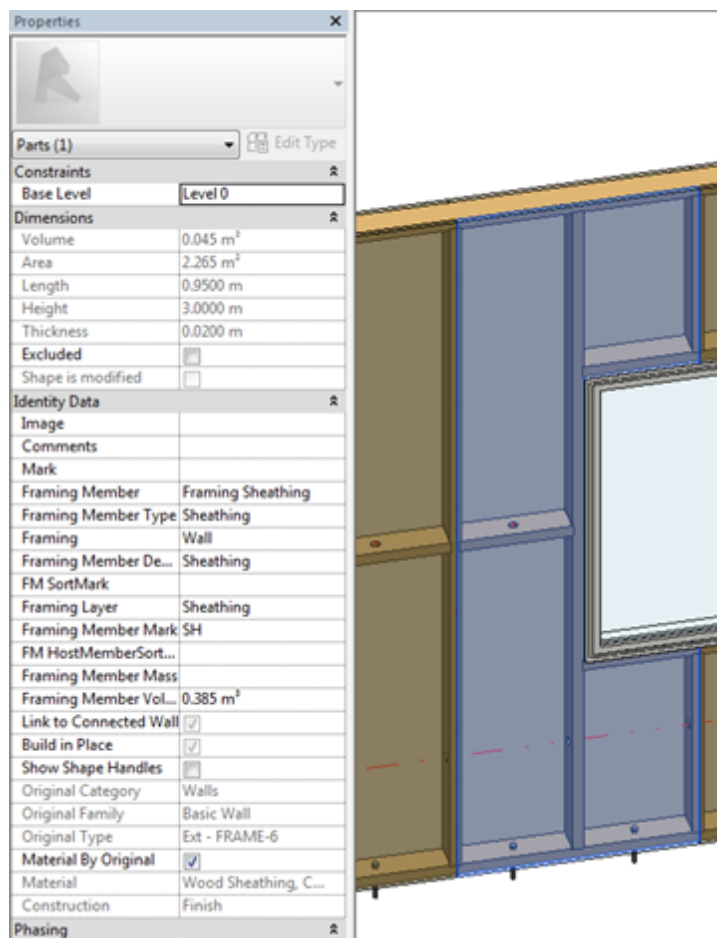

Split Parts

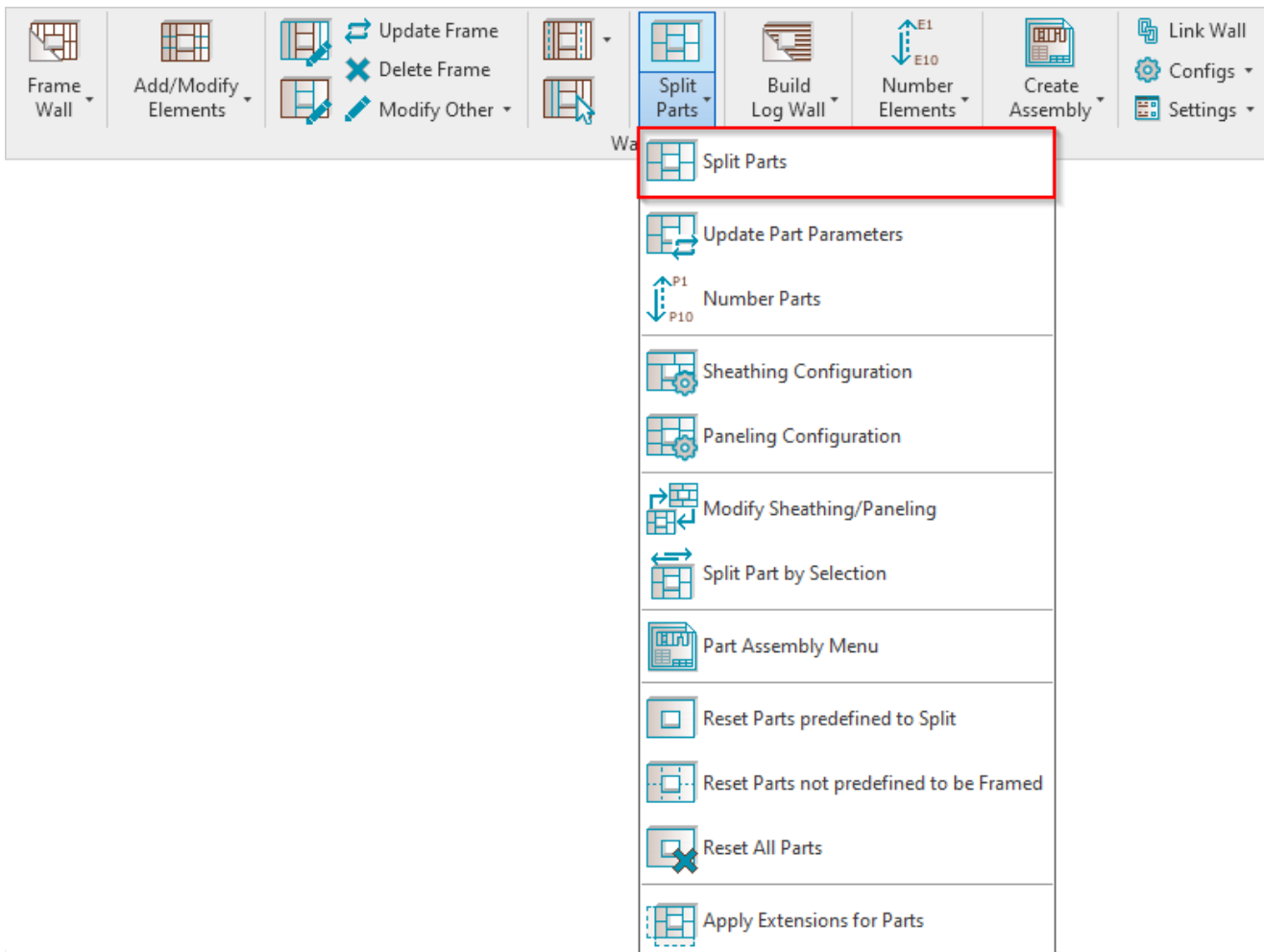

Split Parts – splits sheathing or paneling into segments by predefined **Sheathing Configuration** or **Paneling Configuration**. You just need to select a wall or any frame of a wall.

*Note: In order to see the sheathing, switch on **Show Parts** or **Show Both** under **Parts Visibility** in the **View Properties**.*

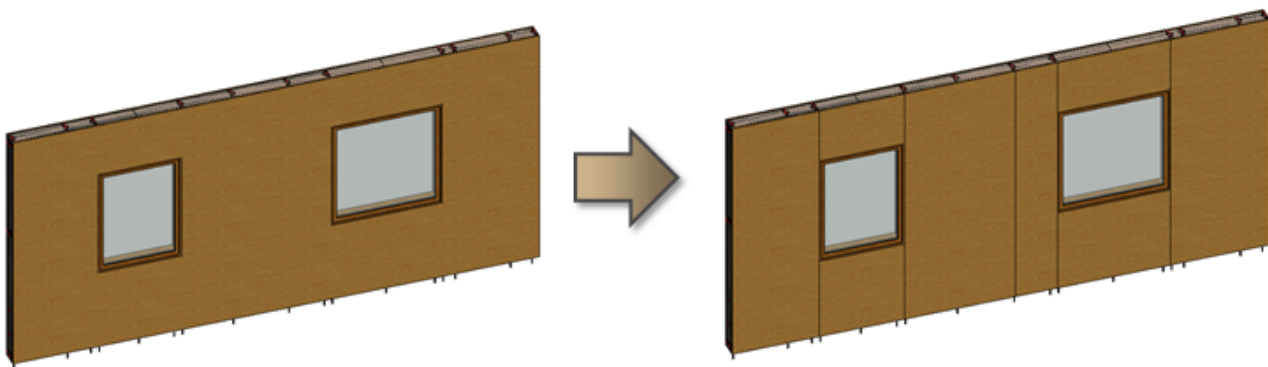

Sheathing or Paneling will be split if selected wall layer will have the conditions below in **Link Wall**:

- **Framing Layer** predefined as **Sheathing**, **Sheathing II**, or **Paneling**.
- **Sheathing/Paneling Configuration** name selected. It saves all settings for the sheathing/paneling layouts.
- **Split Parts** is ticked.

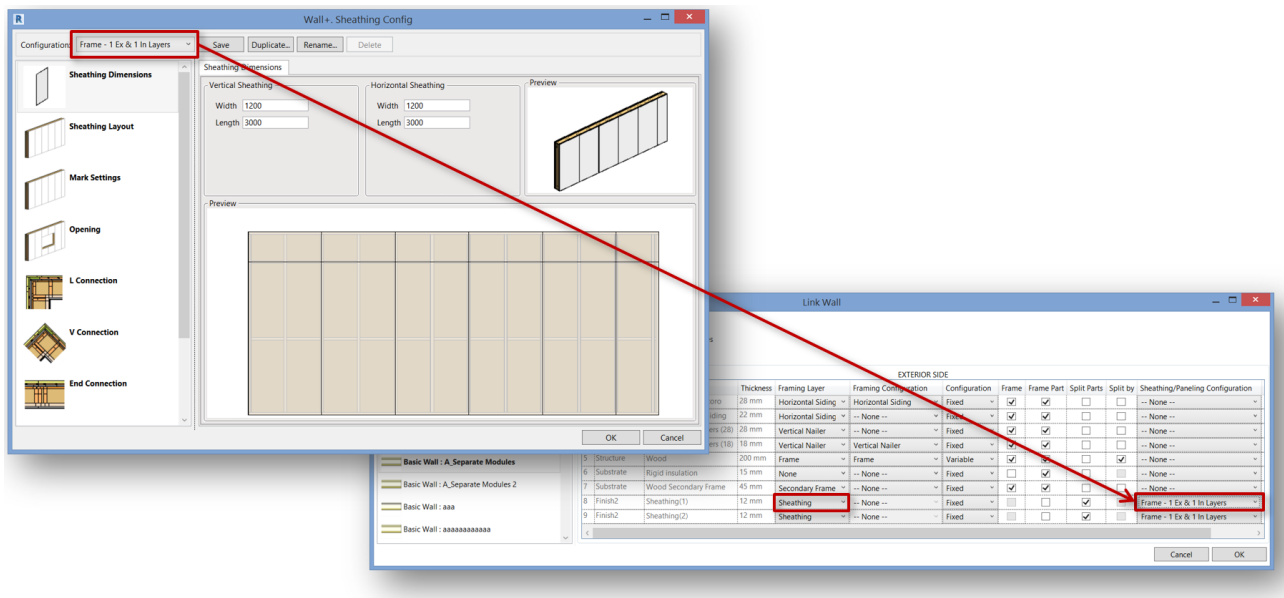

Split Parts – select if parts need to be split after using **Split Parts** function or should be split later. This is very useful if there are many layers in the wall, for example, two sheathing/paneling layers and you want to split only one.

Family: Basic Wall
 Type: Ext 3VerSiding - VS22-HN45-FR-SFR45-SH12
 Total thickness: 234

Layers

EXTERIOR SIDE									
Thickness	Framing Layer	Framing Configuration	Configuration	Frame	Frame Part	Split Parts	Split by	Sheathing/Paneling Configuration	Exclude Parts
12 mm	Sheathing	-- None --	Variable	<input type="checkbox"/>	<input type="checkbox"/>	<input checked="" type="checkbox"/>	<input type="checkbox"/>	3. Horizontal 3000 _ Horizontal	<input type="checkbox"/>
45 mm	Horizontal Nailers	Horizontal Nailers b=45	Fixed	<input checked="" type="checkbox"/>	<input type="checkbox"/>	<input type="checkbox"/>	<input type="checkbox"/>	-- None --	<input checked="" type="checkbox"/>
120 mm	Frame	Frame	Variable	<input checked="" type="checkbox"/>	<input type="checkbox"/>	<input type="checkbox"/>	<input type="checkbox"/>	-- None --	<input checked="" type="checkbox"/>
45 mm	Secondary Frame	Secondary Frame	Fixed	<input checked="" type="checkbox"/>	<input type="checkbox"/>	<input type="checkbox"/>	<input checked="" type="checkbox"/>	-- None --	<input checked="" type="checkbox"/>
12 mm	None	-- None --	Fixed	<input type="checkbox"/>	<input type="checkbox"/>	<input type="checkbox"/>	<input type="checkbox"/>	-- None --	<input checked="" type="checkbox"/>

Update Part Parameters

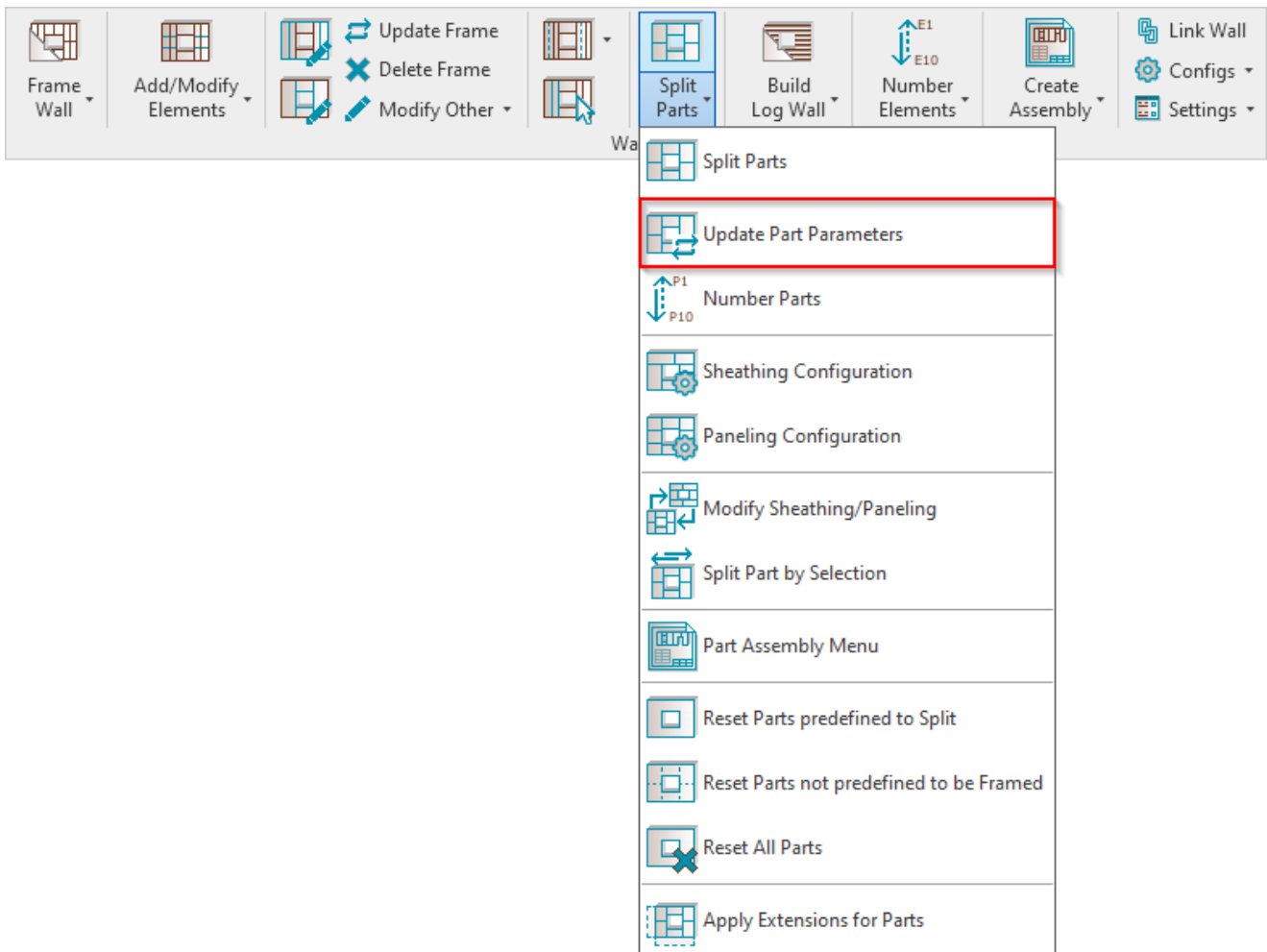

Update Part Parameters - updates part parameters from **Sheathing/Paneling Configuration** → **Mark Settings** without needing to use **Split Parts** on the wall or again. Also enters **HostMemberSortMark** parameter.

Number Parts

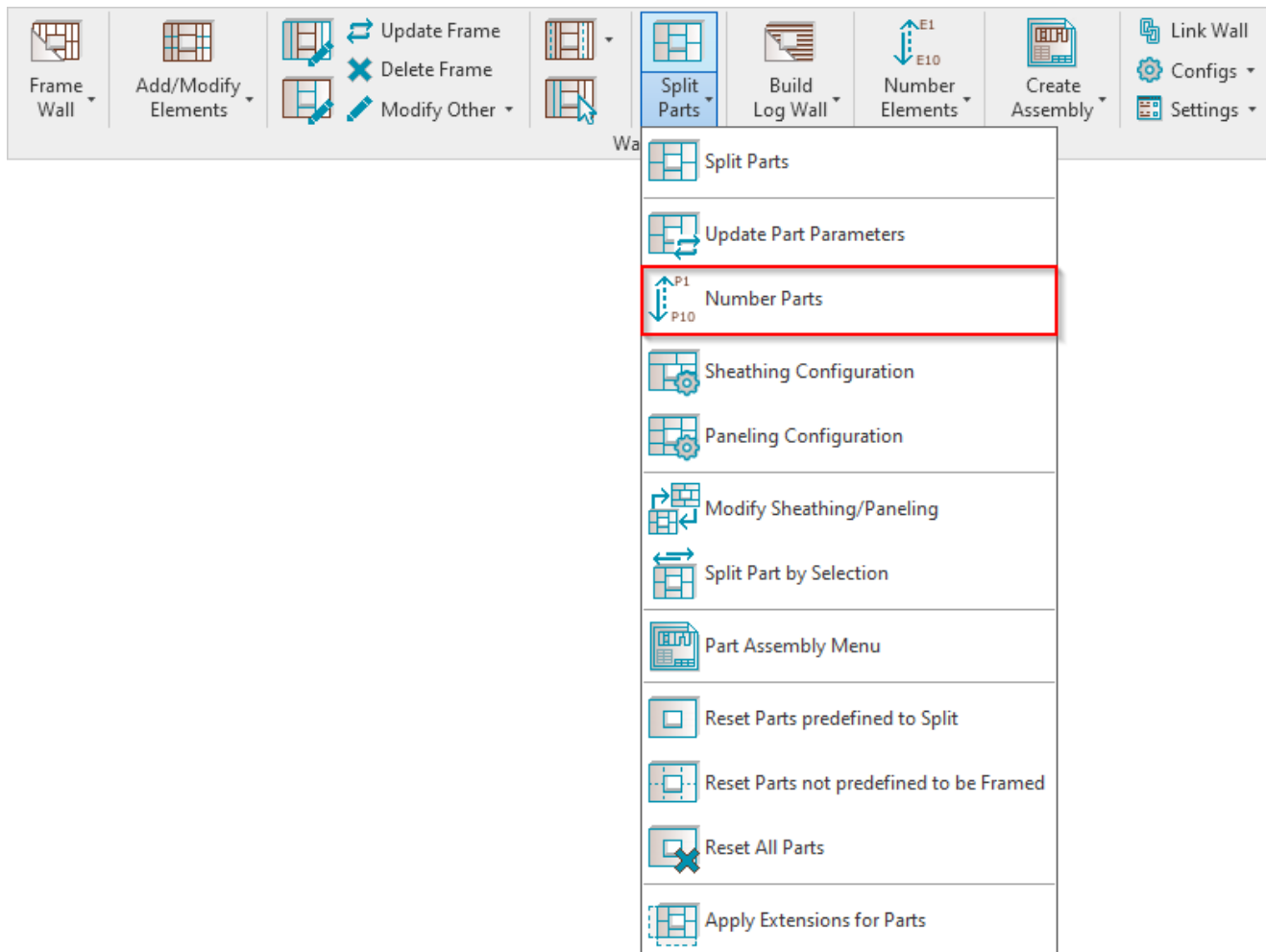

OR:

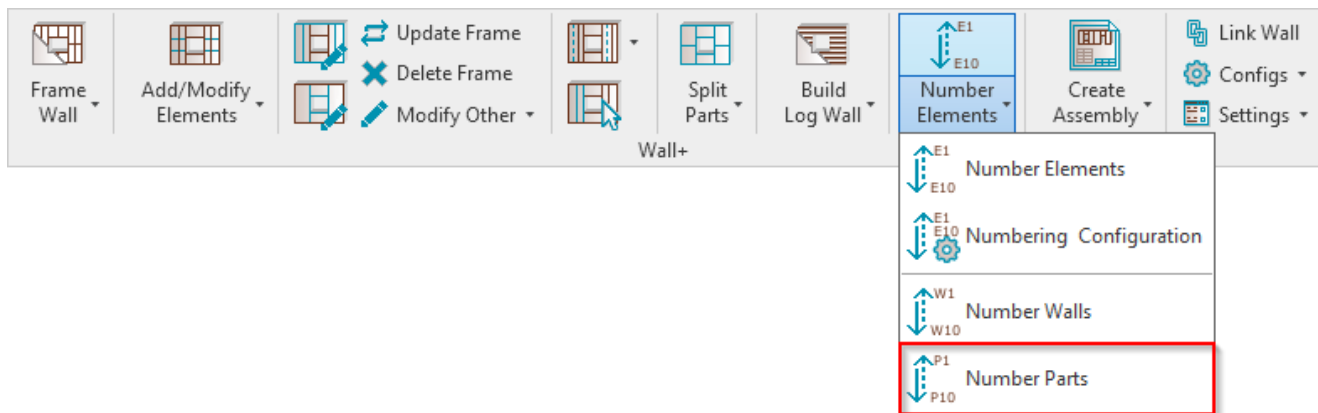

Number Parts - rennumbers all sheathing/paneling elements (Parts) by predefined configuration in **Numbering Setup** → **Part Numbering Configuration**. Part numbering configurations come from **Sort Mark** (<http://www.agacad.com/products/tools4revit/sort-mark>).

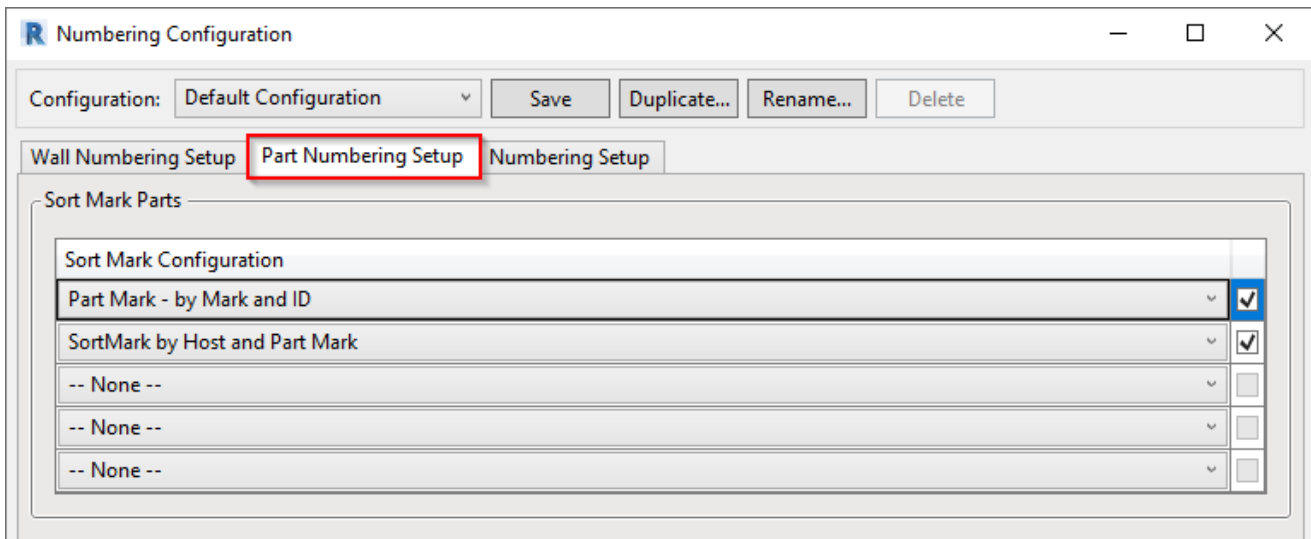

*Example: All sheathing/paneling elements (Parts) are grouped by **Framing Member Mark**, uniquely numbered, and have **Framing Member Mark** value as a prefix. Result is written to the **Mark** instance parameter.*

[Sort Mark E-Help >>](#)

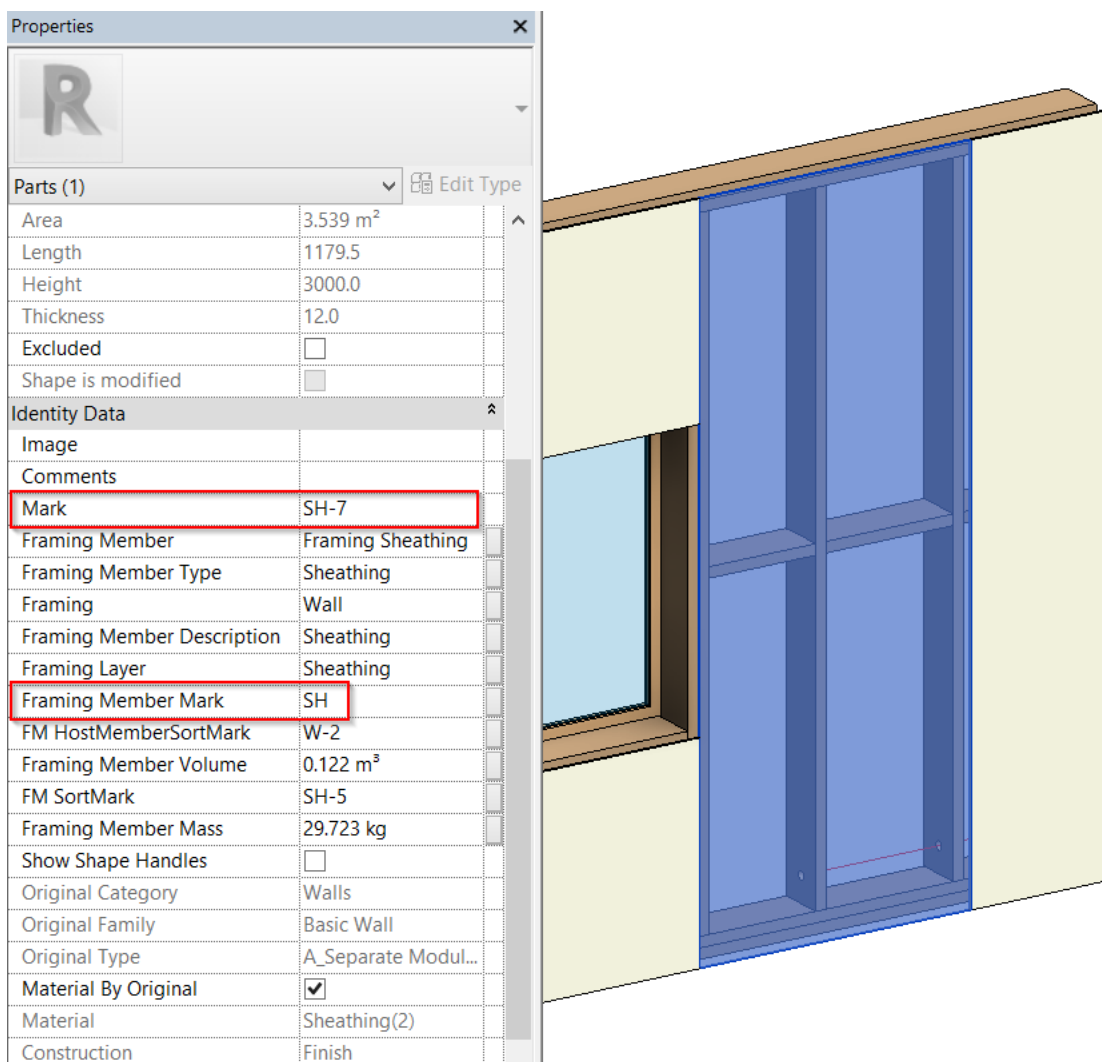

Sheathing Configuration

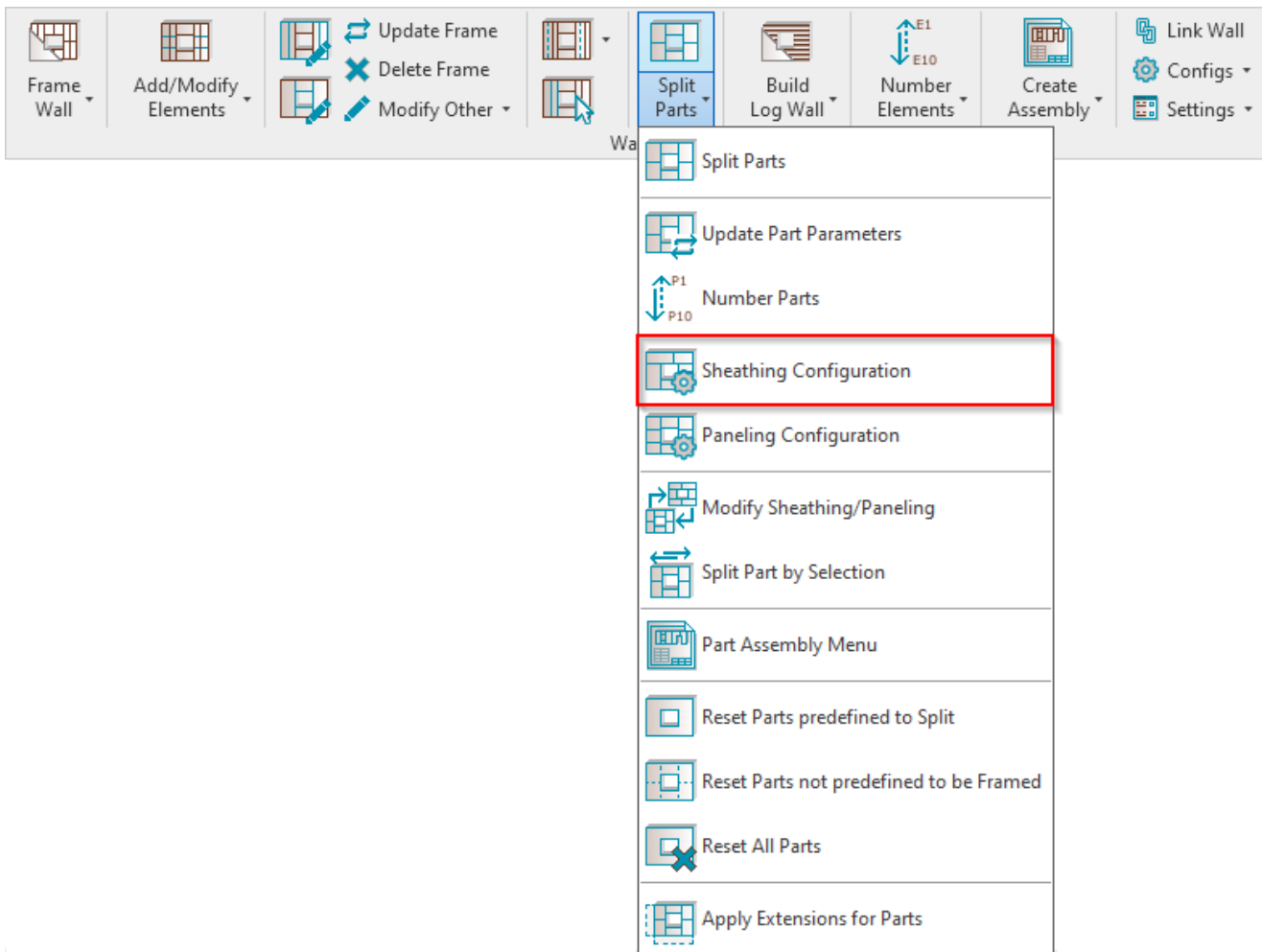

Sheathing Configuration – allows user to configure and save settings for the sheathing layouts. These settings can be saved and linked with wall layer using **Link Wall**.

Read more >> (<https://agacad.freshdesk.com/a/solutions/articles/44001695487-sheathing-and-paneling-layouts-sheathing-configuration>).

Paneling Configuration

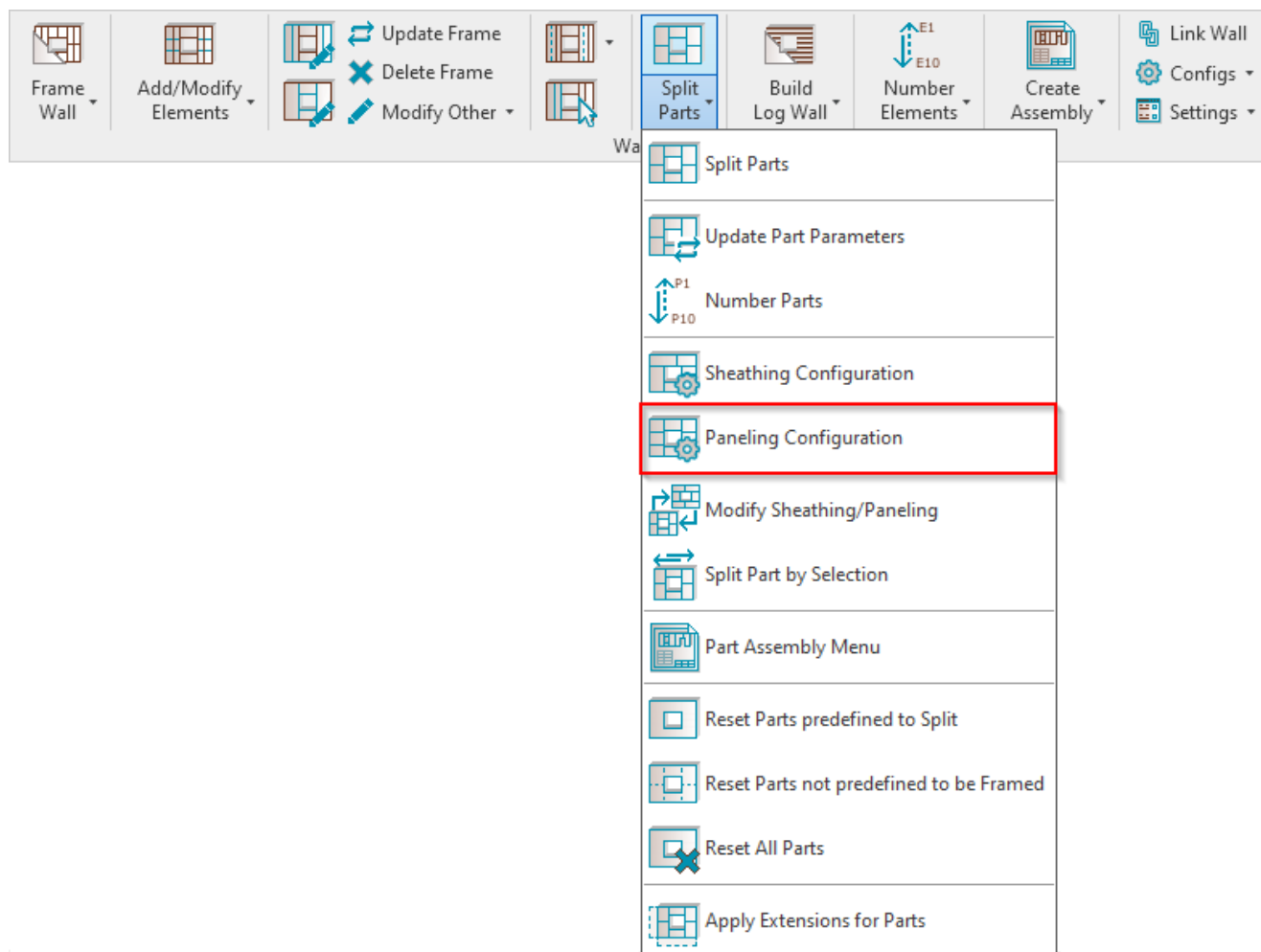

Paneling Configuration – allows you to configure and save settings for the paneling layouts. These settings can be saved and linked with wall layer using **Link Wall**.

Read more >> (<https://agacad.freshdesk.com/a/solutions/articles/44001698865-sheathing-and-paneling-layouts-paneling-configuration>).

Modify Sheathing/Paneling

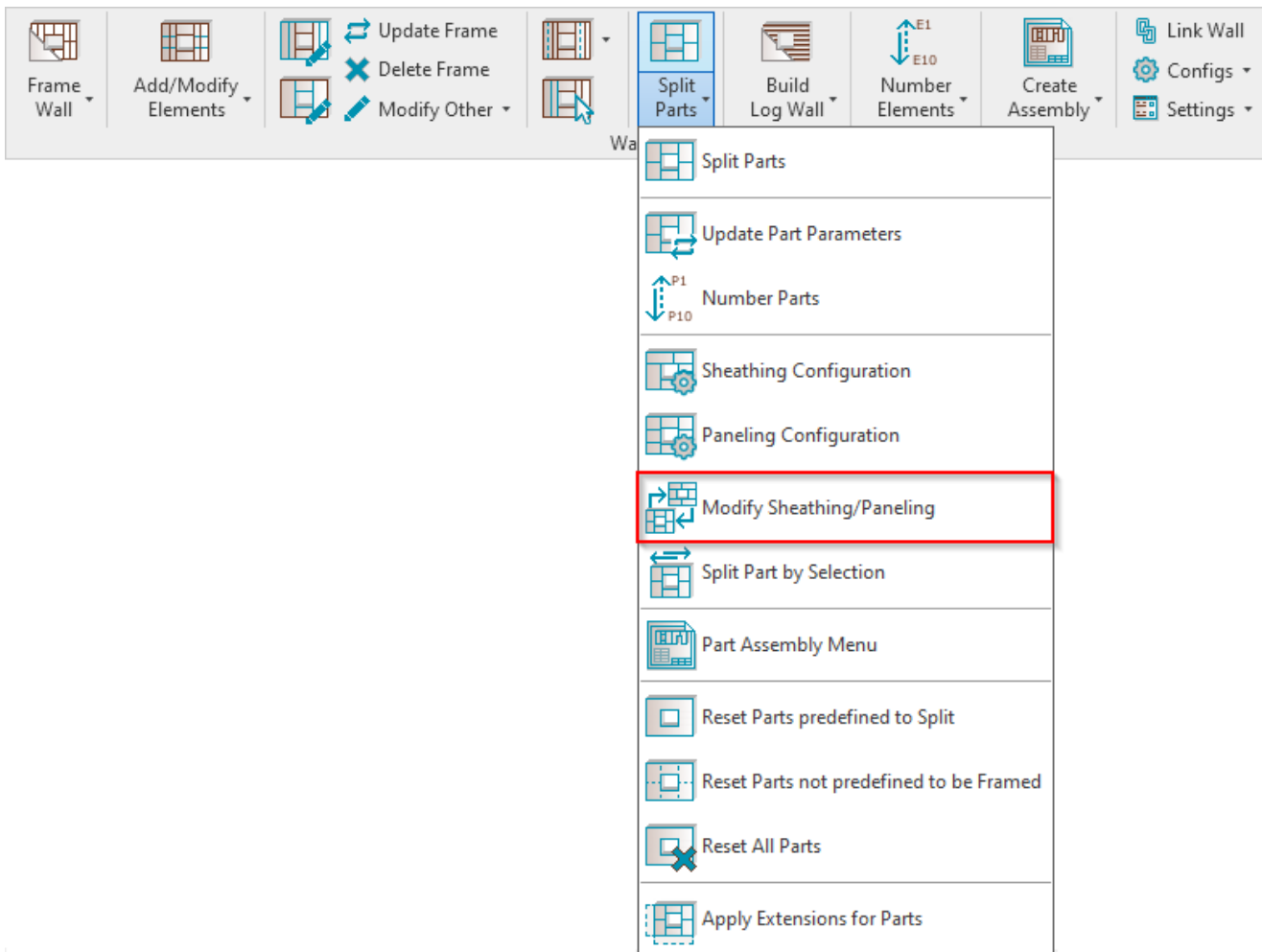

Modify Sheathing/Paneling – changes selected wall layer sheathing/paneling configuration to the new one from the list.

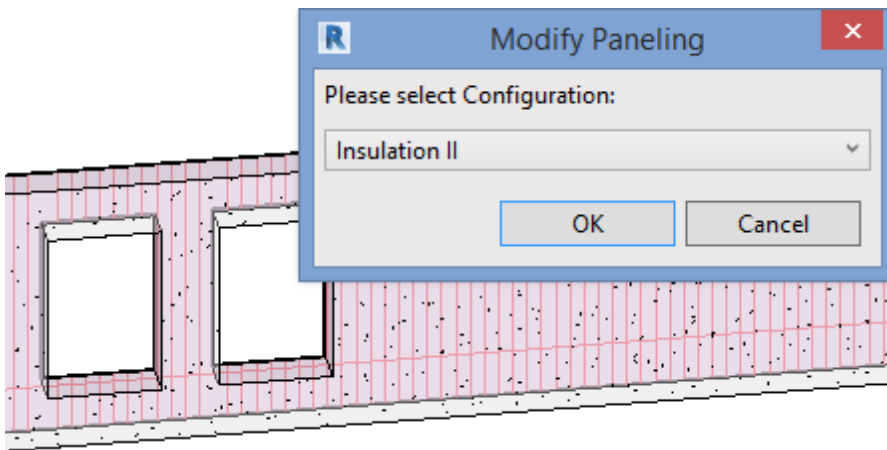

Split Part by Selection

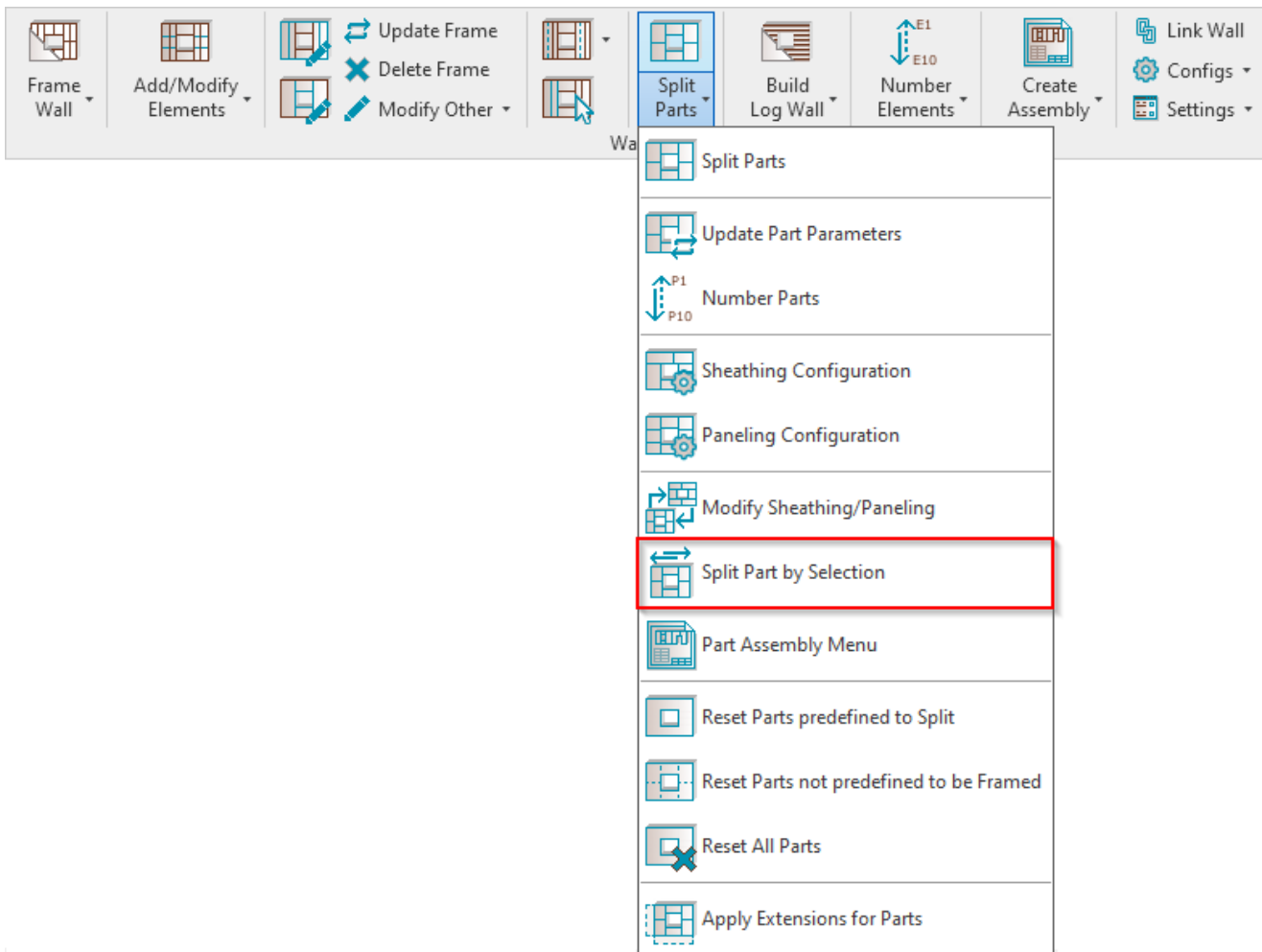

Split Part by Selection – splits selected sheathing/paneling layout by predefined placement direction: **From Start**, **From End**, or **From both Sides**.

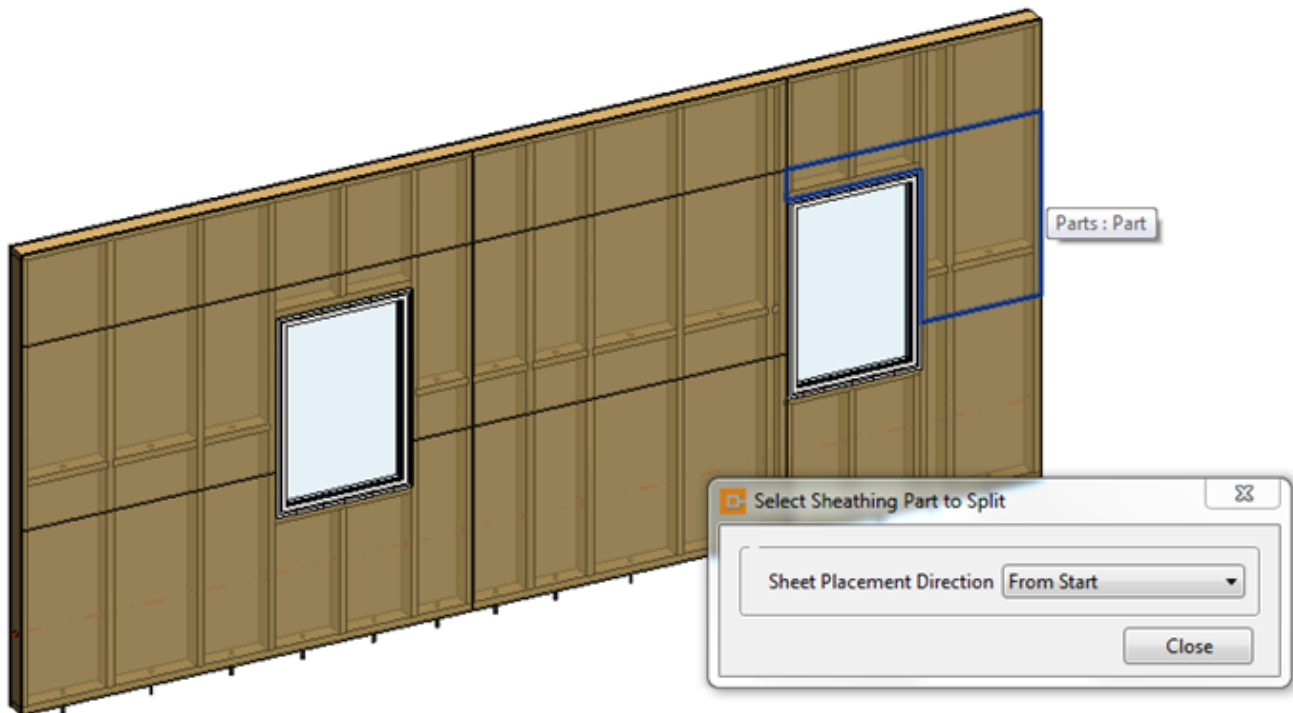

Part Assembly Menu

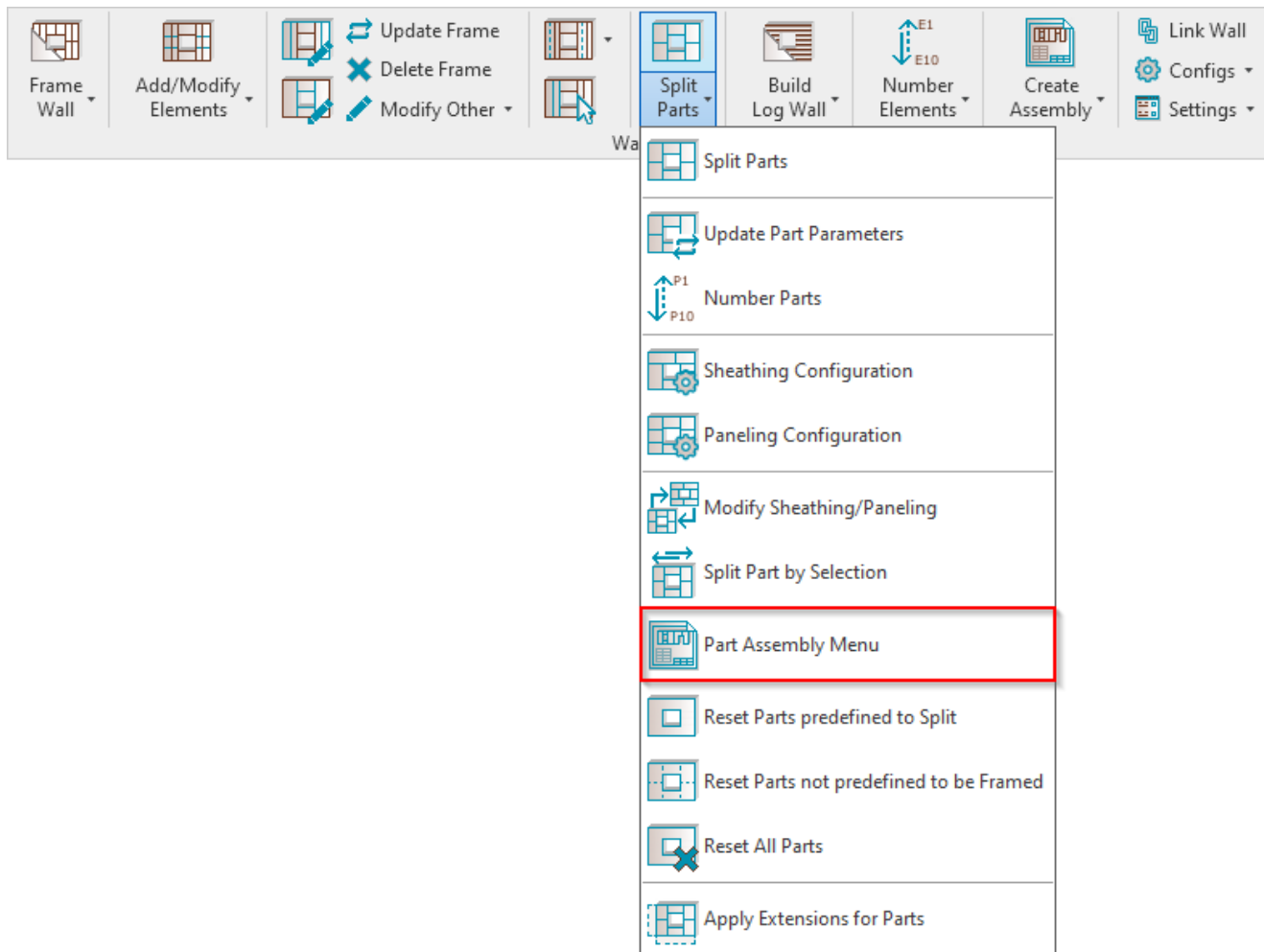

OR:

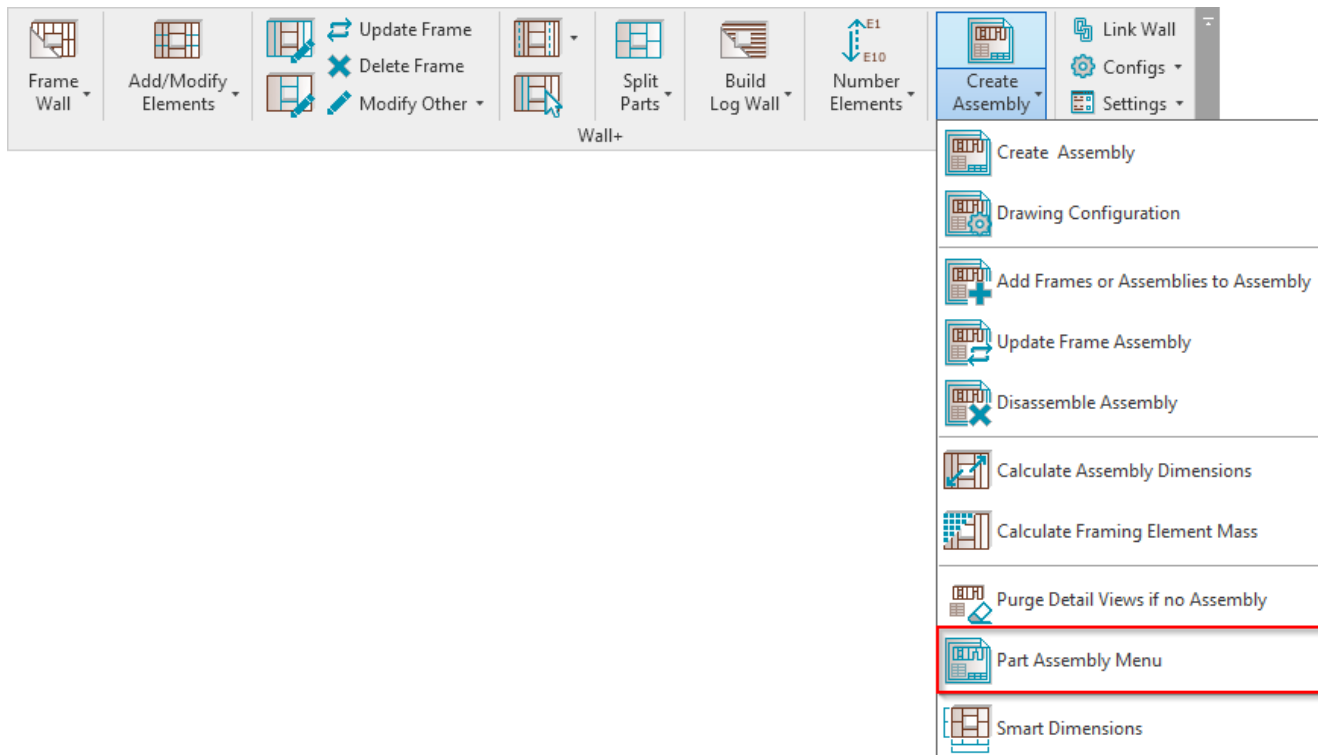

Part Assembly Menu – features for creating assemblies from parts and different part selection options.

[Read more >>](https://agacad.freshdesk.com/a/solutions/articles/44001706615-shop-drawings-part-assembly-menu) (<https://agacad.freshdesk.com/a/solutions/articles/44001706615-shop-drawings-part-assembly-menu>).

Reset Parts predefined to Split

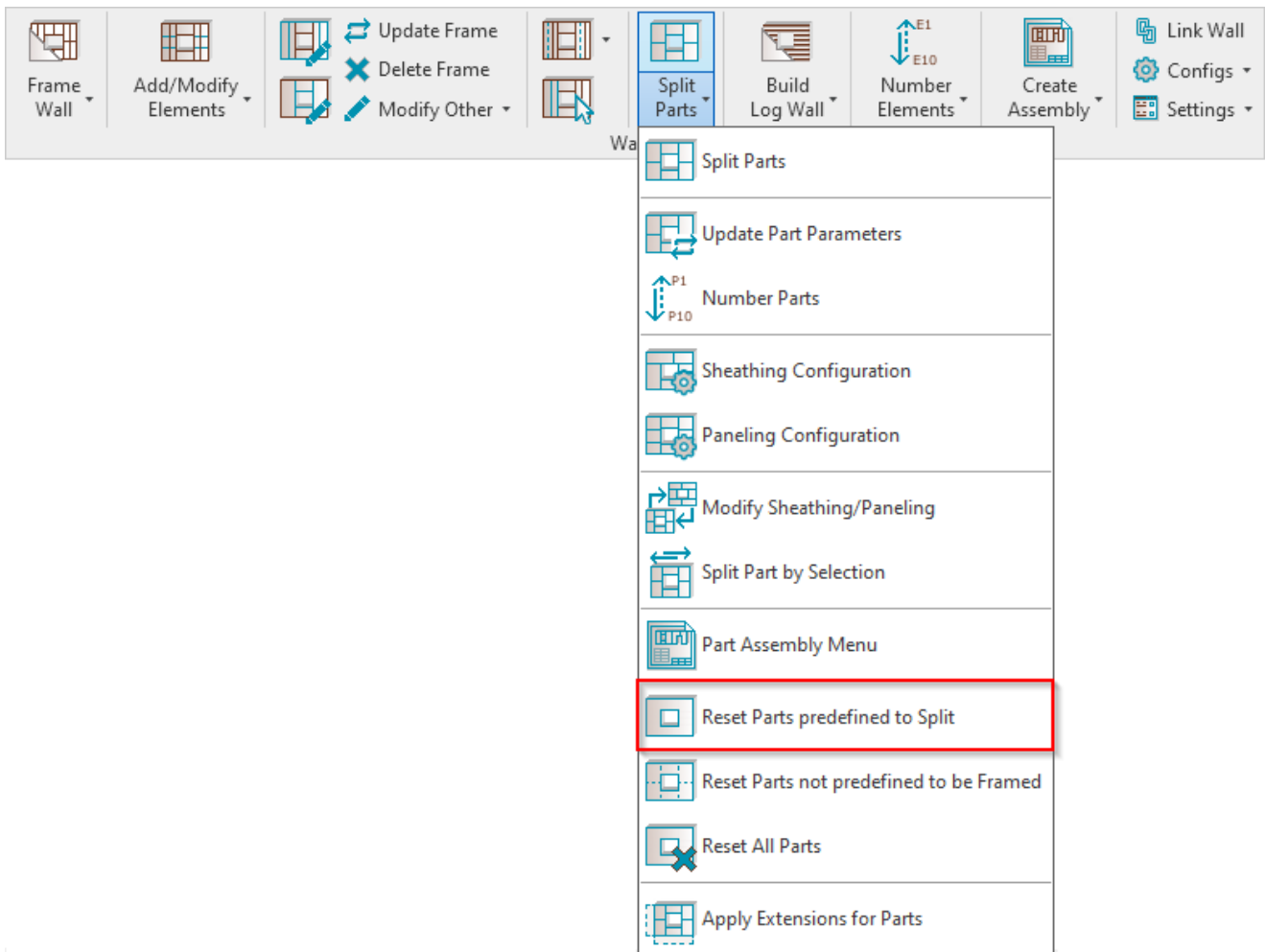

Reset Parts predefined to Split – resets sheathing/paneling layout to a single part.

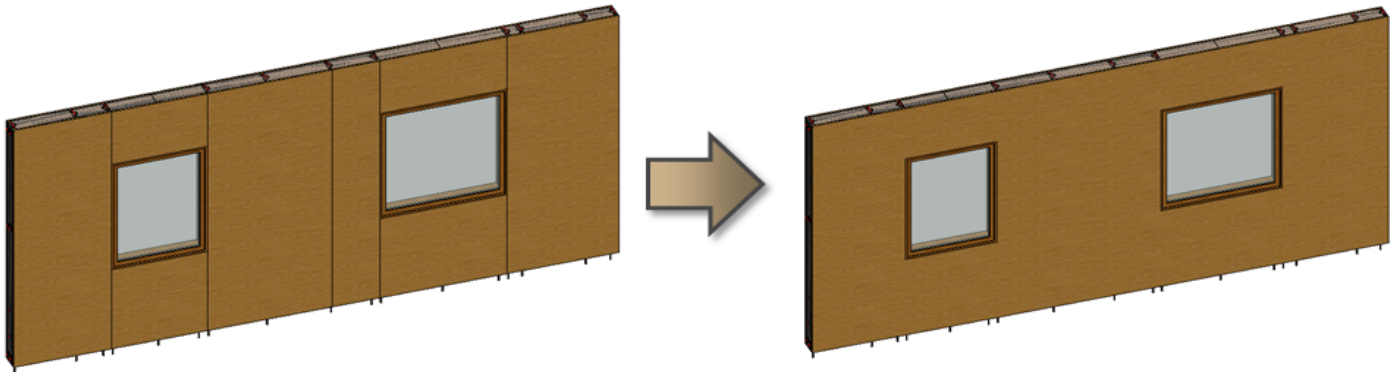

Reset Parts not predefined to be Framed

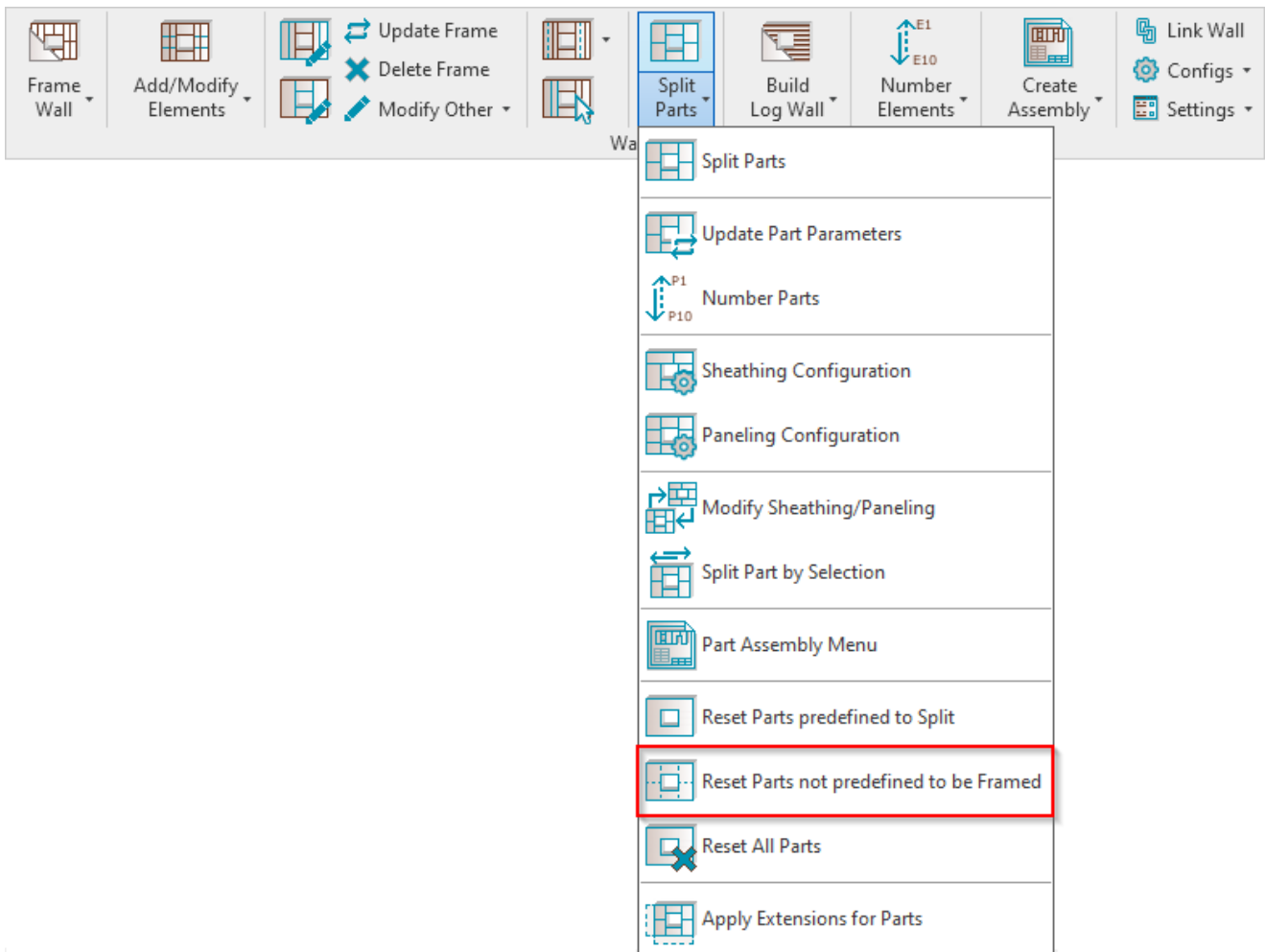

Reset Parts not predefined to be Framed – resets sheathing/paneling parts that were not predefined to be framed.

Reset All Parts

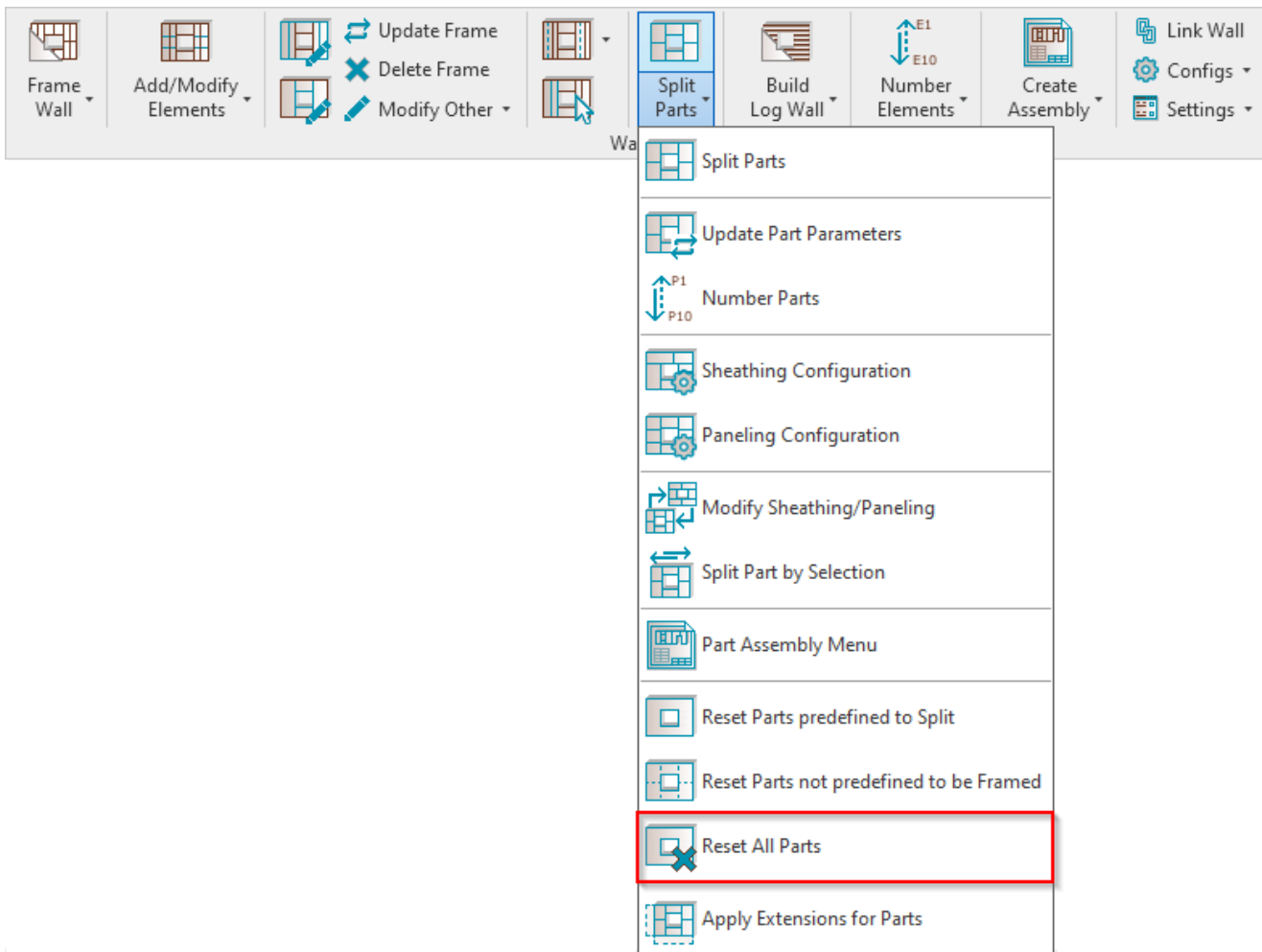

Reset All Parts – resets all sheathing/paneling layouts from selected wall.

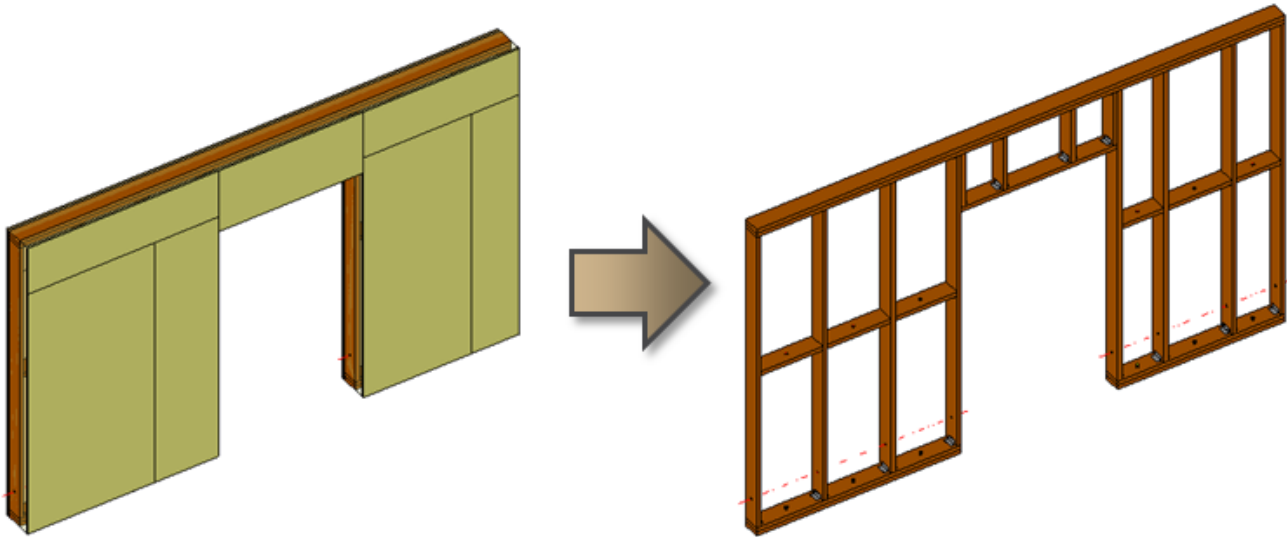

Apply Extensions for Parts

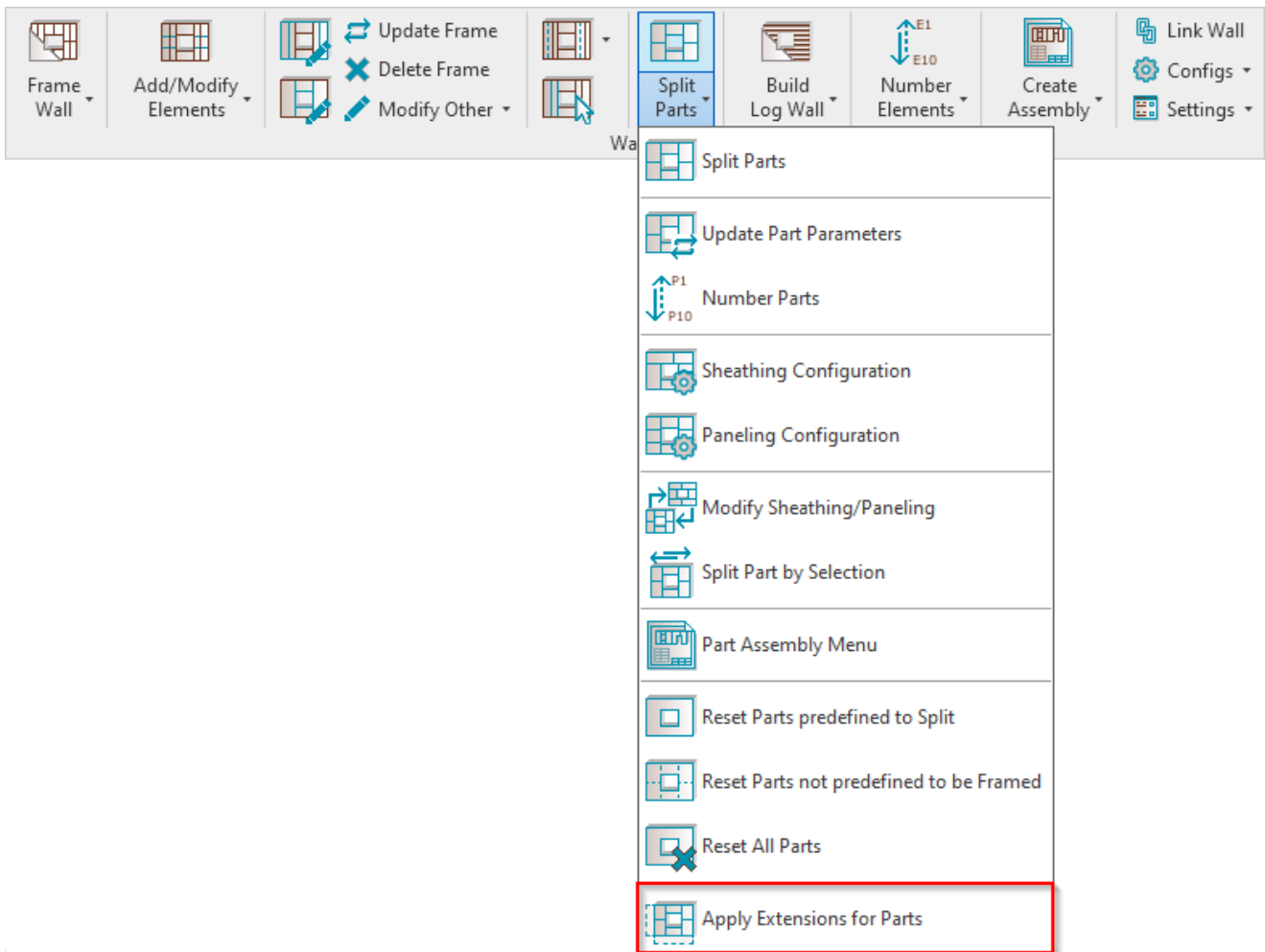

Apply Extensions for Parts – applies extensions for sheathing/paneling parts and merges all part segments. Extension values come from **Sheathing** or **Paneling Configuration**.

