

SHOP DRAWINGS – Part Assembly Menu

Modified on: Wed, 7 Aug, 2019 at 2:39 PM

Part Assembly Menu

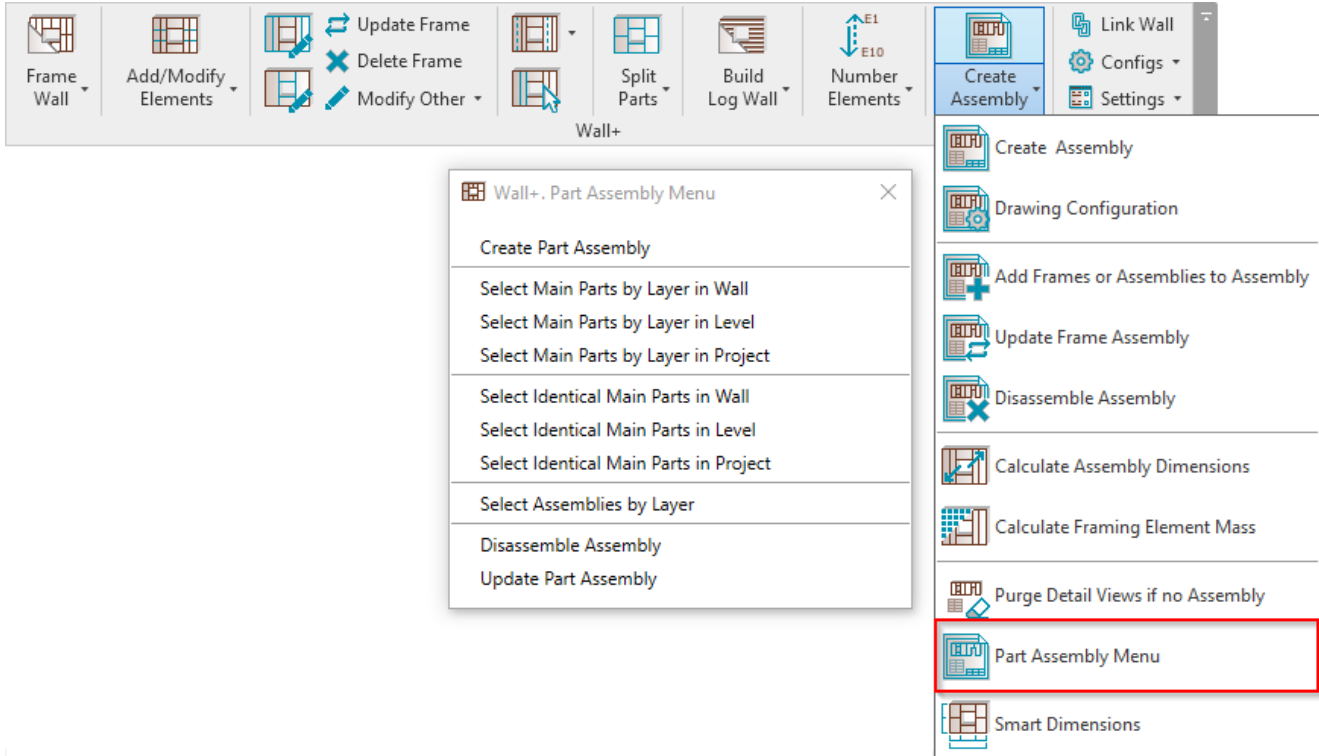

Part Assembly Menu – features for creating a part assembly and different part selection options.

Create Part Assembly

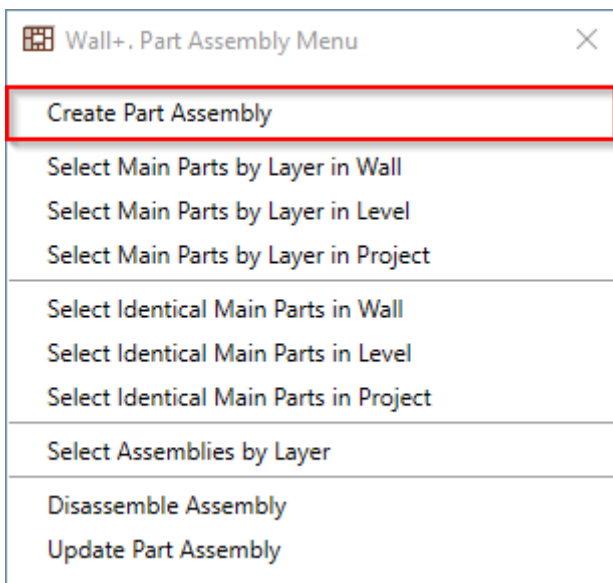

Create Part Assembly – makes shop drawings for selected framed parts. Select any frame of the wall and click Create Part Assembly. The software will create shop drawings according to predefined configurations. You can find shop drawings in Project Browser under Assemblies.

*Mandatory condition: selected part needs to have **Mark** value assigned:*

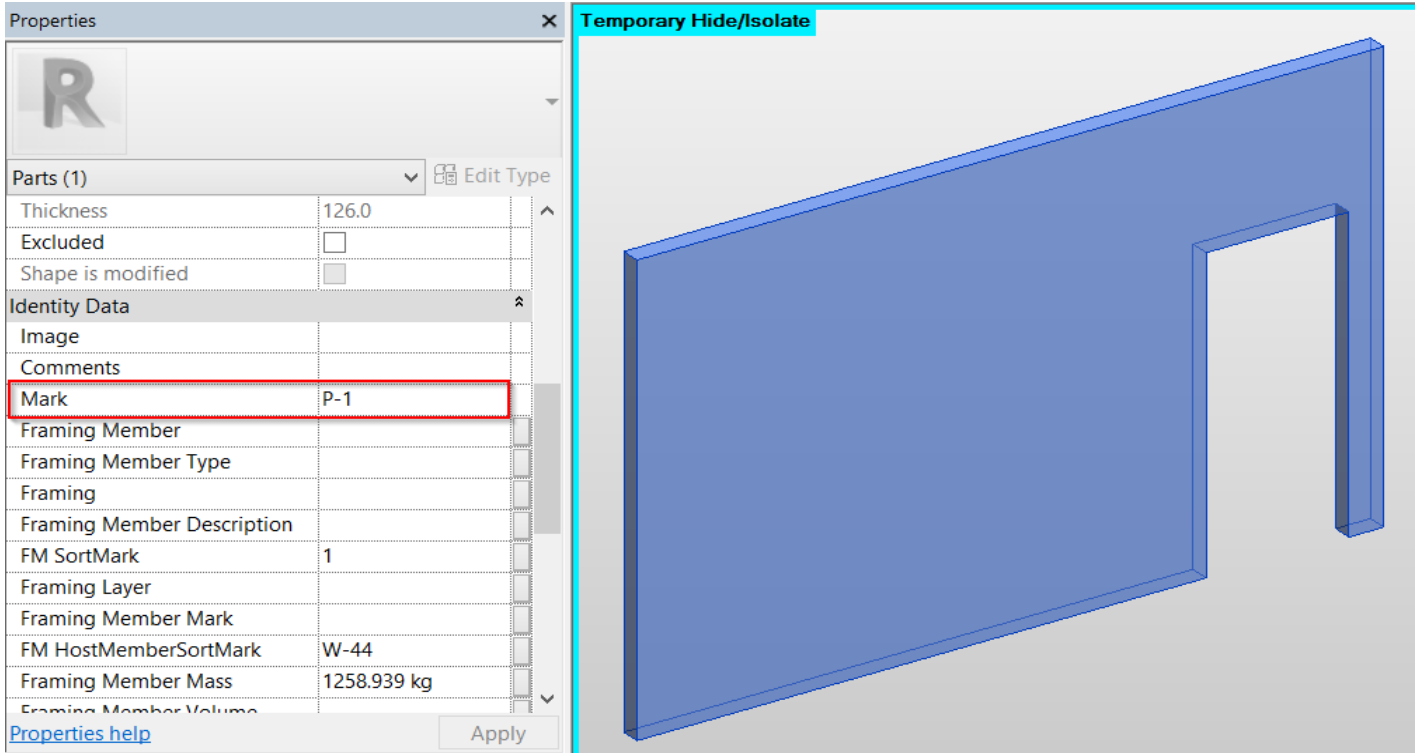

*This value will be used as the assembly name. You can find shop drawings in **Project Browser** under **Assemblies**. An assembly combines all parts in a single entity, which is scheduled and isolated to create shop drawing views with tags and dimensions.*

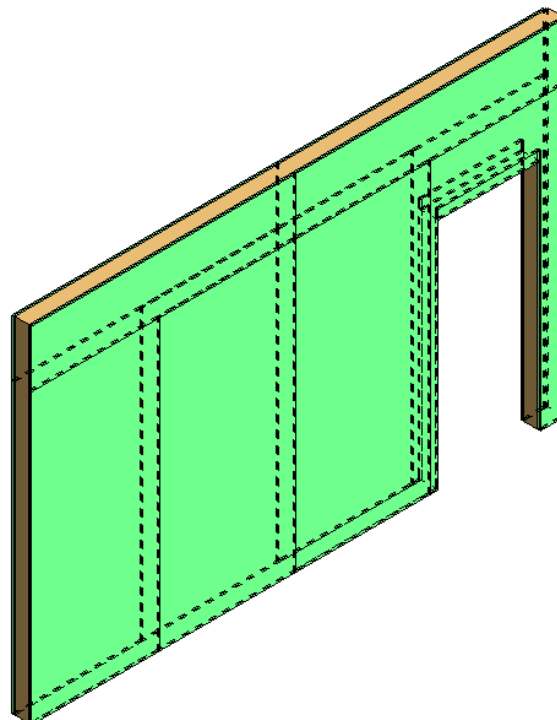
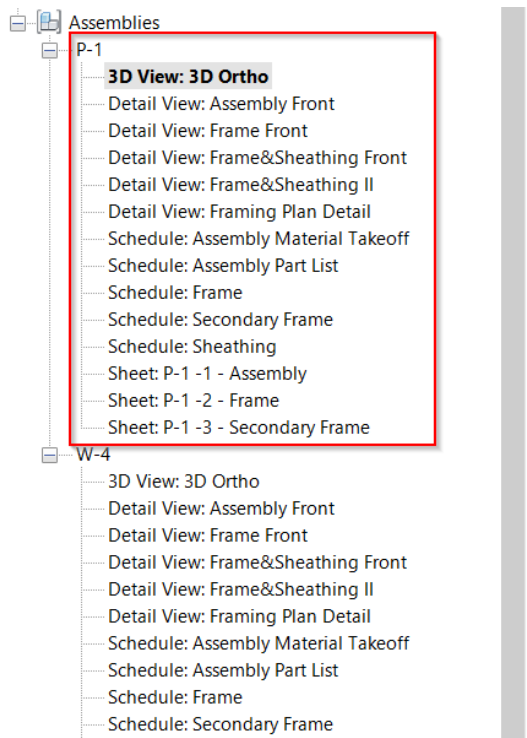

Select Main Parts by Layer in Wall

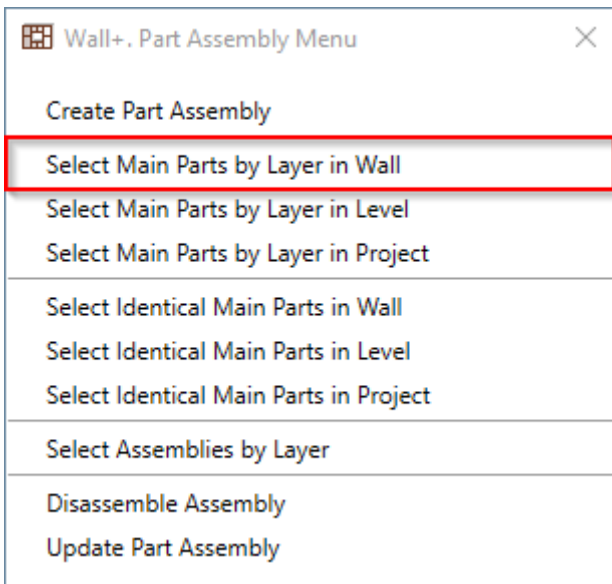

Select Main Parts by Layer in Wall – selects main parts in the framed wall.

Make sure **Show Parts** or **Show Both** is selected in **View Properties** → **Parts Visibility**:

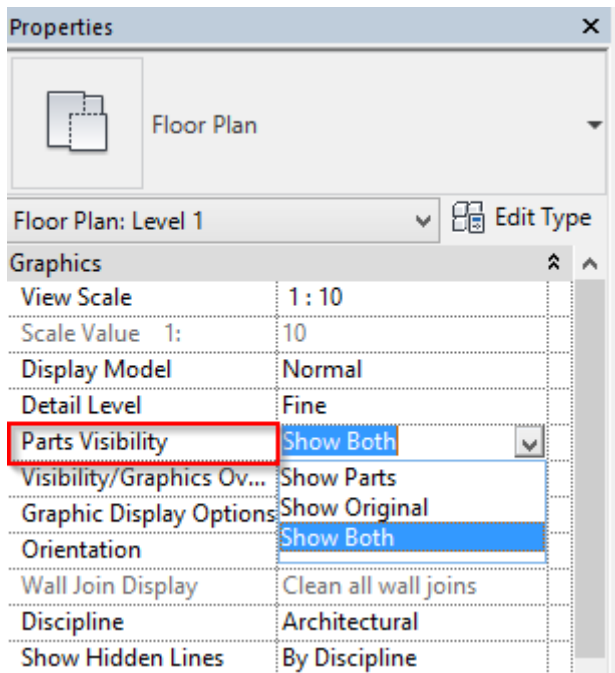

*Example: Click **Select Main Parts by Layer in Wall** and you will able to select only main parts from the framed wall:*

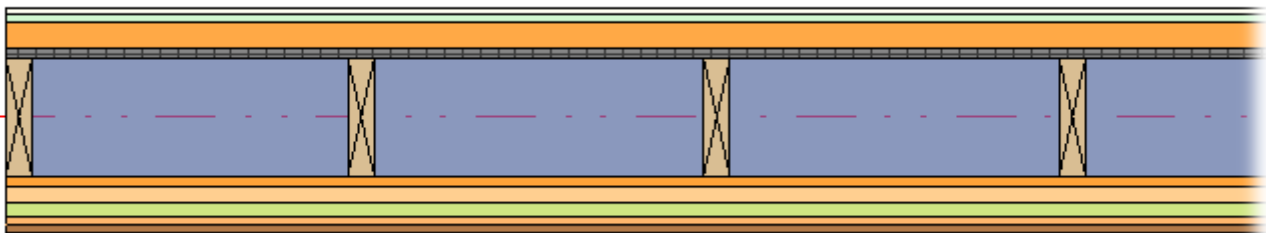

Select Main Parts by Layer in Level

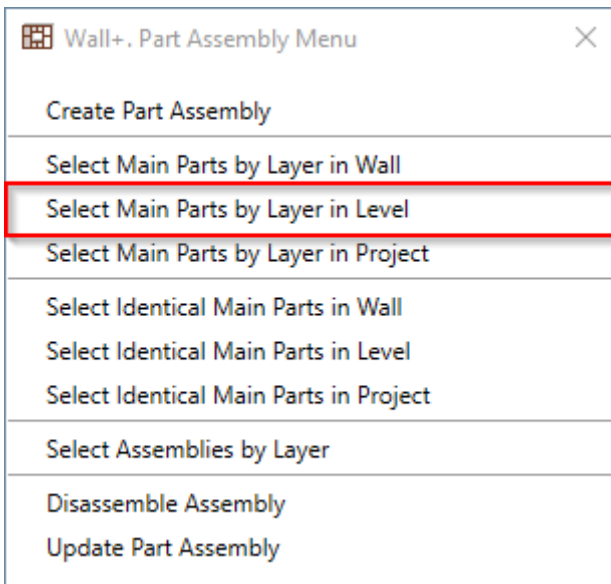

Select Main Parts by Layer in Level – selects main parts in wall frames of the same type in the same level.

Make sure **Show Parts** or **Show Both** is selected in **View Properties** → **Parts Visibility**:

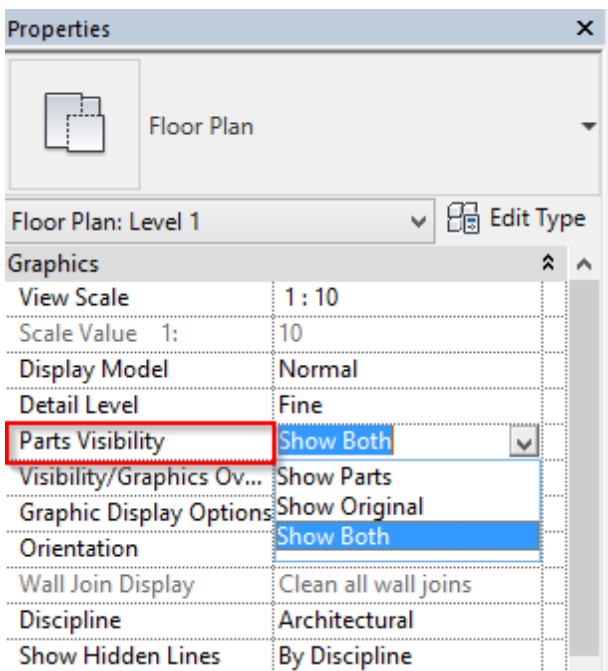

*Example: Click **Select Main Parts by Layer in Level** → select one main part in the framed wall → all main parts of the same type in the same level will be selected. In the image below, the main parts of the external walls in the same level are selected:*

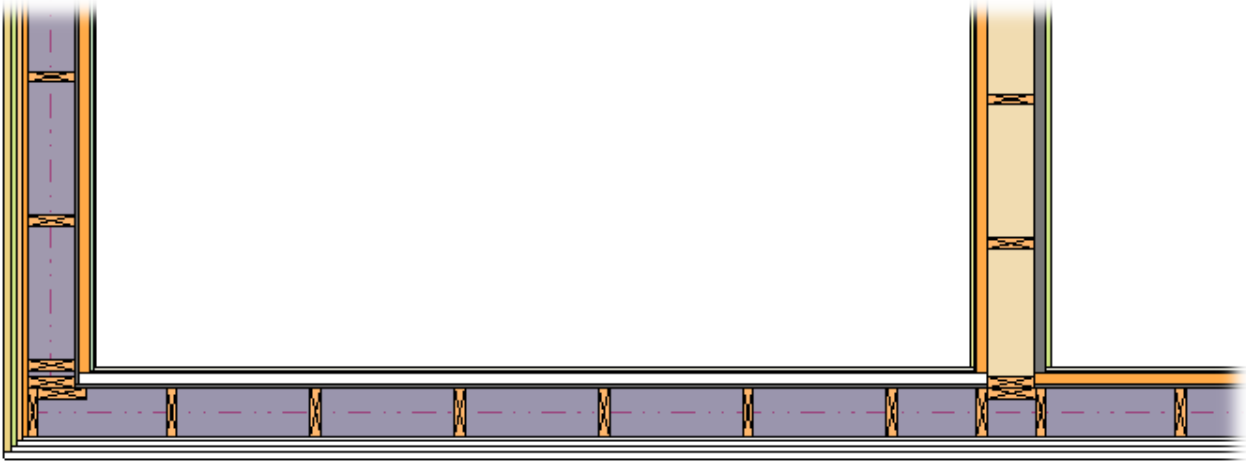

Select Main Parts by Layer in Project

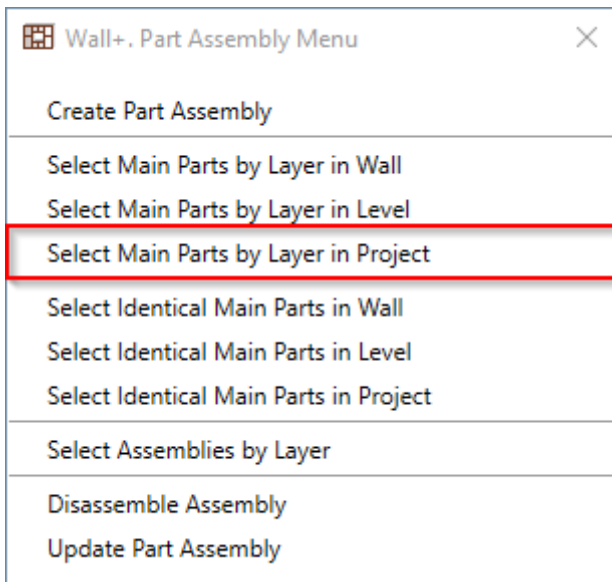

Select Main Parts by Layer in Project – selects main parts in wall frames of the same type in the whole project.

Make sure **Show Parts** or **Show Both** is selected in **View Properties** → **Parts Visibility**:

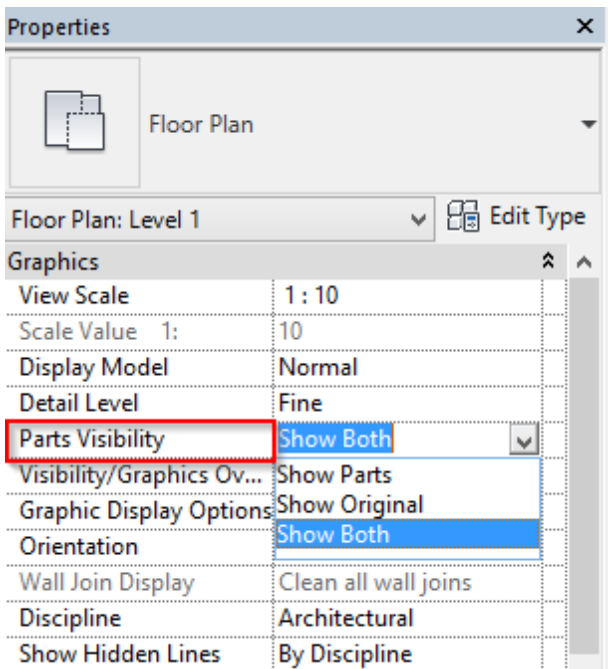

*Example: Click **Select Main Parts by Layer in Project** → select one main part in the framed wall → all main parts of the same type in the whole project will be selected. In the image below, the main parts of the external walls are selected from all levels:*

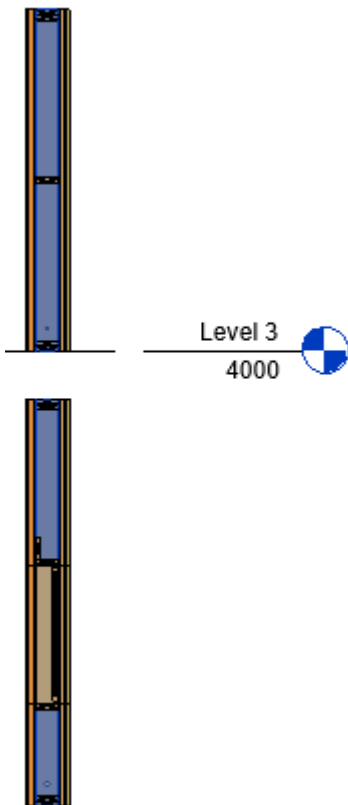

Select Identical Main Parts in Wall

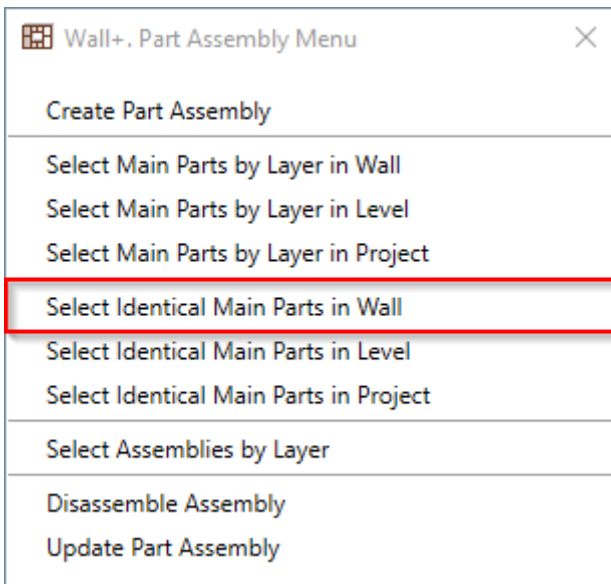

Select Identical Main Parts in Wall – selects identical main parts in the framed wall.

Make sure **Show Parts** or **Show Both** is selected in **View Properties** → **Parts Visibility**:

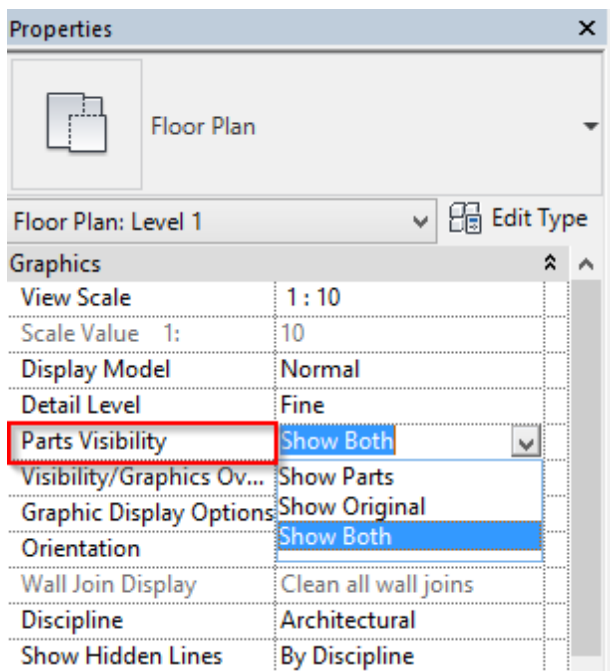

Select Identical Main Parts in Level

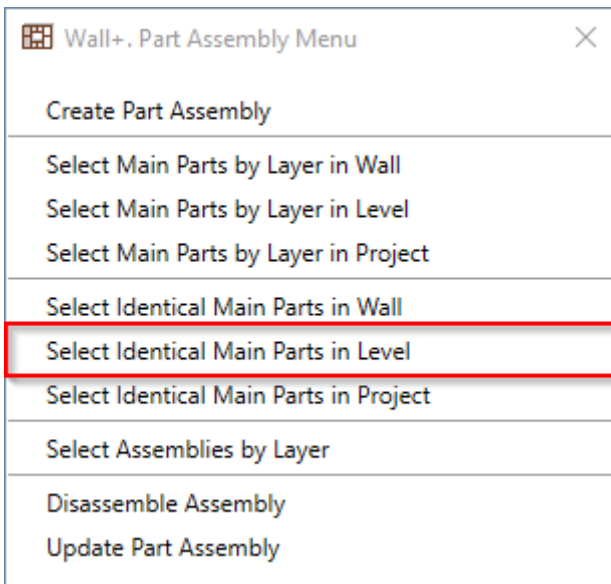

Select Identical Main Parts in Level – selects identical main parts of framed walls in the same level.

Make sure **Show Parts** or **Show Both** is selected in **View Properties** → **Parts Visibility**:

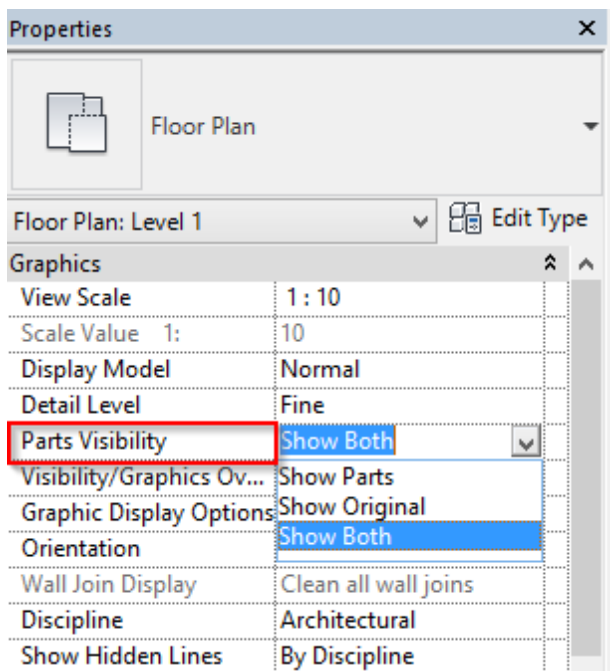

*Example: Click **Select Identical Main Parts in Level** → select one main part in the framed wall → all identical main parts in the same level will be selected:*

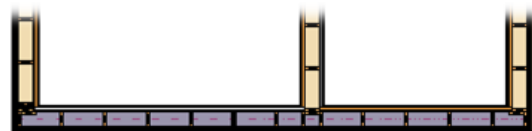
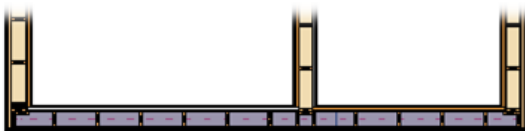

Select Identical Main Parts in Project

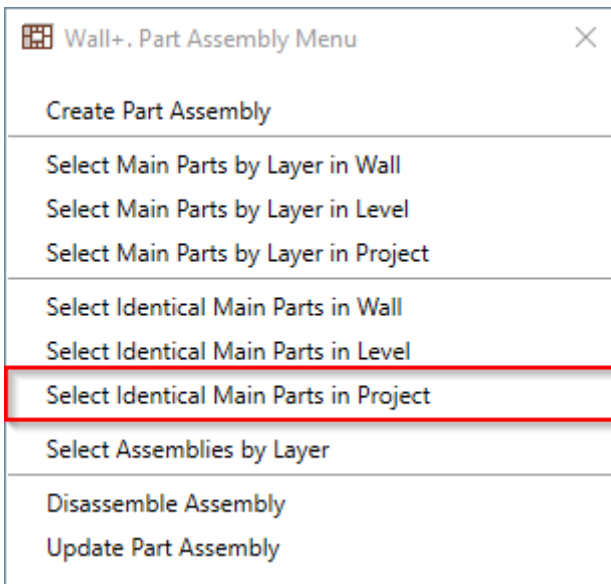

Select Identical Main Parts in Project – selects identical main parts of framed walls in the whole project.

Make sure **Show Parts** or **Show Both** is selected in **View Properties** → **Parts Visibility**:

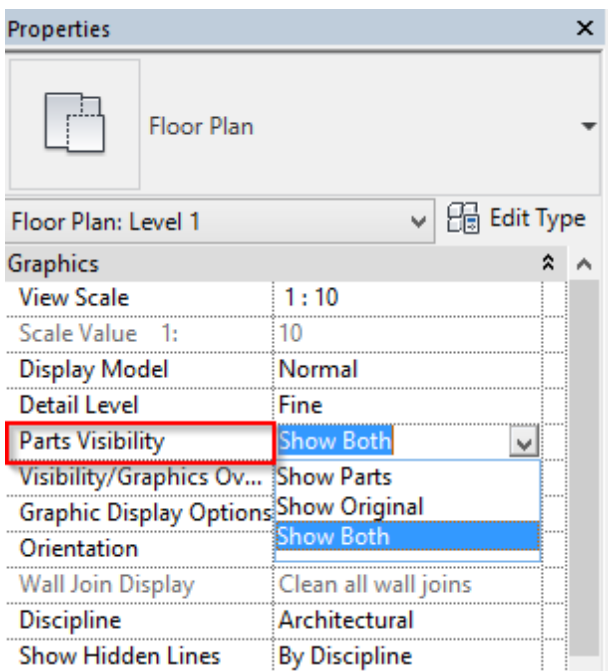

*Example: Click **Select Identical Main Parts in Project** → select one main part in the framed wall → all identical main parts in the whole project will be selected. In the image below, identical main parts are selected from all levels:*

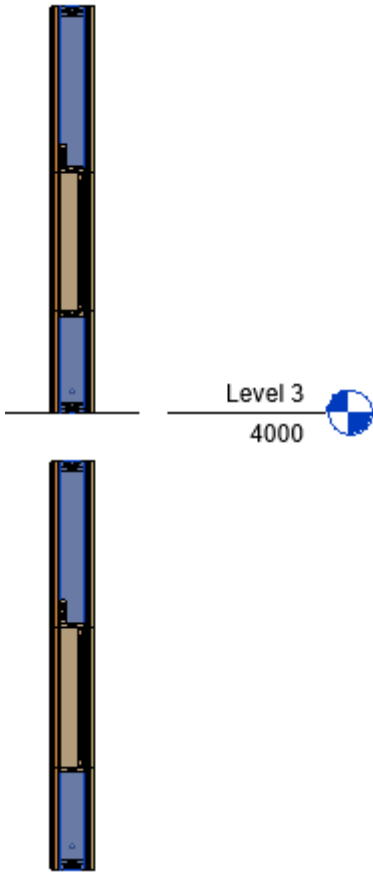

Select Assemblies by Layer

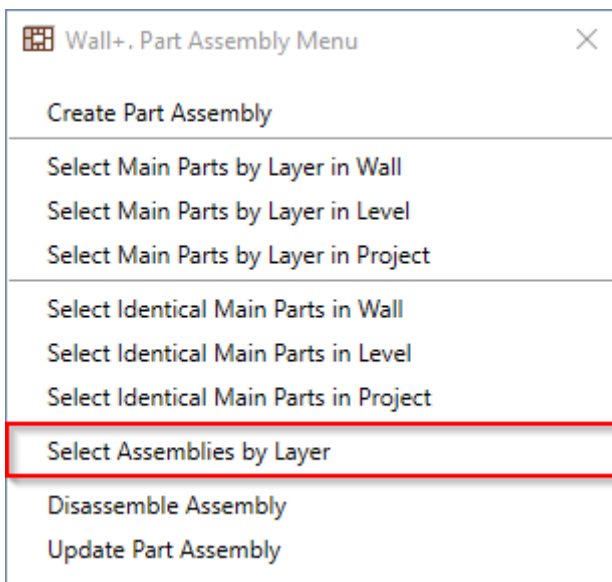

Select Assemblies by Layer – selects all part assemblies from the same wall. You just need to select one assembly and the others will automatically be selected.

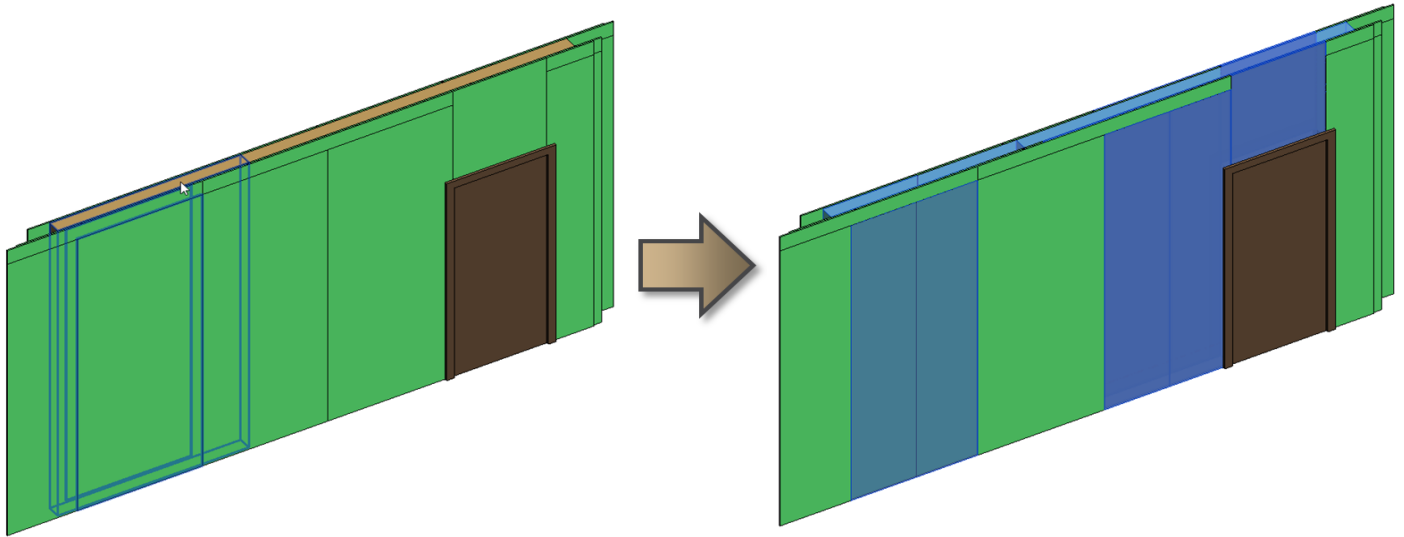

Disassemble Assembly

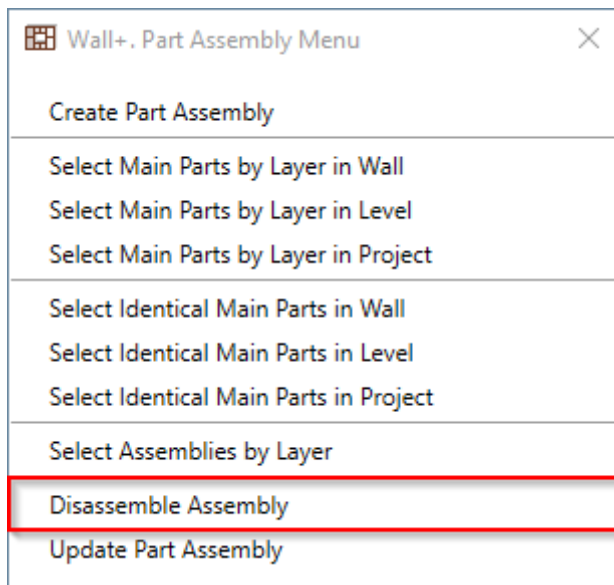

Disassemble Assembly – removes the assembly relationship between elements in the selected assembly and all associated views.

Recommended workflow: Instead of **Revit** → **Disassemble**, we recommend using **Wall+** → **Part Assembly Menu** → **Disassemble Assembly** as it doesn't show unnecessary pop-ups and deletes the gravity point.

Update Part Assembly

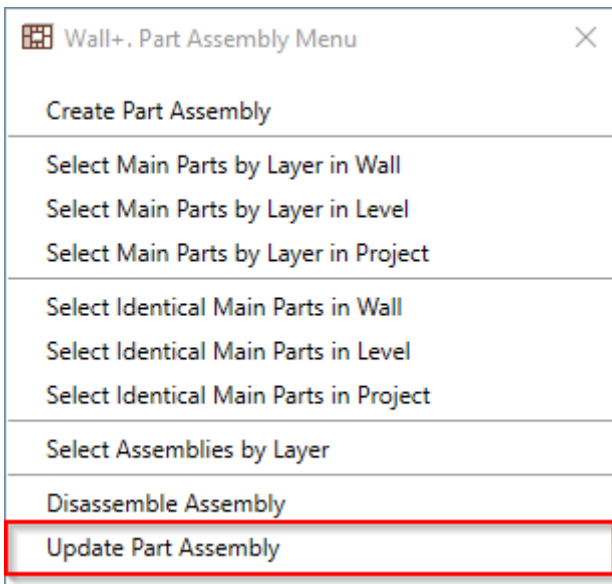

Update Part Assembly – updates the selected part assembly if any changes were made to the parts or to the **Drawing Configuration**.