

Date :	19.10.05	Sign: tb
Last rev:	11.02.09	Sign: tb
Doc. No:	K4-10/40E	Sign: tb
Page 1 of 3		

Additional products BSF, BCC

1. Threaded bar in various dimension and length, for BCC units:

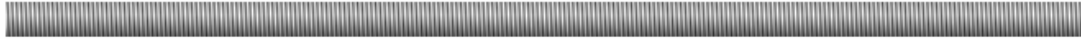

Threaded bar	
Dimension	Length
M 10	1m, 2m og 3m
M 12	1m, 2m og 3m
M 16	1m, 2m og 3m
M 20	1m, 2m og 3m
M30	1m, 2m og 3m

2. Front reinforcement bar for BCC 450:

Ø32 mm reinforcement bar with M33 threaded at the top. Length 150 mm.

Bended with a mandrill diameter of 350 mm.

Height = 480 mm, this height can vary since it depends on the height of the beam and the demand of concrete cover.



3. Safety rope for transport, BBC 250, 450 and 800:

Delivered in package of 10. (3 meters length)



Date :	19.10.05	Sign: tb
Last rev:	11.02.09	Sign: tb
Doc. No:	K4-10/40E	Sign: tb
Page 2 of 3		

Additional products BSF, BCC

4. Safety pin for transport for BSF

Steel block for locking the knife, inside the beam unit.



2. Front reinforcement bar for BCC 800:

Ø32 mm reinforcement bar with M33 threaded at the top. Threaded Length 150 mm.

Bended with a mandrill diameter of 350 mm.

Forward/lower reinforcement bar with the height:

701 mm

Rear/ upper reinforcement bar with the height :

626 mm



The height can vary since it depends on the height of the beam and the demand of concrete cover.

Date :	19.10.05	Sign: tb
Last rev:	11.02.09	Sign: tb
Doc. No:	K4-10/40E	Sign: tb
Page 3 of 3		

Additional products BSF, BCC

6. Magnet box to the Column unit for BCC

It is made of elastomer with a hardness of 60 shore
Can be delivered with or without the magnet.

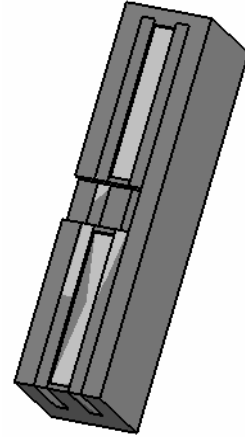

Magnet box BCC 250

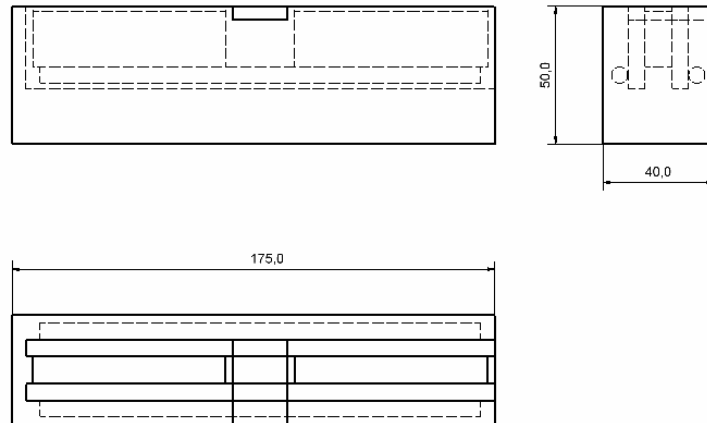

Magnet box BCC 450

