

## INDICE

1. PLANIMETRIE.....	2
1.1. Ground floor.....	2
2. EMETTORI.....	3

# Relazioni

## 1. PLANIMETRIE

### 1.1. Ground floor

Tipo di locale	Altezza del piano di lavoro (m)	Locale	Potenza ricevuta (dB)							
			2400.0 MHz		2483.5 MHz		5150.0 MHz		5725.0 MHz	
			Min.	Max.	Min.	Max.	Min.	Max.	Min.	Max.
BEDROOM	0.8	Bedroom 1	-53.8	-35.8	-54.1	-36.1	-59.3	-40.2	-60.2	-41.2
		Bedroom 2	-45.1	-35.6	-45.4	-35.9	-49.2	-40.1	-50.1	-41.0
		Bedroom 3	-53.3	-33.5	-53.6	-33.8	-57.9	-38.0	-58.8	-38.9
LIVING ROOM	0.8	Living room	-36.6	-6.8	-36.9	-7.1	-40.2	-10.4	-41.1	-11.3
KITCHEN	0.8	Kitchen	-45.1	-32.0	-45.3	-32.3	-49.4	-36.1	-50.3	-37.0
CORRIDOR	0.8	Corridor	-35.7	-16.0	-36.0	-16.3	-39.5	-19.9	-40.5	-20.8
TOILET	0.8	Toilet 1	-47.2	-41.7	-47.5	-42.0	-51.6	-46.4	-52.5	-47.3
		Toilet 2	-43.0	-37.8	-43.3	-38.1	-47.1	-41.9	-48.0	-42.8

# Relazioni

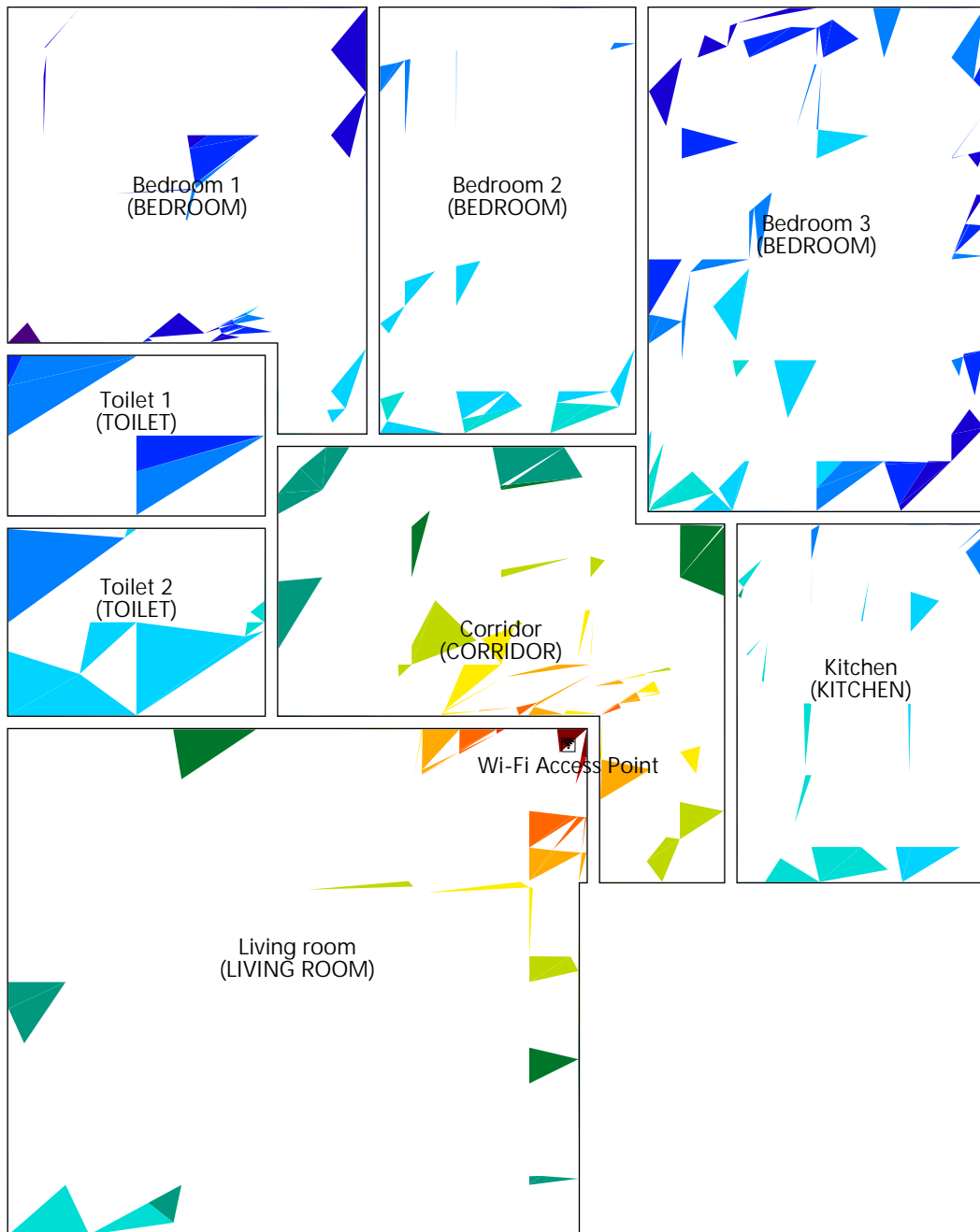

-53.8 dBm   -48.6 dBm   -43.3 dBm   -38.1 dBm   -32.9 dBm   -27.7 dBm   -22.5 dBm   -17.2 dBm   -12 dBm   -6.8 dBm

## 2. EMETTITORI

Riferimento	Ubicazione			Potenza (dBm)			
	Planimetria	Locale	Altezza (m)	2400.0 MHz	2483.5 MHz	5150.0 MHz	5725.0 MHz
Wi-Fi Access Point	Ground floor	Living room	0.8	20.0	20.0	23.0	23.0